

Nordhavn 57 Diversion



JEFF MERRILL
YACHT SALES, INC.

3010 Old Ranch Pkwy, Suite 440, Seal Beach, CA 90740
+1 949.355.4950 | www.JMYS.com



DIVERSION

Major price reduction in July 2018

Asking: \$795,000.00 Location: Port St. Lucie, FL

Nordhavn 57 Diversion

BRAND / MODEL: NORDHAVN 57
TYPE: Long range passage maker with raised pilothouse and flybridge
MODEL YEAR: 2000
HULL NUMBER: 11
HULL COLOR: Gray gelcoat
REGISTRY: United States Coast Guard documented
DESIGNER: Jeff Leishman
BUILDER: P.A.E./Ta Shing – Tainan, Taiwan
HULL MATERIAL: Solid Fiberglass
DISPLACEMENT: 122,000 lbs. / 55.34 MT
BALLAST: 3,300 lbs. / 1.5 MT
RANGE: 3,000 miles @ 8.0 knots
SPEED: Cruise 8.5 knots, Top 10.5 knots
LOA: 60'7" / 18.46 M
LWL: 53'3" / 16.23 M
BEAM: 17'7" / 5.36 M
DRAFT: 6'2" / 1.9 M
D/L: 320
Cp: Prismatic Coefficient .65
AIR DRAFT: 25'0" / 7.62 M top of antenna's
MAIN ENGINE: LUGGER L6125A / 325 HP (3,750 hours: July 2018)
EXHAUST: Dry stack, keel cooled
WING ENGINE: LUGGER L984D 70 HP (730 hours: July 2018)
THRUSTERS: ABT 25 HP hydraulic bow thruster
STABILIZATION: NAIAD Model 254 active fins
ELECTRICAL: 60 Hertz – US style
GENERATOR: Northern Lights 20 kW (7,015 hours: July 2018)
INVERTER: Trace 2.5 kW inverter
WATER MAKER: HRO (model 10/600) 600 gallons per day
CLIMATE: Cruisair Air conditioning - 80,000 BTU (with heat strips)
WINDLASS: Maxwell 3500 horizontal electric
CRANE: Aritex model HSC-610 1,300 pounds
TENDER: Caribe RIB 14'5" with Yamaha 50 HP outboard
NAV/COM: Extensive, primarily Furuno.
ENTERTAINMENT: Television in saloon, master stateroom and VIP stateroom
STATEROOMS: (3) Master aft, Guest cabin to port, VIP forward
HEADS: (2) Headhunter electric freshwater
SHOWERS: (2) Master ensuite and shared for forward two cabins
LAUNDRY: Asko clothes washer and dryer
GALLEY COOKING: Electric GE four burner stove and oven
INTERIOR WOOD: Teak, semi-gloss finish
INTERIOR STONE: Corian counters

Nordhavn 57 Diversion

FLOORING:	Teak and spruce, carpeting
TANKAGE: (approx.)	
FUEL:	2,000 gallons / 7,571 L (fiberglass)
HOLDING BLACK:	120 gallons / 454 L
FRESH WATER:	300 gallons / 1,136 L
Note: All information is believed accurate, but should be verified.	

INTRODUCTION

Diversion is offered for sale by her second owners who have enjoyed her during the past fourteen years cruising around Florida and the Bahamas. The sellers are a husband and wife team who are owner/operators and exceptional yacht handlers. *Diversion* is a classic Nordhavn 57 with the popular wide body salon, three stateroom layout and a gorgeous teak interior. She has been thoughtfully maintained and regularly exercised throughout her ownership. Diligent maintenance in systems and equipment on top of the original build selections make *Diversion* an outstanding purchase for anyone looking to own a stellar Nordhavn 57. (Her owner is a licensed yacht broker and experienced marine surveyor, so he knows how to keep things nice and running smoothly).

ACCOMMODATIONS AND LAYOUT

From the cockpit, you enter the salon with L-shaped built-in settee to port with custom high/low teak table. There are two chairs to starboard divided by a locker stand. Moving forward and to port is the large U-shaped galley with Corian countertops. There is engine room access down stairs to starboard. Moving forward up several steps you find the large pilothouse with helm chair, L-shaped seating with table, electrical distribution panels, sliding pilothouse doors that access the outside decks and a separate set of stairs aft that leads up to the fly bridge. Continuing forward to starboard from the pilothouse, you descend a set of curved stairs leading to three separate cabins along with two separate heads and showers.

HIGHLIGHTED FEATURES

- Bulbous bow
- Lugger single main engine with dry stack exhaust
- Lugger wing engine
- Asymmetric “wide body” salon
- Three stateroom layout
- Cruisair air conditioning
- Raised pilothouse
- Semi-gloss teak wood interior
- Corian countertops in galley and heads
- Flybridge with Bimini top
- Naiad active fin stabilizers
- ABT hydraulic bow thruster
- HRO water maker
- Aritex crane
- Caribe tender

Nordhavn 57 Diversion

INTERIOR – GENERAL

Diversion is beautifully appointed with leather upholstery and a gorgeous teak wood finish. Corian countertops, carpeted floors and chrome / stainless fixtures are used throughout, with Ta Shing's legendary joinery work a masterpiece to behold.

- Semi-gloss teak woodwork
- Corian counter tops in galley and heads
- Cantalupi interior lights
- Grohe plumbing fixtures
- New vinyl ceiling panels throughout

MAIN SALON

Entering the salon, you are immediately met by a spacious and inviting interior. The salon enjoys extra space due to the wide body configuration. To starboard there are two chairs separated by a stand locker with another cabinet aft which houses a television. To port is a large L-shaped built in seating area surrounding a large custom ordered "Hi-Lo" teak table. The saloon has blue leather upholstery on the settee. The carpeting and drapes provide a warm, home style feeling.

The interior of *Diversion* is all rich teak wood which has been beautifully matched.

- Custom high low table with folding leaves and compass rose inlay
- L shaped settee with blue leather upholstery
- 19" Sony television in cabinet aft to starboard
- Stereo locker
- Teak overhead hand rails
- Bose lifestyle 25 entertainment system with Bose speakers
- Custom designer Roman blinds
- Custom Italian carpeting
- Overhead valance
- (2) bar stool seats facing the galley

The laundry appliances are concealed in a locker that houses the separate Asko clothes washer and dryer forward starboard in saloon

- Asko clothes front loading clothes washer
- Asko clothes front loading clothes dryer

GALLEY

This galley features two sinks (large and small) with disposal, a four-burner electric cook top with sea rails and pot holders, and a full sized electric oven, dishwasher, a trash compactor and Sub Zero refrigerator with freezer drawers and icemaker. There is a door to the outside port deck which provides great air flow and easy access. You can also open the starboard side door (top landing for the engine room) to get cross flow air circulation. The Corian counter offers an expansive serving surface. There are numerous cabinets and drawers for all galley necessities.

- Subzero Refrigerator /Freezer, model 611 F with ice maker
- GE Profile Microwave/convection oven
- GE Profile 4 burner electric cook top with stainless fiddles and pot holders
- GE Profile oven

Jeff Merrill Yacht Sales, Inc. © 2018 All Rights Reserved www.JMYS.com

Nordhavn 57 Diversion

- Double stainless-steel sink
- ¾ HP Insinkerator garbage disposal
- Frigidaire Dishwasher
- Broan trash compactor
- Overhead storage cabinets
- Drawers and lockers
- Corian counter tops and back splash
- Custom tile galley floor

PILOT HOUSE (including electronics and entertainment)

Heading forward from the salon you ascend five steps to the pilothouse. This is the command center underway and it has been laid out for optimum comfort underway. The instruments are mounted in the forward dash and overhead. There is a large blue leather Stidd helm to run the show. Aft there is a built-in settee with teak table which is ideal for lunch or morning coffee. Teak and spruce soles with area carpets.

- Stidd Admiral helm chair with blue leather upholstery
- Stainless steel destroyer wheel
- Sliding doors to port and starboard allow you to enjoy natural cross ventilation at anchor or while underway
- Gloss varnished teak table
- Overhead hatch
- Cushioned blue leather bench seat
- Chart light
- Four upgraded Vetus parallel sweep windshield wipers
- Custom Oriental rugs
- Furuno Model # 7112, 12kW radar with 6' open array
- Furuno Model # 1761 MK2, 4kW radar with 4' open array
- Nobeltec east coast and explorer Bahamas charts
- Standard Horizon matrix GX2200 – AIS/GPS VHF Radio
- Interphase Twinscope
- Furuno GPS – GP31 receiver
- B & G Network digital depth sounder
- (2) Independent Simrad Robertson AP 20 autopilots
- Garmin GSmap 740s GPS plotter
- Hewlett Packard tower computer
- Fusion MS-CD500 stereo receiver, with Sirius, DVD and IPOD
- KVH 4 satellite television system – Direct TV
- GE C-Phone intercom – pilothouse, galley and staterooms
- Ritchie 6" compass in pilothouse
- Weems and Plath clock
- Weems and Plath barometer
- Oregon wireless weather station
- Elbex EXM-93 closed circuit TV system –two cameras, black and white
- (2) Hella fans
- (2) Fusion 7" overhead speakers

Jeff Merrill Yacht Sales, Inc. © 2018 All Rights Reserved www.JMYS.com

Nordhavn 57 Diversion

- (2) 1000 watt internally mounted stereo amplifiers with cooling fan
- “Badboy” WIFI expander with “unleashed” 600 watts local WIFI Xmtr.
- Jabsco spotlight control
- Remote windlass control in pilot house and flybridge
- Stabilizer Control: Naiad 254 stabilizer control
- ABT Bow Thruster control
- Stairs to fly bridge with glass and stainless steel sliding door
- Engine instruments for the main engine
- Engine instruments for the wing engine
- Envision monitor
- 12VDC service panel with breakers
- 120VAC/240VAC panel with breakers
- Tank Watch
- Fireboy
- FloScan
- Epson XP410 printer

MASTER STATEROOM

Working down nine steps from the pilothouse stairs you arrive at the lower living areas. The master stateroom is located aft with a large, island queen sized bed positioned fore and aft. A nice dresser, large hanging lockers, abundant drawers, bed stands and great lighting with excellent ventilation through two port lights compliment this wonderful room. There is a nice selection of teak trim to complement the balance of white laminate making the room feel more spacious.

- Queen size berth with custom fitted mattress
- Large dresser
- Vanity
- Teak framed mirrors in stateroom and head
- Large sliding door hanging locker
- Laundry locker – tilt out hamper
- 2 oval portlights
- Carpeted floors
- Storage cabinets and drawer storage
- Book shelf above bed
- Hella fan
- RCA television on port bureau top
- Panasonic stereo

MASTER HEAD

This is a convenient and private head with shower and sink and includes a mirrored medicine cabinet and lockers.

- Corian counter tops
- Shower: Molded fiberglass, with seat, electric drain & metal framed glass door
- Grohe fixtures in sink and shower
- Cabinets and drawers

Nordhavn 57 Diversion

- Mirrored medicine cabinet
- Headhunter full size electric fresh water head
- Shower exhaust blower with timer
- (1) port light behind sink and (1) in shower
- Vinyl flooring

GUEST HEAD Starboard

This head is located just forward of the stairway landing. There are two entrances, one from the hallway and one from the stateroom so privacy is afforded from either access. This head also features a roomy shower with metal framed glass shower door.

- Shower: molded fiberglass with seat, electric drain and metal framed glass door
- Mirrored medicine cabinet
- Headhunter electric full size fresh water head
- Electric shower drain
- Grohe fixtures in sink and shower
- Shower exhaust blower with timer
- Port light in shower
- Corian countertop
- Split hinged door into forward stateroom
- Vinyl flooring

GUEST STATEROOM Port

Across from the forward head is a comfortable guest stateroom to port. The port guest stateroom features two large single bunk beds. There are drawers and overhead lockers for storage as well as a teak bed stand with mirror.

- Large hanging closet
- Overhead storage cabinets
- Teak framed mirror
- White wood paneling on hull sides
- (1) Hella fan
- Reading light
- Drawers and cabinets for storage
- (1) Port light
- Carpeted flooring

VIP GUEST STATEROOM Forward

At the forward end of the hallway you go up a step to the forward VIP guest stateroom. This stateroom has a wide double island berth on centerline with a lifting mechanism to access machinery below. There is a large clothing hanging closet with abundant additional cabinets. Nice teak finish with some white painted trim.

- Wide double island berth centerline forward
- Custom fitted mattress
- Large hanging locker forward
- One port light starboard
- Opening overhead hatch
- Extensive storage under berth

Nordhavn 57 Diversion

- Private entrance to guest head
- Small television with DVD player
- Carpeted floors

ENGINE ROOM

The engine room on the Nordhavn 57 is a “stand up” engine room that is easy to get around thanks to the maintenance strakes incorporated into the hull design. This is a well-lit area that also has various places to safely sit down. The main engine is on centerline and protected by a stainless-steel handrail. The generator is aft to port and the wing engine is aft to starboard. On the port side opposite the main engine is a work bench with tool drawers. A built-in sea chest delivers sea water to the various engines and pumps that require cooling. This is an engine room that is easy to manage while underway.

- Luger model no. L6125A / 325 HP Main engine keel cooled with dry stack exhaust
- Twin disc transmission
- Secondary Racor fuel filters
- Bearings: One rubber cutlass type at aft end of stern tube, one pillow block bearing in front of stuffing box.
- Shaft seal: bronze stuffing box type
- 4 blade bronze propeller
- Spurs line cutter on main shaft
- Engine controls: Hynautic (3) stations (pilot house, flybridge & cockpit)
- Engine room Blowers: (2) 110V Dayton 4C831 1,200 CFM (one intake, one exhaust)
- Luger model no. L984D 70 HP "Wing Engine" -Wing engine controls are Morse cable. Includes a Martec 2 bladed folding 22" diameter x 20" pitch propeller. This drives an independent shaft and propeller.
- Northern Lights 20kW Generator
- Naiad model 254 active fin stabilizers
- Emergency 180gpm hydraulic pump
- Aritex crane motor
- HRO water maker
- Trace inverter
- Stabilizer hydraulic reservoir
- Escape hatch to saloon
- Fresh water sink
- Fireboy fire suppression with engine shutdown and manual pull release
- 2,000 gallons fuel in four fiberglass tanks
- Fuel manifolds are all stainless steel with transfer, supply and return manifolds serving all fuel tanks
- Fuel transfer system with stainless steel manifold includes separate pick up and return lines. Walbro pump. Filter fuel through transfer Racor
- Oberdorfer pump for oil change system - main, wing and generator
- Electric and manual bilge pumps
- Convenient freshwater sink
- NuTone central vacuum system
- Vinyl flooring
- Tool chest forward (chest stays, tools will be removed at closing)

Nordhavn 57 Diversion

ELECTRICAL SYSTEMS

Diversion was built to cruise in US home waters and is outfitted with power cruising electrical systems designed for both adaptability and simplicity

- 120/240-volt 60 cycle system with two 50-amp shore cord inlets. GFCI outlets in head compartment, galley, exterior and engine room. Water proof covers on outdoor outlets.
- Northern lights 20kW generator sound shield providing 120/240V current at 60 Hz
- Gen-Sep gas/water separator system for generator
- Trace 2,500-watt sine wave inverter/chargers.
- Isolation transformer on primary shore power system
- Bow shore power inlet
- 50-amp shore power cords
- Seven Deka AGM 8-D batteries for house bank. New June 2012
- Two West Marine Group 31 separate engine starting batteries. New October 2015
- Individual battery isolation switches
- Main AC and DC distribution and control panels
- Sub DC distribution and control panel in pilot house

PLUMBING SYSTEMS

The Nordhavn 57 includes several very well thought out plumbing systems.

- Fresh water filtering system
- Garbage disposal
- Grohe plumbing fixtures
- 20-gallon 220-volt Raritan hot water heater
- 600 GPD HRO water maker with remote in pilothouse
- Asko clothes washer
- Extra freshwater taps for engine room and foredeck
- Hot and cold-water cockpit shower
- Mach 5, 110-volt fresh water pump
- Cockpit freshwater sink
- Toilets: (2) Headhunter full size electric freshwater
- Electric and manual overboard pump for black water tank

EXTERIOR - GENERAL

- Starboard side deck boarding door
- Transom boarding door
- Portuguese bridge doors – port and starboard
- Numerous extra stainless exterior handrails
- Switlik 6-person canister life mounted on boat deck (due for service)
- Teak flagpole with U.S. ensign
- 120VAC flood light on the cross section between the stacks to light up the boat deck
- Fenders and dock lines
- Flag halyards
- Shore power alcove forward

Nordhavn 57 Diversion

COCKPIT

The Nordhavn 57 has an excellent cockpit, great for entertaining and helpful for docking. The cockpit area also boasts a built-in sink and hot/cold fresh water shower. The aft surrounding cap rail is varnished teak.

- Two fishing rod holders
- Locker console with stainless steel sink
- Two teak chairs with soft cushions
- Cockpit console thruster levers, rudder control lever and engine controls
- Stainless swim ladder on platform
- Teak flagpole with US Ensign
- Ladder to boat deck with fiberglass steps
- Swim platform has two U rails
- L shaped handrails for swim platform
- Dinghy cleats on transom

LAZARETTE

Directly below the cockpit is the lazarette which can be entered to through the cockpit hatch or the aft engine room door. The batteries are housed here. You will also find the steering system (including an emergency tiller). *Diversion* was also outfitted with a 5cu. ft. subzero freezer for extra cold storage.

- Freezer
- Batteries and switch panel
- Steering helm pump
- Air-conditioning system - Cruisair remote compressor system with SMX controls. Four compressors delivering 80,000 BTUs through four air handlers with SMX controls. Reverse cycle with optional heat strips.

BOAT DECK

The deck above the salon is the tender storage area and features a davit and dinghy with lots of room and space once the tender is launched. You can walk right up to the flybridge from this area.

- 14'5" Caribe inflatable tender with center console, fiberglass bottom and running lights. Garmin display and compass.
- Custom stainless tie downs (3) for tender
- 50 HP Yamaha 4-stroke outboard
- Covers for dinghy, fly bridge cushions, fly bridge table, life raft and pilothouse windows
- 1,300 lb. Stainless steel Aritex Model HSC-610 crane with 300-degree power rotation with 15' lead cord. Installed to port.
- Removeable stainless rail on port side for dinghy launch and retrieval

Nordhavn 57 Diversion

FLYBRIDGE

The flybridge of the Nordhavn 57 is a wonderful area to operate *Diversion* and to relax both underway and when at rest. There one helm chair and a settee area behind. You can access the flybridge from the pilothouse or the boat deck. Stainless sliding door with clear view between pilothouse and flybridge. The pilothouse roof forward has the search light and horn installed. *Diversion* has a stainless framed Bimini top and a comprehensive nav/com electronics package for easy navigation.

- Fixed stainless steel framed flybridge Bimini “T” top with Sunbrella cover
- Centerline helm chair
- Stainless steel destroyer helm
- L-shaped seating with cushions (no table, makes for more room)
- B & G Network digital depth sounder
- (2) Simrad Robertson AP22 autopilot controls
- Icom MC 304 VHF
- Garmin GSmap 740s GPS plotter
- Fusion stereo control with (4) 7” speakers & (1) 10” bass
- Ritchie compass
- Engine controls
- Thruster control
- Windlass control
- GFCI outlets - covered
- Stainless radar arch above stacks
- Dry stack exhaust through starboard stack
- Search light
- Horns

FOREDECK

You can reach the foredeck from the Portuguese bridge via a hinged door. The electric horizontal windlass is secure, feeding chain to the enclosed locker below and rests in an anchor well that drains overboard. There is a shore power box.

- Maxwell VWC 3500 horizontal primary windlass with foot buttons on deck and controls on flybridge and in pilothouse
- 125 lb. stainless steel anchor with 400’ of 7/16” high test chain
- Recessed anchor well
- Fresh water hose bib
- Sea water hose bib
- Burgee staff
- Shore power inlet connections – for house and air conditioning TV cable
- Lewmar hatch
- Built in dock storage box
- Two Dorade vents

Nordhavn 57 Diversion

MISCELLANEOUS FEATURES AND EQUIPMENT

- Switlik 6-person life raft (due for service)
- EPIRB
- Fire extinguishers
- Emergency signal flares
- Life jackets
- Life Sling in canister
- Custom owner's manual (first one ever done by PAE)
- All Coast Guard required equipment
- Spare parts

DIVERSION - UPGRADES DURING OWNERSHIP

- Boat waxed (2016)
- New Bottom paint, new zincs (2014)
- New Membranes for water maker (2013)
- Water maker full maintenance-(2014)
- Change all fuel and oil filters and oil for main, wing and generator (2016)
- Generator maintenance (2016)
- Replaced all belts and water pumps for main, wing, generator (2015)
- Extensive spare parts collection
- Varnish teak caprail in cockpit (2014)
- Aritex crane pump rebuilt (2014)
- Spare pump for freshwater system
- Deck repainted (2010)
- Canvas covers for exterior (2015)
- Main engine stuffing box packing redone (2015)

ADDITIONAL COMMENTS:

Diversion is a USCG documented and registered vessel with US duty paid. The hull and topsides have been cleaned and waxed on a regular basis. If you are in the market for an outstanding long-range passage maker at an exceptional price, please give *Diversion* a very close look. Additional *Diversion* photos are available by request.

Nordhavn 57 Diversion

LAYOUT:

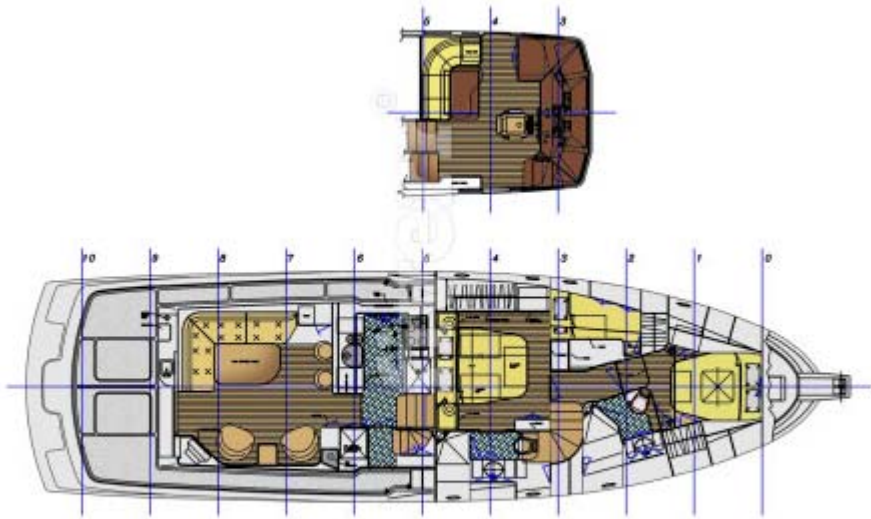

EXCLUSIONS:

Potential purchasers should assume that items on the vessel at the time of viewing, but not specifically listed on this sheet, are not included with the sale of the yacht. These specifications are believed to be true and correct, but cannot be guaranteed. Items excluded include, but are not limited to – Paintings, Tools and Binoculars. Owner's personal effects and clothing will be removed prior to closing.

DISCLAIMER:

Specifications and details of this vessel are provided in good faith for informational purposes only. Details regarding the specifications, operating characteristics and condition of the vessel have been obtained from sources believed reliable, but the owner and brokers cannot guarantee or warrant the accuracy of this information or the condition of the vessel. Buyer assumes responsibility to verify all speeds, capacities, consumptions and other measurements contained herein and otherwise provided and agrees to instruct his/her agent or surveyor to confirm such details prior to purchase. Vessel is offered subject to prior sale, price and inventory changes and withdrawal from market without notice.

Nordhavn 57 Diversion

SALES CONTACT DETAILS:

Jeff Merrill, CPYB (Certified Professional Yacht Broker) and **John Hoffman**, have extensive product knowledge of the trawler market and intimate knowledge of the Nordhavn 57 in general and *Diversion* specifically. Please contact listing broker **Jeff Merrill, CPYB** or listing agent **John Hoffman** for additional information or to schedule a viewing appointment to inspect *Diversion*.

John Hoffman

Mobile phone: +1 772.215.3720 - call or text

Email: John.Hoffman@JMYS.com

~or~

Jeff Merrill, CPYB

Mobile phone: +1 949.355.4950 – call or text

Toll Free: 866.748.5419

Email: Jeff.Merrill@JMYS.com

Skype: jeff.merrill

You Tube: Jeff Merrill Yachts

Website: www.JMYS.com

Instagram: jeffmerrilljmys

Twitter: @merrillyachts

LinkedIn: jeff.merrill

Facebook: Jeff Merrill Yacht Sales

Certified Professional Yacht Broker - CPYB

Licensed and Bonded in California and Florida.

Member California Yacht Brokers Association – President 2015 and 2016

Member International Yacht Brokers Association

Member Northwest Yacht Brokers Association

Member Yacht Brokers Association of America



Jeff Merrill Yacht Sales, Inc. © 2018 All Rights Reserved www.JMYS.com