

Kadey Krogen 39 *Lady Di*



JEFF MERRILL
YACHT SALES, INC.

3010 Old Ranch Pkwy, Suite 440, Seal Beach, CA 90740
+1 949.355.4950 | www.JMYS.com



LADY DI

Asking: \$299,000.00

Location: Vallejo, CA

Lady Di is a no-nonsense, simple and elegant Kadey-Krogen 39. She is hull number one, a 1998 model year making her the first in the series followed by fifty sister ships before rising costs forced this popular design to cease production. Economical, efficient and practical, the KK39 is particularly appealing for first time trawler owners or a couple contemplating a 50' or smaller sailboat, but who are unwilling to give up the comforts of home that fit into this well-defined package. This is a boat that has been designed to be the best possible platform for two people and there are no compromises in build quality, she is the equal in fit and finish of her larger siblings crafted in Taiwan by Asia Harbor Yacht Builders.

Kadey Krogen 39 *Lady Di*

Lady Di was originally named “Number One” she was introduced as the cover story and feature article with photos in the Winter 1998/1999 *PassageMaker* magazine that heralded her arrival. Bill Parlatore who wrote that story had an interesting observation, “The Krogen 39 is a trawler designed for KISS passage making. Keep things simple. If you can resist becoming best friends with your local marine store when you outfit the boat, and instead go slowly during the outfitting process, you will be one happy couple with an exceedingly happy boat.”

A true full displacement, long range trawler, she is ideal for a cruising couple. **Lady Di** has travelled the US west coast from Mexico to Alaska and now rests at her dock on the San Francisco Bay.

Several Krogen 39's have gone on extensive passages, with standard fuel topped off and running at 6 knots she has a realistic range of over 4,000 miles!

Her looks are timeless, inside and out. She has been maintained in beautiful condition by her current (second) owners who always send in oil samples after each change to make sure her John Deere main engine is healthy. Very few production trawlers can boast a reputation of being an easy vessel for a couple to manage and look after by themselves, the Krogen 39 fits this description.

Boarding aft (from the swim step or dock) you enter the cockpit which is covered overhead and includes teak decking underfoot. There are side decks port and starboard that lead up to the foredeck. On top, the flybridge has a folding canvas Bimini top with outboard seating on each side. The boat deck is aft with the dinghy mounted fore/aft and the mast and boom provides antenna mounting and serves as the dinghy launching davit. You access the boat deck / flybridge from a ladder in the cockpit.

Entering through the saloon door you will appreciate the fantastic visibility to the outside through teak framed opening windows and will be greeted by a warm teak interior. There are built in settees port and starboard with comfortable Ultrasuede upholstery and a teak parquet floor. The galley is forward to starboard lined with white Corian counters and white laminate verticals to keep it light and easier to clean. There is an opening portlight outboard to provide both a view and ventilation.

The engine room is under the saloon and has stand up 6' plus headroom as you enter and plenty of access to move around once inside. There is a work table area with room for storage of oil, filters, tools, etc. Neat installations of machinery and hose runs are evident.

Moving forward and up some steps to the pilothouse you pass an outboard locker with a louvered door that conceals the combo clothes washer/dryer. The pilothouse has an impressive view making operations underway very easy to manage and includes doors to the outside decks port and starboard. There is a wide and comfortable settee with a table aft and the forward nav/com dash has a large teak steering wheel on centerline. The flooring is teak and holly and the rich teak joinery in the pilothouse is complemented by white surfaces and white overhead with an opening hatch.

Inside and down some curved steps from the saloon deck is the head and shower to starboard. The full beam master with island queen sized walk around bed is surrounded by teak lockers and doors. Varnished teak ceilings outboard combine with white laminate to make this room feel spacious and an overhead hatch plus outboard opening portlights provide ventilation.

Kadey Krogen 39 Lady Di

Lady Di is ready to go cruising and priced to move quickly. One last observation from Bill Parlatore in his *PassageMaker* article when she was new, "You really can't get much smaller and still have a vessel with the range and capacity for heading across an ocean in comfort." Please contact the listing broker for a visit as all showings are by appointment only.

SPECIFICATIONS:

YACHT NAME:	LADY DI
BRAND AND MODEL:	KADEY-KROGEN 39 (Flybridge)
TYPE:	Long range passage maker with raised pilothouse
LOCATION:	Napa, CA
MODEL YEAR:	1998
HULL NUMBER:	1
HULL COLOR:	White gel coat
REGISTRY:	United States Coast Guard documented
DESIGNER:	James Morrow Krogen
BUILDER:	Asia Harbor Yacht Builders – Kaohsiung, Taiwan ROC
HULL MATERIAL:	Fiberglass
DISPLACEMENT:	33,470 lbs. 15.18 MT
BALLAST:	2,000 lbs. .9 MT
RANGE:	3,000 miles @ 6 knots
SPEED:	Cruise 6, Top 8.5 knots
LOA:	43'8" 13.31 M
LWL:	36'8" 11.17 M
LOD:	38'11" 11.86 M
BEAM:	14'9" 4.49 M
DRAFT:	4'3" 1.29 M
D/L:	303
A/B:	2.6
Cp:	Prismatic Coefficient .60
AIR DRAFT:	22' 6.7 M mast 31' 9.45 M antenna (est.)
MAIN ENGINE:	John Deere 4045TFM 115 HP (Main hours: ~4,700) May, 2017
TRANSMISSION:	Twin Disc 2.39:1 reduction
PROPELLER AND SHAFT	24" three blade propeller 1.75" Aquamet 22 shaft
EXHAUST:	Wet exhaust
THRUSTER:	Lewmar 185TT, 12V/ 6kW Bow thruster
ELECTRICAL:	60 Hertz – US style - 50-amp service for house
INVERTER/CHARGER:	Freedom 20 inverter / charger with Link 2000 remote
BATTERIES:	(8) 6V Golf cart house batteries 8D engine start battery - All Trojan flooded
CLIMATE CONTROL:	Espar Airtronic diesel forced air furnace (saloon and stateroom)
WINDLASS:	Lewmar 12V electric
GROUND TACKLE:	SuperMax 64lb. 250' 3/8" chain. Secondary Bruce 66 lb. with chain/rode
MAST & BOOM:	Painted aluminum spars with electric boom winches for dinghy

Kadey Krogen 39 Lady Di

TENDER AND OUTBOARD:	West Marine 9' with Honda 2 HP four stroke outboard
NAV/COM:	Raymarine Icom Simrad
ENTERTAINMENT:	24" TV/DVD in saloon
STATEROOM:	(1) Master forward
HEAD:	(1) Vacuflush (electric freshwater)
SHOWER:	(1) Master
LAUNDRY:	Splendide 7100XC clothes washer/dryer Force 10 Propane three burner stove and oven Tundra refrigerator/freezer
GALLEY:	Microwave
INTERIOR WOOD:	Teak and white laminate
INTERIOR COUNTERS:	Corian counters
INTERIOR UPHOLSTERY:	Ultrasuede
INTERIOR FLOORING:	Teak and holly parquet carpet
TANKAGE: (approx.)	
FUEL:	700 gallons 2,649.8 L (2 aluminum tanks)
HOLDING BLACK:	35 gallons 132.5 L (1 plastic tank)
FRESH WATER:	300 gallons 1,135.6 L (3 stainless steel tanks)
SAFETY:	Liferaft EPIRB

All information is believed accurate but should be verified. © 2017 JMYS

LAYOUT: Pilothouse

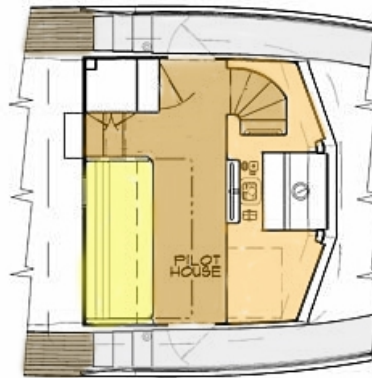

Kadey Krogen 39 Lady Di

LAYOUT: Main Deck – Saloon, Galley, Stateroom



LAYOUT: Flybridge

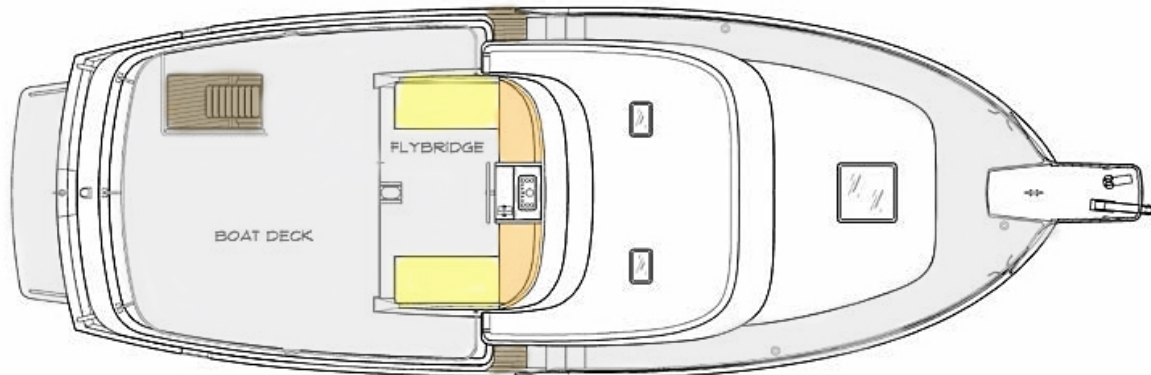

Exclusions: Potential purchasers should assume that items on the vessel at the time of viewing, but not specifically listed on this sheet, are not included with the sale of the yacht. These specifications are believed to be true and correct but cannot be guaranteed. Items excluded include, but are not limited to Paintings, tools, handheld nav gear and binoculars. Owner's personal effects and clothing will be removed prior to closing.

Disclaimer: Jeff Merrill Yacht Sales, Inc. presents the details of this vessel in good faith but cannot guarantee or warrant the accuracy of this information nor guarantee or warrant the condition of the vessel. Buyers should instruct their agents and their surveyors to investigate all details the buyers desire validated. This vessel is offered subject to prior sale, price change, or withdrawal without notice.

Brokerage: JMYS is a US based (licensed and bonded yacht brokerage in California and Florida) with an international emphasis specializing in ocean capable trawlers. Our brokers are experienced boaters, most are trawler owner/operators with thousands of hours and miles at sea. We treat our clients with respect, we are responsive and not pushy. Our focus is to become your loyal advocate, always looking

Kadey Krogen 39 Lady Di

out for your best interests. The team at JMYS has extensive trawler and motor yacht product knowledge and our skills are available for coaching after the sale has concluded.

Co-Brokerage: Fellow yacht broker association members: This listing is available for co-brokerage and JMYS is a 50/50 house. Courtesy showings are available by appointment. Florida listings subject to appropriate broker licensing required by law.

***Listing broker. Jeff Merrill, CPYB** (Certified Professional Yacht Broker) has extensive product knowledge of the trawler market and the Kadey Krogen brand. All inspections are by appointment only. Please contact listing broker, **Jeff Merrill, CPYB** by phone, text or email for additional information or to schedule your personal showing. Jeff is always available via Mobile (949) 355-4950 (call or text). You can send a detailed Email to: Jeff.Merrill@JMYS.com.



Jeff Merrill, CPYB

Mobile phone: +1 949.355.4950 – call or text

Email: Jeff.Merrill@JMYS.com

Skype: jeff.merrill

Twitter: @merrillyachts

You Tube: Jeff Merrill Yachts

LinkedIn: jeff.merrill

Website: www.JMYS.com

Facebook: Jeff Merrill Yacht Sales

Instagram: jeffmerrilljmys

Certified Professional Yacht Broker - CPYB

Licensed and Bonded in California and Florida

Member California Yacht Brokers Association – President 2015 and 2016

Member International Yacht Brokers Association

Member Northwest Yacht Brokers Association

Member Yacht Brokers Association of America

