

Willard 40 Aloha



JMYS

3010 Old Ranch Parkway, Suite 440, Seal Beach, CA 90740
+1 949.355.4950 | www.JMYS.com



Aloha

Asking: \$299,000.00

Location: San Pedro, CA

Willard 40 Aloha

Aloha is the last Willard 40 manufactured, the grand finale – a wonderful last ship built to wrap up an extraordinary history of building recreational trawlers (note: Willard Marine continues to build military vessels today). The seller was a very involved manager of the sales, marketing and production of the recreational product line and when it was time to order his own yacht, he was able to take advantage of 41 years of trawler building expertise at Willard. The current owner/seller was also one of the designers of **Aloha**.

Willards are very well known in the closed knit trawler community but did not have the marketing budget of other brands. You may not know that Willard Marine was the very first manufacturer of custom fiberglass recreational trawlers, years ahead of the better-known brands that you have heard of and read about in magazines. Willard is well remembered as one of the very few American Made trawlers. Continually based in Southern California, Willard Marine departed the recreational trawler market and has focused their efforts on US Navy and Coast Guard contracts instead.

Aloha is a very capable passage maker, fuel efficient, economical and an ideal cruising vessel for a couple or someone looking for a stout package in a moderate envelope. Her distinctive rounded stern and long keel give her exceptional performance in following seas. Her fine entry and natural hull curves allow her to glide through the seas, easily cleaving through big swells and moving along swimmingly. Her construction is the tried and true, hand laid, 100% fiberglass solid and robust hull. The hull structure is divided into three watertight compartments with separate bilge pumps. For an extra layer of safety, her bow is secured with a watertight collision bulkhead.

DESCRIPTION:

Profile: **Aloha** has a distinctive trawler look with a high bow and a rounded stern.

Cockpit and Lazarette: Boarding from the stern, you have a fold down transom door incorporated into the hull which provides a unique and practical boarding platform that closes off the transom when raised. You can enter the cockpit from the starboard side deck when at a dock. The cockpit is covered overhead and includes non-skid surface decking underfoot. There is a ladder to port for access up to the boat deck. A large opening hatch door gives you access to the lazarette chamber which houses the steering system and includes storage.

Side Decks: From the cockpit going forward there are non-skid surface side decks port and starboard (covered) that merge into fiberglass steps that lead up to the foredeck. Waist high bulwarks provide safe passage on both sides and are capped with teak cap rails. Port and starboard boarding gates are located at amidships.

Foredeck: The foredeck is surrounded by stainless steel rails for on-deck safety. Forward, a vertical electric windlass is mounted with the primary anchor and assorted ground tackle available and at the ready. The decking is non-skid. Three large storage containers are located in front of the pilothouse.

Willard 40 Aloha

Boat Deck: The boat deck is above the cockpit and salon. It is accessible via the ladder from the cockpit. The ladder has a fiberglass hatch covering to keep the cockpit dry and to make the deck safer when up top. Her tender/dinghy stainless steel storage support rails are mounted fore / aft. The painted aluminum spar arrangement provides radar mounting on the mast, and the boom has an electric winch which serves as the dinghy launching davit.

Saloon: Entering through the saloon door from the cockpit you will be greeted by a warm and spacious interior. There is a built-in settee to port with comfortable cloth upholstery. The dining table is mahogany. The starboard side has an arrangement of lockers and storage cabinets. There are windows for a view outdoors and the entire area is open and inviting. Going forward you enter the galley to port.

Galley: The galley has a large U-shaped countertop with a double basin sink and a cook top/heater installed. Outboard is a round opening portlight which provides ventilation and a view. The galley includes a convection oven and a 6.8 cubic foot AC/DC refrigerator. There are lockers and drawers for the galley necessities and plenty of counter space for meal preparation.

Pilothouse: The pilothouse has an impressive view making operations underway very easy to manage and includes sliding doors to the outside decks port and starboard. There is a wide and comfortable settee aft, and the forward nav/com dash has an appropriate concentration of navigation and communications electronics and features a stainless-steel destroyer steering wheel on centerline. The Nav/Com dash also features a large countertop that gives plenty of space for viewing charts. The port side of the pilot house features a comfortable single seating area. Overhead panels forward include additional communications gear, engine controls and there is an overhead hatch.

Forward Lower Landing and Guest Quarters: Taking the stairs to the lower level you reach a landing that allows you to go forward to the master stateroom, outboard to starboard to the head and shower, or port to the guest quarters. The guest quarters can be isolated for privacy by a movable partition or left open as a large open area. The guest section includes a comfortable sofa that converts into a spacious twin bed. This area can also be utilized as an office and there is a convenient desk with a large work area. Two large port-lights provide plenty of daylight. There is a lot of space in this area including cedar lined storage lockers, drawers and bookshelf. The sole is carpeted.

Master Stateroom: The full beam master with island queen sized walk around bed features a custom mattress and drawers underneath. The mattress is hinged so it can be lifted to access additional storage underneath. An overhead hatch plus outboard opening portlights provide ventilation and plenty of daylight. Both sides of the stateroom have large storage lockers with cedar lined bulkheads. The sole is carpeted.

Head and Shower: The head and shower include a sink basin and is surprisingly roomy and convenient for anybody aboard. The shower is large with a sitting area and a round opening portlight.

Engine Room: The engine room is under the saloon and it is accessible via a large hatch door in the saloon floor. **Aloha** is powered by a John Deere main engine, easily accessible from both sides. Neat installations of machinery and hose runs show the care in her construction and the foresight for easy servicing and maintenance. This is a very large engine room for a vessel this size.

Willard 40 Aloha

LAYOUT:

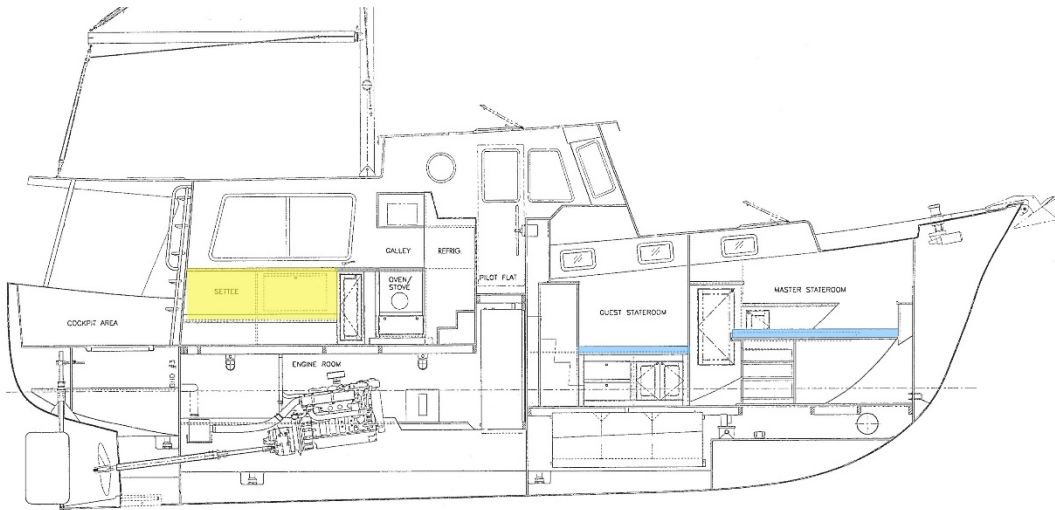
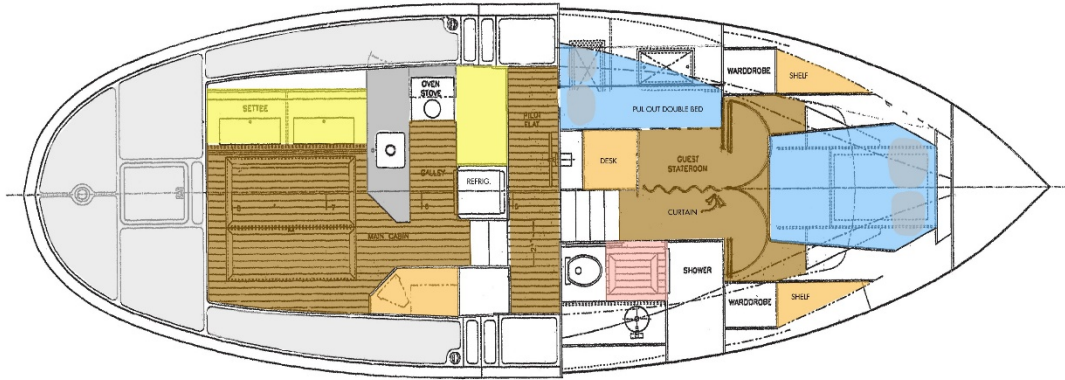

Willard 40 Aloha

SPECIFICATIONS:

YACHT NAME:	<i>Aloha</i>
BRAND AND MODEL:	Willard 40 Pilot House
TYPE:	Trawler
LOCATION:	San Pedro, CA
MODEL YEAR:	2002
HULL NUMBER:	40
HULL COLOR:	White gelcoat
REGISTRY:	United States Coast Guard documented
DESIGNER:	Willard Marine design team
BUILDER:	Willard Marine, Inc. - California, USA
HULL MATERIAL:	Solid Fiberglass
DISPLACEMENT:	34,000 lbs. 14,515 kg. (1/2 load)
BALLAST:	7,000 lbs. 3,175 kg.
RANGE:	2,800 miles at cruise speed of 6.0 knots
SPEED:	7.25 knots Max Speed 8.5 knots Fuel consumption 1.25 GPH@1750 RPM
LOA:	40'6" 12.34 M
LWL:	36'1" 10.97 M
BEAM:	13'8" 4.2 M
DRAFT:	4'3" 1.3 M
D/L:	314
A/B:	2.2
AIR DRAFT:	10'5" 3.20 M to top of pilothouse (est.)
DECK:	White deck non-skid surface
MAIN ENGINE:	John Deere 4045TFM50 120 HP (Main hours: ~651) April 2019
TRANSMISSION	Twin Disc
PROPELLER / SHAFT	1-3/4" stainless steel shaft Three blade bronze propeller - 28 x 18
EXHAUST:	Wet exhaust and freshwater keel cooled
THRUSTER:	Bow thruster - Vetus 160 (2) 4D batteries and charger - new 2014
STABILIZATION:	Hull reinforced for active fin stabilizer future install option
ELECTRICAL:	60 Hertz – US style
SHORE POWER:	50 AMPS Port and starboard connections
GENERATOR:	Apollo Diesel Generator 3.5 kW - (Generator hours: ~20) April 2019
INVERTER/CHARGER:	Xantrex ProSine 2.0 - 2,000 watts
BATTERIES:	House Bank - (6) 6V 223AH new 2015 Starting - (2) 12V - new 2015
INTERIOR LIGHTING:	12V Alpenglow in overhead
WATER MAKER:	Village Marine TEC. LVM-200GPD - reverse osmosis
CLIMATE CONTROL:	No Air conditioning - conduit from engine room in place for future install

Willard 40 Aloha

MACHINERY EQUIPMENT:	Navionics hydraulic steering
WINDLASS:	Muir electric
GROUND TACKLE:	Delta 45 lb. anchor with 100 ft. chain and 350 ft. 5/16 line Fortress FX23 secondary
MAST AND BOOM:	LeFiell painted aluminum mast and boom with Superwinch 12V electric winches for dinghy
TENDER AND OUTBOARD:	N/A (note: dinghy is included as a bonus, but is not registered and is available as-is)
NAV/COM BRANDS:	Raymarine RC80 Suite with Radar, GPS, Depth, Chart Plotter, Fish Finder and Autopilot with remote
ENTERTAINMENT:	Stereo/CD
STATEROOMS:	(2) Master forward, convertible guest cabin amidships
BEDDING:	Master - Custom HMC hinged queen mattress. Drawers and storage under bed
HEAD:	(1) Raritan Atlantis Selectable - Freshwater or Saltwater
SHOWER:	(1) Master and Guest shared
LAUNDRY:	Splendide 2100 Combination clothes washer/dryer
GALLEY:	Wallas diesel cooktop with internal space heater 6.8 cu. ft. refrigerator/freezer Sharp convection oven
INTERIOR COUNTERS:	Mahogany Dining Table
INTERIOR UPHOLSTERY:	Vinyl in pilothouse Cloth in saloon and staterooms
INTERIOR FLOORING:	Carpet and Lonseal loncoin vinyl
BILGE PUMPS:	(3) 12VDC automatic pumps in separate wells
TANKAGE: (approx.)	
FUEL:	(2) 350 gallons = 700 gallons 2271.2L (Aluminum)
HOLDING BLACK:	75 gallons 283.90 L (Fiberglass)
FRESH WATER:	300 gallons 1135.6 L (Stainless Steel)
ADDITIONAL EQUIPMENT:	Gulf Coast Filters fuel polishing and Racor large capacity filter
SAFETY:	US Coast Guard required equipment
PHOTO DATE:	Most detail photos were taken in April, 2019
	Note: All information is believed accurate but should be verified.

Willard 40 Aloha

For additional information please visit the Aloha website, www.willard40.com

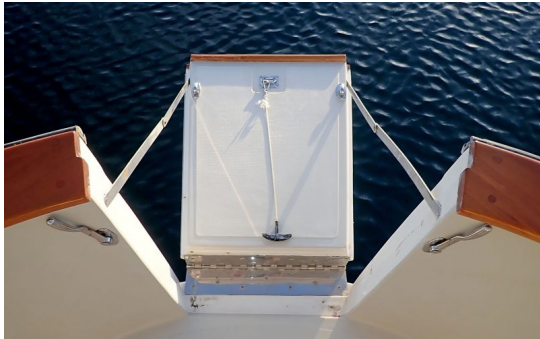

<https://www.youtube.com/watch?v=sRcofpMQR2o&t=111s>

Willard 40 Aloha

Exclusions: Potential purchasers should assume that items on the vessel at the time of viewing, but not specifically listed on this sheet, are not included with the sale of the yacht. These specifications are believed to be true and correct but cannot be guaranteed. Items excluded include, but are not limited to Paintings, tools, handheld nav gear and binoculars. Owner's personal effects and clothing will be removed prior to closing.

Disclaimer: Jeff Merrill Yacht Sales, Inc. presents the details of this vessel in good faith but cannot guarantee or warrant the accuracy of this information nor guarantee or warrant the condition of the vessel. Buyers should instruct their agents and their surveyors to investigate all details the buyers desire validated. This vessel is offered subject to prior sale, price change, or withdrawal without notice.

Brokerage: JMYS is a US based (licensed and bonded yacht brokerage in California, Florida and Washington) with an international emphasis specializing in ocean capable trawlers. Our brokers are experienced boaters, most are trawler owner/operators with thousands of hours and miles at sea. We treat our clients with respect, we are responsive and not pushy. Our focus is to become your loyal advocate, always looking out for your best interests. The team at JMYS has extensive trawler and motor yacht product knowledge and our skills are available for coaching after the sale has concluded.

Co-Brokerage: Fellow yacht broker association members: This listing is available for co-brokerage and JMYS is a 50/50 house. Courtesy showings are available by appointment. Florida listings subject to appropriate broker licensing required by law.

***Listing broker. Rob Piwowarczyk** All inspections are by appointment only. Please contact listing broker, **Rob Piwowarczyk** by phone, text or email for additional information or to schedule your personal showing. Rob is always available via Mobile +1 720.490.5662 (call or text). You can send a detailed Email to: Rob@JMYS.com.



Rob Piwowarczyk
Member California Yacht Brokers Association

Willard 40 Aloha

***Listing broker. Jeff Merrill, CPYB** (Certified Professional Yacht Broker) has extensive product knowledge of the trawler market. All inspections are by appointment only. Please contact listing broker, **Jeff Merrill, CPYB** by phone, text or email for additional information or to schedule your personal showing. Jeff is always available via Mobile +1 949.355.4950 (call or text). You can send a detailed Email to: Jeff@JMYS.com.



Jeff Merrill, CPYB

Skype: jeff.merrill | Twitter: @merrillyachts

YouTube: Jeff Merrill Yachts | LinkedIn: jeff.merrill | Facebook: Jeff Merrill Yacht Sales

Instagram: jeffmerrilljmys

Certified Professional Yacht Broker - CPYB

Licensed and Bonded in California and Florida

Member California Yacht Brokers Association – President 2015 and 2016

Member International Yacht Brokers Association

Member Northwest Yacht Brokers Association

Member Yacht Brokers Association of America

