

# Nordic Tug 26 Harpoon



# JMYS

3010 Old Ranch Parkway, Suite 440, Seal Beach, CA 90740  
+1 949.355.4950 | [www.JMYS.com](http://www.JMYS.com)



## *Harpoon*

**Asking: \$194,500.00**

**Location: Anacortes, WA**

Jeff Merrill Yacht Sales, Inc. © 2019 All Rights Reserved [www.JMYS.com](http://www.JMYS.com)

## Nordic Tug 26 Harpoon

Imagine the possibilities of cruising in a safe, rugged, and very well-equipped 2011 26' Nordic Tug – that's **Harpoon**! This trawler comes with a triple axel trailer and has been stored for most of its life on the trailer inside when it has not been in the water.

Step inside **Harpoon** and you will quickly realize why these trawlers are so popular. The layout has a lot to offer for a trailerable 26' boat! The cockpit has a full canvas enclosure complete with screens which allow this area to be an extra room on rainy or hot days! Once inside the salon and galley you'll see Amtico flooring and Sapele mahogany wood throughout – this combination really warms up the space inside. **Harpoon** is a single cabin, single engine, raised pilothouse style trawler, perfect for a couple or small family as the settee makes into a bed for two.

**Harpoon** is hull number 177 in the Nordic Tug 26 series and powered by a single Yanmar 110HP diesel engine with an added bonus of a bow thruster. Though her 110HP Yanmar burns approximately one GPH at six knots, you can still kick it up to a top speed of 14 knots when needed! New electronics and air conditioning/heating system make this trawler comfortable and easy to operate. See the "Listing Specifications" for more complete details, too many amenities to list! A recent marine survey reported this boat in "Bristol" condition. To see what "Bristol" looks like, please get in touch to request additional details, more photos and to schedule a visit to step aboard **Harpoon**.

### LAYOUT:

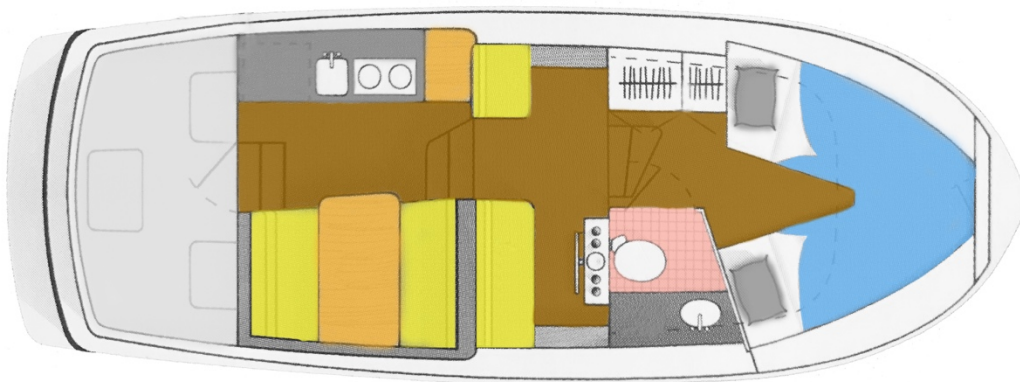

# Nordic Tug 26 Harpoon

## SPECIFICATIONS:

<b>YACHT NAME:</b>	<i>Harpoon</i>
<b>BRAND AND MODEL:</b>	Nordic Tug 26
<b>TYPE:</b>	Recreational Tug Style Trawler
<b>TRAILER:</b>	Tuff Trailer included in price   Triple axel   Electric over hydraulic brakes   Never been in water
<b>LOCATION:</b>	Anacortes, Washington
<b>MODEL YEAR:</b>	2011
<b>HULL NUMBER:</b>	26-177
<b>HULL COLOR:</b>	Oyster
<b>REGISTRY:</b>	Anacortes, Washington
<b>DESIGNER:</b>	Lynn Senour
<b>BUILDER:</b>	Nordic Tugs, Inc., Burlington, Washington
<b>HULL MATERIAL:</b>	Solid Fiberglass
<b>DISPLACEMENT:</b>	8,500 lbs.   3,864 kg
<b>SPEED:</b>	Cruise speed 7 -9 knots   Top speed 14 knots
<b>LOA:</b>	28'9"   8.8M
<b>LWL:</b>	25'2"   7.7M
<b>BEAM:</b>	9'6"   2.9M
<b>DRAFT:</b>	3'3"   1.0M
<b>AIR DRAFT:</b>	8'7"   2.6M bridge clearance
<b>MAIN ENGINE:</b>	Yanmar Diesel   110HP Model number 4JH4-HTE (Main hours: ~217 – August 2019)
<b>EXHAUST:</b>	Wet Exhaust
<b>MACHINERY EQUIPMENT:</b>	Fuel Filter Dual RACOR 75/500 MAX10
<b>THRUSTER:</b>	Side-Power Bow Thruster
<b>ELECTRICAL:</b>	30-amp shore power connection   LED lighting
<b>BATTERIES:</b>	Lifeline AGM Start (1) and House (2) Batteries installed Spring 2019 plus new Blue Sea Battery Charger
<b>CLIMATE CONTROL:</b>	Air Conditioning Package MARINE AIR 12K BTU unit
<b>WINDLASS:</b>	Windlass 1000W Lewmar Pro-Series H1000
<b>GROUND TACKLE:</b>	Rocna Anchor 15kg with 5/16" high test chain plus bow anchor guard
<b>TENDER:</b>	No Tender
<b>DAVIT:</b>	Weaver Davit
<b>COCKPIT COVER:</b>	Custom canvas full cockpit enclosure with screen inserts by Annapolis Custom Yacht Canvas

## Nordic Tug 26 Harpoon

<b>NAV/COM:</b>	Raymarine E Series Multifunction Display/Hybrid Touch   Chart plotter   Radar   AIS send and receive   Depth Finder   Raymarine ST70 Autopilot   Icom IC-502 VHF   Ritchie Compass
<b>STATEROOM:</b>	(1) Master forward v-berth with insert and settee pulls out to double bed to sleep 4
<b>HEAD:</b>	Bemis electric head
<b>SHOWER:</b>	Handheld shower
<b>GALLEY:</b>	Force 10 two burner propane cooktop   Contoure CMC 12070S convection/grill microwave oven   Stainless Steel Sink
<b>REFRIGERATION/FREEZER:</b>	Nova Kool Refrigerator/Freezer (one unit)
<b>WINDOWS:</b>	Sapele mahogany valances with custom curtains
<b>INTERIOR WOOD:</b>	Sapele mahogany
<b>INTERIOR COUNTERS:</b>	Formica countertops with Sapele wood trim
<b>INTERIOR UPHOLSTERY:</b>	Ultra-suede
<b>INTERIOR FLOORING:</b>	Amtico teak and holly throughout with custom Sapele steps
<b>ENTERTAINMENT:</b>	Polyplanar MRD80c Stereo and Speakers - CD, MP3, iPod/iPhone
<b>TANKAGE: (approx.)</b>	
<b>FUEL:</b>	75 US gallons   284L (aluminum tank)
<b>HOLDING BLACK:</b>	20 US gallons   76L
<b>FRESH WATER:</b>	40 US gallons   151L (plastic tank)
<b>SAFETY:</b>	First Alert Smoke and CO2 alarm   Hailer
<b>Note: All information is believed accurate but should be verified.</b>	

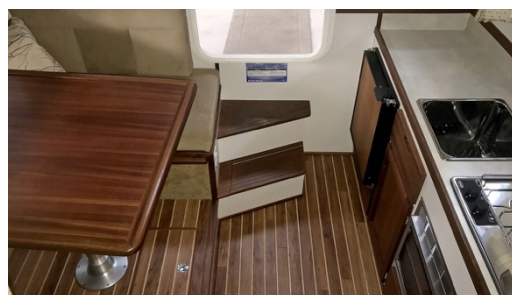
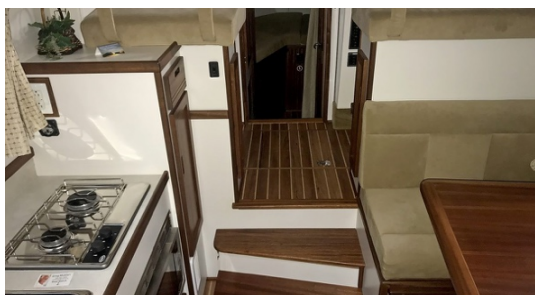

Jeff Merrill Yacht Sales, Inc. © 2019 All Rights Reserved [www.JMYS.com](http://www.JMYS.com)



# Nordic Tug 26 Harpoon

**Exclusions:** Potential purchasers should assume that items on the vessel at the time of viewing, but not specifically listed on this sheet, are not included with the sale of the yacht. These specifications are believed to be true and correct but cannot be guaranteed. Items excluded include, but are not limited to Paintings, tools, handheld nav gear and binoculars. Owner's personal effects and clothing will be removed prior to closing.

**Disclaimer:** Jeff Merrill Yacht Sales, Inc. presents the details of this vessel in good faith but cannot guarantee or warrant the accuracy of this information nor guarantee or warrant the condition of the vessel. Buyers should instruct their agents and their surveyors to investigate all details the buyers desire validated. This vessel is offered subject to prior sale, price change, or withdrawal without notice.

**Brokerage:** JMYS is a US based (licensed and bonded yacht brokerage in California, Florida and Washington) with an international emphasis specializing in ocean capable trawlers. Our brokers are experienced boaters, most are trawler owner/operators with thousands of hours and miles at sea. We treat our clients with respect, we are responsive and not pushy. Our focus is to become your loyal advocate, always looking out for your best interests. The team at JMYS has extensive trawler and motor yacht product knowledge and our skills are available for coaching after the sale has concluded.

**Co-Brokerage:** Fellow yacht broker association members: This listing is available for co-brokerage and JMYS is a 50/50 house. Courtesy showings are available by appointment. Florida listings subject to appropriate broker licensing required by law.

## Listing brokers:



Kelly Libby +1 425.359.7078 [Kelly@JMYS.com](mailto:Kelly@JMYS.com)

NYBA (Northwest Yacht Brokers Association)

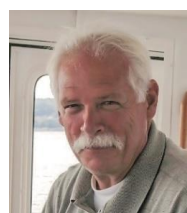

Greg Mustari, CPYB +1 360.507.9999 [Greg@JMYS.com](mailto:Greg@JMYS.com)

Certified Professional Yacht Broker  
NYBA (Northwest Yacht Brokers Association) Board of Directors

