

Kadey-Krogen 39 Patience



JMYS

3010 Old Ranch Parkway, Suite 440, Seal Beach, CA 90740
+1 949.355.4950 | www.JMYS.com



Patience

Asking: \$312,000.00

Location: Deer Harbor, WA

Kadey-Krogen 39 Patience

Lots of adventures await this classy, comfortable, and cruise-ready Kadey-Krogen 39 named ***Patience***.

The lines of a Kadey-Krogen are unmistakably beautiful and easy to spot amidst other boats on the water!

This size is perfect for couples or even single handing.

51 of these models were built between 1997 and 2014. Lovingly enjoyed and cared for by the second owners since 2005, ***Patience*** is hull number 17, a 2000 model year edition.

Construction of hull and superstructure features USA made gelcoat, hand laid fiberglass with closed-cell PVC sandwiched core in topsides, and blister resistant resin below waterline.

The Krogen 39 interior layout features a single stateroom and single head.

From a fully enclosed large cockpit area, there is cozy salon with an L-shaped settee on the starboard side as well as a settee on the port side – a great place for guests to relax and place orders from the chef in the U-shaped galley!

The raised pilothouse along with a flybridge above gives the captain a choice of which helm to navigate from.

The engine room provides standing headroom forward as well a workbench.

Please note that we have provided the layout diagrams as well as detailed listing specifications.

If you'd like more pictures or have questions, don't hesitate to contact us. We look forward to coordinating a date and time to see ***Patience***. She's located in beautiful Deer Harbor, a wonderful cove setting that will encourage you to take off and travel to remote locations on your own.

Kadey-Krogen 39 Patience

LAYOUT:

Pilothouse:

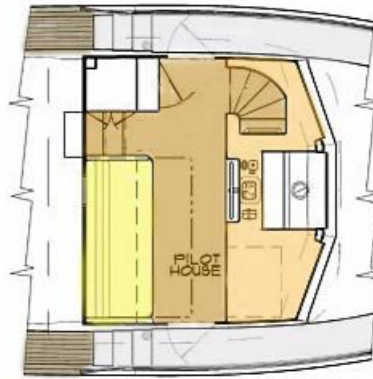

Boat Deck and Flybridge:

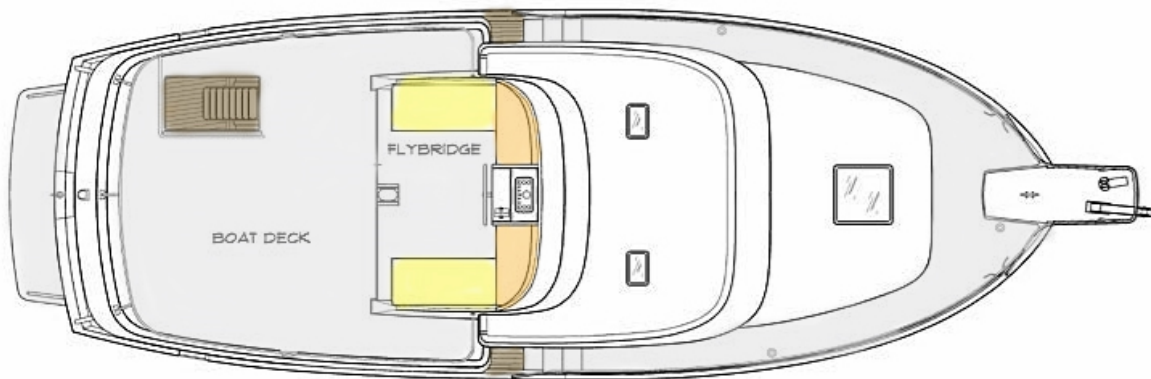

Main Deck – Saloon, Galley and Lower Deck Stateroom:



Kadey-Krogen 39 Patience

SPECIFICATIONS:

YACHT NAME:	<i>Patience</i>
BRAND AND MODEL:	Kadey-Krogen 39 Flybridge
TYPE:	Long range passage maker, raised pilothouse
LOCATION:	Deer Harbor, WA
MODEL YEAR:	2000
HULL NUMBER:	17
HULL COLOR:	White gelcoat
REGISTRY:	United States Coast Guard documented 1099451
DESIGNER:	Jim Krogen
BUILDER:	Asia Harbor Yacht Builders Co., Ltd.
HULL MATERIAL:	Solid fiberglass
DISPLACEMENT:	33,470 lbs. 15.18 MT
BALLAST:	2,000 lbs. 907 KG (Lead)
RANGE:	4,170 NM @ 6 knots; 2,620 NM @ 7 knots
SPEED:	7-8 Knots
LOA:	43'8" 13.3 M
LWL:	36'8" 11.2 M
BEAM:	14'9" 4.5 M
DRAFT:	4'3" 1.3 M
D/L:	303
A/B:	2.6:1
Cp:	Prismatic Coefficient .60
AIR DRAFT:	22'0" 33' top of antennae (est.)
DECK:	Aft and side decks: teak Boat deck and foredeck: Awlgrip non-skid
MAIN ENGINE:	John Deere 4045 TFM 120 HP (Main hours: ~1,759) Nov 2019 Stand up engine room with work bench
TRANSMISSION	Twin Disc 2.39:1 ratio gear
PROPELLER / SHAFT	1.75" Aquamet shaft 3 blade LH propeller 26" x 17" Prop protector
EXHAUST:	Wet exhaust
THRUSTER(S):	Keypower bow thruster
ELECTRICAL:	60 Hertz – US style - 50 amp
SHORE POWER:	50 amp (fore and aft)
INVERTER/CHARGER:	Magnum Sine Wave MS 2812 inverter/ charger (New July 2018)
BATTERIES:	Rolls Royce marine deep cycle

Kadey-Krogen 39 Patience

INTERIOR LIGHTING:	LED
CLIMATE CONTROL:	Hurricane diesel heat Heatercraft engine heat
MACHINERY EQUIPMENT:	Dual Racor fuel filters Fiberglass muffler
WINDLASS:	Lofrans Tigres electric
GROUND TACKLE:	20 KG Lewmar anchor, 300 ft. chain and additional claw anchor
MAST/BOOM:	JSI mast/boom/tabernacle system
TENDER AND OUTBOARD:	Avon tender Honda outboard 2.3 HP
NAV/COM BRANDS:	Simrad - Robertson autopilot Nobeltec with laptop computer/printer Furuno Compass Rudder angle indicator VHF radios plus handheld
STATEROOM:	(1) master forward island queen bed
HEAD:	Vacuflush (freshwater)
SHOWER:	Single molded fiberglass with bi-fold door New shower sump pump July 2019
GALLEY:	Force 10 propane 3 burner stove/oven Nova Kool refrigerator/freezer Sharp microwave convection oven Deep stainless steel sink
INTERIOR WOOD:	Teak and Spruce
INTERIOR COUNTERS:	Corian counters
INTERIOR UPHOLSTERY:	Sunbrella fabric (blue)
INTERIOR FLOORING:	Teak and holly floors in pilothouse, teak parquet floors throughout
BILGE PUMPS:	(4) electric standard
TANKAGE: (approx.)	
FUEL:	(2) x 350 gallons = 700 gallons 2650L. (Aluminum 5052) with sight gauges.
HOLDING BLACK:	34 gallons 128 L Sealand 40400 (Polyethylene) New tank May 2018
FRESH WATER:	300 gallons 1136 L (Stainless steel)
ADDITIONAL EQUIPMENT:	Culligan water filter Magma BBQ
SAFETY:	Lifesling overboard rescue system
PHOTO DATE:	Most detail photos were taken in October/November 2019
Note: All information is believed accurate but should be verified.	

Kadey-Krogen 39 Patience



Exclusions: Potential purchasers should assume that items on the vessel at the time of viewing, but not specifically listed on this sheet, are not included with the sale of the yacht. These specifications are believed to be true and correct but cannot be guaranteed. Items excluded include, but are not limited to Paintings, tools, handheld nav gear and binoculars. Owner's personal effects and clothing will be removed prior to closing.

Disclaimer: Jeff Merrill Yacht Sales, Inc. presents the details of this vessel in good faith but cannot guarantee or warrant the accuracy of this information nor guarantee or warrant the condition of the vessel. Buyers should instruct their agents and their surveyors to investigate all details the buyers desire validated. This vessel is offered subject to prior sale, price change, or withdrawal without notice.

Brokerage: JMYS is a US based (licensed and bonded yacht brokerage in California, Florida and Washington) with an international emphasis specializing in ocean capable trawlers. Our brokers are experienced boaters, most are trawler owner/operators with thousands of hours and miles at sea. We treat our clients with respect, we are responsive and not pushy. Our focus is to become your loyal advocate, always looking out for your best interests. The team at JMYS has extensive trawler and motor yacht product knowledge and our skills are available for coaching after the sale has concluded.

Co-Brokerage: Fellow yacht broker association members: This listing is available for co-brokerage.

Kadey-Krogen 39 Patience

This listing specification has been approved by the sellers for accuracy. The photos, images and descriptive content are copyrighted by JMYS and may not be copied or used without specific written permission. Please contact listing brokers, Kelly Libby and Greg Mustari, CPYB for additional information or to schedule a viewing appointment to inspect ***Patience*** in person. Please call to make an appointment to step aboard.

Listing brokers:



Kelly Libby
+1 425.359.7078
Kelly@JMYS.com

NYBA (Northwest Yacht Brokers Association)

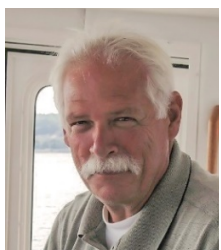

Greg Mustari, CPYB
+1 360.507.9999
Greg@JMYS.com

Certified Professional Yacht Broker
NYBA (Northwest Yacht Brokers Association) Board of Directors

