

# Camano Troll 31 Fyna-Lee



# JMYS

3010 Old Ranch Parkway, Suite 440, Seal Beach, CA 90740  
+1 949.355.4950 | [www.JMYS.com](http://www.JMYS.com)



## *Fyna-Lee*

**Asking: \$92,000.00**

**Location: Anacortes, WA**

Jeff Merrill Yacht Sales, Inc. © 2021 All Rights Reserved [www.JMYS.com](http://www.JMYS.com)

## Camano Troll 31 Fyna-Lee

Have you heard the boating phrase - seats six for cocktails, four for dinner and sleeps two? That's exactly the sentiment behind the Camano 31' design. This boat is perfect for a couple. Her cruising capability is versatile. She is great for weekend travels or longer voyages up north to Alaska.

**Fyna-Lee** is a one stateroom, one head trawler with a huge salon and galley down. From the cockpit you can access the roomy flybridge and upper helm with seating for five. Walk in the salon and it is open and airy with a lot of light and bright visibility. You can easily seat six at the settee on the port side and if you have company, the settee converts to a guest bed. To starboard is the lower helm.

Regarding fuel and speed, this boat burns one to two gallons per hour at seven to nine knots in normal water conditions but she can cruise up to 15 knots!

**Fyna-Lee**, let's coordinate a time to meet here in Anacortes to see this Camano Troll!

### LAYOUT:

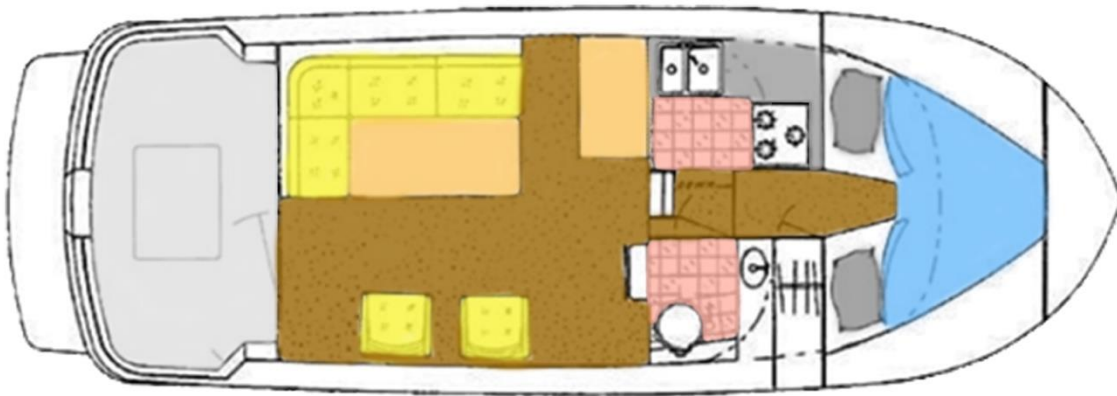

# Camano Troll 31 Fyna-Lee

## SPECIFICATIONS:

<b>YACHT NAME:</b>	<i>Fyna-Lee</i>
<b>BRAND AND MODEL:</b>	CAMANO TROLL
<b>TYPE:</b>	Trawler style motor yacht with flybridge
<b>LOCATION:</b>	Anacortes, Washington
<b>MODEL YEAR:</b>	1998
<b>HULL NUMBER:</b>	83
<b>HULL COLOR:</b>	Soft white with black window trim and boot striping
<b>REGISTRY:</b>	Anacortes, Washington
<b>DESIGNER:</b>	Bob Warman
<b>BUILDER:</b>	Camano Marine Ltd, Delta, British Columbia, Canada
<b>HULL MATERIAL:</b>	Solid Fiberglass
<b>DISPLACEMENT:</b>	10,000 lbs. / 4535 kg
<b>SPEED:</b>	Cruise speed 8 -10 knots   Top speed 13 - 15 knots
<b>LOA:</b>	31'   9.4 M
<b>LWL:</b>	26'3"   8 M
<b>BEAM:</b>	10'6"   3.2 M
<b>DRAFT:</b>	3'3"   0.9 M
<b>AIR DRAFT:</b>	11'6"   3.5 M bridge clearance
<b>MAIN ENGINE:</b>	Volvo Diesel   200HP TAMD41PA (Main hours: 2124 - June 2020)
<b>EXHAUST:</b>	Wet Exhaust
<b>MACHINERY EQUIPMENT:</b>	Dual Racor fuel filters
<b>STEERING STATIONS:</b>	(2) Inside helm and flybridge
<b>THRUSTER:</b>	Key Power Bow thruster
<b>ELECTRICAL:</b>	30 amp shore power connection
<b>INVERTER:</b>	Xantrex 1750 watt
<b>BATTERIES:</b>	(4) house and (1) engine   Tru Charge 40 Battery Charger   Link Battery Monitor
<b>CLIMATE CONTROL:</b>	Webasto diesel forced air heat   Red Dot cabin heat
<b>WINDLASS:</b>	Simpson Lawrence (SL) 500 electric windlass
<b>GROUND TACKLE:</b>	Bruce Anchor 10kg with 35' chain and 200' line
<b>NAV/COM:</b>	Autohelm ST7000 Autopilot and Rudder Angle   Raymarine Wireless Remote Auto Pilot   Autohelm

## Camano Troll 31 Fyna-Lee

	Radar, Speed, Depth Sounder   Garmin GPS 129, GPS enabled PC running nav software   Lowrance X45 Depth Sounder   (2) Icom VHF radios and compass
<b>STATEROOMS:</b>	Owner forward v-berth with insert and settee pulls out to double bed (sleeps 4)
<b>HEADS:</b>	Vacuflush head with tank monitor
<b>SHOWERS:</b>	Handheld showers in head and cockpit
<b>GALLEY:</b>	Force 10 three burner propane stove and cooktop   Microwave   Stainless steel sink
<b>REFRIGERATION/FREEZER:</b>	Nova Kool Refrigerator/Freezer
<b>WINDOWS:</b>	Bali cellular shades in Salon and Galley   Exterior Screen
<b>INTERIOR WOOD:</b>	Teak trim
<b>INTERIOR COUNTERS:</b>	Formica
<b>INTERIOR UPHOLSTERY:</b>	Fabric
<b>INTERIOR FLOORING:</b>	Carpet and vinyl with teak steps
<b>ENTERTAINMENT:</b>	Radio with 10-CD changer
<b>TANKAGE: (approx.)</b>	
<b>FUEL:</b>	100 US gallons / 378 L (aluminum)
<b>HOLDING BLACK:</b>	30 US gallons / 114 L (plastic)
<b>FRESH WATER:</b>	150 US gallons / 567 L (plastic)
<b>Note: All information is believed accurate, but should be verified.</b>	

## Camano Troll 31 Fyna-Lee



**Exclusions:** Potential purchasers should assume that items on the vessel at the time of viewing, but not specifically listed on this sheet, are not included with the sale of the yacht. These specifications are believed to be true and correct but cannot be guaranteed. Items excluded include, but are not limited to Paintings, tools, handheld nav gear and binoculars. Owner's personal effects and clothing will be removed prior to closing.

**Disclaimer:** Jeff Merrill Yacht Sales, Inc. presents the details of this vessel in good faith but cannot guarantee or warrant the accuracy of this information nor guarantee or warrant the condition of the vessel. Buyers should instruct their agents and their surveyors to investigate all details the buyers desire validated. This vessel is offered subject to prior sale, price change, or withdrawal without notice.

**Brokerage:** JMYS is a US based (licensed and bonded yacht brokerage in California, Florida and Washington) with an international emphasis specializing in ocean capable trawlers. Our brokers

Jeff Merrill Yacht Sales, Inc. © 2021 All Rights Reserved [www.JMYS.com](http://www.JMYS.com)

# Camano Troll 31 Fyna-Lee

are experienced boaters, most are trawler owner/operators with thousands of hours and miles at sea. We treat our clients with respect, we are responsive and not pushy. Our focus is to become your loyal advocate, always looking out for your best interests. The team at JMYS has extensive trawler and motor yacht product knowledge and our skills are available for coaching after the sale has concluded.

**Co-Brokerage:** Fellow yacht broker association members: This listing is available for co-brokerage and JMYS is a 50/50 house. Courtesy showings are available by appointment. Florida listings subject to appropriate broker licensing required by law.

## LISTING BROKERS:



Kelly Libby +1 425.359.7078 [Kelly@JMYS.com](mailto:Kelly@JMYS.com)

NYBA (Northwest Yacht Brokers Association)

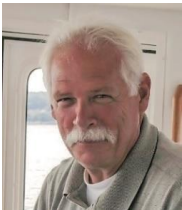

Greg Mustari, CPYB +1 360.507.9999 [Greg@JMYS.com](mailto:Greg@JMYS.com)

Certified Professional Yacht Broker

NYBA (Northwest Yacht Brokers Association) Board of Directors

