

Nordhavn 40 Sea Trek



JMYS

3010 Old Ranch Parkway, Suite 440, Seal Beach, CA 90740
+1 949.355.4950 | www.JMYS.com

Jeff Merrill Yacht Sales, Inc. | 3321 SE 14 Avenue | Fort Lauderdale, FL 33316



Sea Trek

Price: \$475,000.00

Location: Daytona Beach, FL

Nordhavn 40 Sea Trek

Sea Trek is an ocean ready, full displacement trawler that can truly travel to almost any place you can imagine. The Nordhavn 40 design is the smallest passage maker built by PAE. A sistership completed a 26-week circumnavigation in 2001. The Nordhavn 40 platform is solid, stable, and capable - engineered to safely take you across the ocean or along the coast in an economical package that has no equal in this size and price range.

The current owners have cruised full time on **Sea Trek** for the past three years up and down the East Coast from Maine to Florida and The Bahamas. They have maintained **Sea Trek** in exceptional condition making significant upgrades, including:

- Electronics:
 - Two 12" Simrad NSS EVO3 MFD with remote Wi-Fi connections
 - Two 7" Simrad NSS EVO3 MFD with remote Wi-Fi
 - Simrad Doppler 4G radar
 - Transducers (in hull and thru hull)
 - VHF radio ICOM M506 NMEA 2000/AIS VHF Radio with hailer
- Power:
 - 730-watt LG solar system with 2 LG 365-watt panels
 - Magnum MS2812 inverter/charger
 - Five 8D batteries
- Mechanical:
 - NAIAD stabilizer Multisea II
 - Engine mounts
 - Main gear (transmission)
 - (7) CCTV cameras monitoring engine room
- Living conveniences:
 - Vitrifrigo drawer refrigerator and freezer
 - Raritan Marine Elegance freshwater toilet with tank monitoring system
 - Watermakers Inc, reverse osmosis 400 GPD water maker
 - Queen mattress in owner's suite
 - Wall to wall Berber carpet
- Safety:
 - Viking RescuYou Pro 4-person offshore life raft
 - Manuals for all systems have been digitized for quick search
- Dinghy:
 - Highfield aluminum hull RIB 10'5" dinghy with steering wheel
 - Garmin navigation with transducer
 - Tohatsu 20HP outboard

See details of additional enhancements listed below.

Nordhavn 40 Sea Trek

NORDHAVN 40 MODEL BACKGROUND:

The 40 is the sixth design in the Nordhavn series. She was conceived to create an entry level vessel that an adventurous couple could use to explore with an “out of the box” range of 3,000 miles. Most of the people who buy a Nordhavn 40 are owner operators, whether new or seasoned. They appreciate the generous interior accommodations (saloon and galley on the entry level, raised pilothouse and two staterooms with one head on the lower level) and seakindly ride through the water with home comforts and conveniences.

Sea Trek is a first generation (US built) Nordhavn 40 – hull 32 out of 44 produced in southern California by legendary cruising sailboat builder, Pacific Seacraft. When this California builder faltered at hull 44, PAE/Nordhavn shipped the tooling to the Nordhavn yard in China to continue production starting with hull 45 and differentiated the two versions in this series as Mark I US made, and Mark II China built.

The saloon is spacious because it is pushed out on both sides, no wasted space filled with rarely used walking side decks. **Sea Trek** was ordered with the optional fly bridge, which provides an excellent outdoor area above the pilothouse for taking command underway or relaxing when at rest.

Following in the footsteps of the older and larger siblings that preceded her, the Nordhavn 40 established a production hallmark that set the standard for all Nordhavn models to follow. Starting with highly polished tooling, she has a solid fiberglass hull layup with integrated swim platform. The deck layout took advantage of many preferred features including a recessed anchor well on the bow, built-in deck boxes on the foredeck and a Portuguese bridge. Outside and up some steps, takes you to the boat deck and flybridge. The dinghy is mounted aft (athwartships) and the mast supported boom is used to launch and retrieve the tender.

Seventy Nordhavn 40s have been produced, approximately 44 in the US and 30 in China. The rising costs of materials and labor has pushed the new boat price for a well outfitted Nordhavn 40 into an uncomfortable territory. Fortunately, the quality construction and owner care supports a high residual value for brokerage (used) boats that have kept this model increasingly popular for over two decades with no end in sight.

Note: In 2020 there is a significant import Tariff for Chinese built products (new and used). The US built 40 Mark I is not subjected to the 26.5% duty, but a non-US flagged brokerage Mark II can be excessively expensive to import – please consult with a qualified maritime attorney before purchasing a Mark II.

DESCRIPTION:

Cockpit: The cockpit (aft deck), is sufficiently sized to provide an easy entry landing for gaining access to the interior. There is a molded in swim platform aft for getting in and out of the water or transitioning to your tender. There are two hull boarding doors, one aft from the swim platform and one on the starboard side for dock access. A hot and cold fresh water shower is installed for rinsing off. The large opening floor hatch provides access to the lazarette below. The boat deck extends partially over the cockpit and there are two molded in seats aft, one for supply storage, the other is the propane locker.

- Two boarding doors – aft and to starboard
- Swim ladder for swim platform

Nordhavn 40 Sea Trek

- Two built in seats with cushions are aft, facing forward (port side doubles as propane locker)
- Hot and cold freshwater shower
- Aft CCTV camera (2020)
- Air vents for engine room

Lazarette: Located below the cockpit through the large hatch is the lazarette. The forward bulkhead has a hinged step where most of the house and start batteries are located. All (5) of the house batteries were replaced in 2019. The inverter is outboard to starboard, there is an electric bilge pump, water maker and steering. On the port side is the fresh water accumulator tank and hot water tank. An emergency tiller is fitted in the overhead. The custom swim ladder is stored here too. This is a larger area that is a convenient storage cavern for extra supplies and gear.

- Concealed battery bank under forward bulkhead hinged lid step
- Magnum MS2812 inverter/charger (2019)
- Jabsco electric bilge pump
- Watermakers Inc, reverse osmosis 400 GPD water maker (2019)
- Hydraulic steering ram
- Raymarine autopilot
- Seward 10-gallon hot water tank
- Fresh water accumulator tank
- Swim ladder
- Emergency tiller
- Locking rod from engine room to secure cockpit hatch

Saloon: One unique feature on the Nordhavn 40 is the lack of walking side decks – this makes for a much wider saloon and through traffic is directed via the interior which is actually faster and safer. A Diamond SeaGlaze full height door (with dogs and gasketing) leads into the saloon which has an L-shaped Ultraleather settee to starboard and another built in settee to port. Both settees have storage underneath. There is an adjustable hi-low teak table which can be positioned in a variety of locations depending upon how you want to use it for eating, working or relaxing. The sole is carpeted. For entertainment, a flat screen television is mounted forward to starboard with a stereo locker.

- Wall to wall comfortable Berber carpeting (2019)
- High/Low teak table with folding leaves – moveable
- Slide windows with screens
- Teak magazine storage rack
- Teak book storage shelves
- Entertainment cabinet with 24" LG flat-screen Smart flat screen TV (2018)
- Adjustable blinds on all windows
- Fusion stereo with marine-grade stereo speakers (2018)
- Controls for air conditioning
- Ship's clock and barometer

Nordhavn 40 Sea Trek

Galley: Moving forward on the same level as the saloon connects you to the galley portside. The beautiful teak faced column that provides delivery of the main engine dry stack exhaust creates a natural divide while retaining an open-air feeling. The current owners have taken their time aboard seriously, and upgraded the refrigerator freezer system from the standard door opening Sub Zeros (very electricity hungry) to much better and more efficient Vitrifrigo stainless faced drawers (two sets, one in the galley and one outboard to starboard across from the galley). A new microwave oven (stainless surface) with an exhaust fan has also been installed. This is a functional galley with Corian counters, teak lockers and drawers and two opening portlights outboard. On the aft counter is a large stainless-steel sink with Grohe faucet. There is a Seaward 10 three-burner propane stove and oven with broiler and overhead fan. The galley creates an intersection with two choices, you can go down the centerline hallway to reach the head and staterooms or continue up a few short steps to the pilothouse.

- Vitrifrigo 110V/12V refrigerator (2018)
- Additional 110V Vitrifrigo freezer with icemaker in cabinet to starboard opposite galley (2018)
- Seaward three-burner propane stove and oven with broiler
- GE microwave oven with exhaust fan (2019) Identical microwave as spare part included.
- Broan trash compactor with teak face
- Aqua Pure fresh water filtration system
- Large basin stainless steel sink
- Multiple teak drawers, lockers and overhead cabinets for storage
- Teak spice rack
- Teak paper towel rack
- Corian countertops
- Lonseal raised coin vinyl flooring
- Two opening portlights outboard

Pilothouse: The Pilothouse is accessed a few steps up from the entry level. The view from the pilothouse is outstanding - you are surrounded by windows looking forward, outboard and aft. There are two Dutch Doors outboard for easy outside deck access. The navigation equipment was upgraded in 2018/2019 and includes a full suite of Simrad electronics complete with touchscreen control and with all chart software up to date. There is a stainless-steel wheel with a well laid out dash area fitted with all of the electronics control screens smartly positioned above and below the forward windows. The electrical panel breaker is behind a clear door cabinet to starboard. On the horizontal dash you have the main engine and wing engine control levers. On the vertical face there are controls for the bow thruster, anchor windlass, horn, wipers, etc. All of the primary ships systems are monitored from this raised pilothouse including controls for the watermaker, generator, inverter and air conditioning systems. The aft section has a watch berth and a large sofa settee fronted by a custom, adjustable teak table making this an easy place to run the vessel or as a shipside office when in port.

- Two 12" Simrad NSS EVO3 MFD with remote Wi-Fi connections (2019)
- Two 7" Simrad NSS EVO3 MFD with remote Wi-Fi (2019)
- Simrad Doppler 4G radar (2019)
- NMEA 2000 networked NEP-2 switching installed (2019)
- Analog to digital instrument converter installed (2019)

Nordhavn 40 Sea Trek

- Seven (7) CCTV cameras covering stern and key engine room function – (2020)
- Sirius XM WX WM-3 and antenna installed. (new 2019)
- Dedicated OptiPlex computer and 13” screen running Coastal Explorer with NMEA 2000 interface (2019)
- New In-hull transducer installed (2019)
- Thru-hull Airmar Speed /Temp Transducer (2019)
- ICOM M506 NMEA 2000/AIS VHF Radio with hailer (2020)
- ICOM M502 NMEA 182 VHF Radio
- ICOM M710 SSB radio (not installed, but included in sale)
- KVH LTE-1 communications systems with internal router and Wi-Fi (2018)
- Ritchie Compass
- Raymarine 6001+ Autopilot with remote
- Marine-grade speakers and controls
- NAIAD stabilizer Multisea II control panel (2019)
- Bow thruster joystick control
- Maxwell anchor windlass control
- Magnum inverter /battery charger control
- Northern Lights genset monitor panel
- Marine Air air-conditioning and heat controls
- Large stainless-steel destroyer helm
- Ultraleather bench helm seat
- Custom teak table with aluminum adjustable arm for optimum positioning
- Storage below foot landing
- Ultraleather watch berth
- Folding chart table outboard to port.
- Diamond SeaGlaze Dutch doors port and starboard
- Hynautic hydraulic steering (*See JMYS Trawler Skills video on YouTube)
- Opening and screened side windows port and starboard
- Textilene window covers (two sets included)
- Generous storage underneath steps leading up to pilothouse

Down a few short steps in the center of the vessel, a wide hallway connects the upper entry level with the staterooms and head below. This entire lower level floor is carpeted (except the head which has a gelcoat/fiberglass sole).

Guest Stateroom: The guest stateroom is to port and features two bunk beds. The upper bunk is fixed, the lower bunk can be pulled out to be made wider. There is good lighting overhead and by the bunks. Outboard are two portlights that can be opened for ventilation. Below the lower bunk you have access to the active fin stabilizer on the port side. The Splendide combination laundry appliance is secure in a locker and there is a hanging locker and shelf area with drawers. Aft in the guest stateroom is the door entry to the engine room.

- Upper and lower berths

Nordhavn 40 Sea Trek

- Large drawer under lower berth (access to active fin stabilizer)
- Large hanging locker
- Reading lights
- Two opening screened portholes
- Splendide clothing washer/dryer combination laundry appliance
- Dogged door entry access to engine room

Engine Room: You enter the engine room through a door located aft in the guest stateroom (you can also enter though the sole, aft in the saloon). The maintenance strakes molded into the hull create additional headroom outboard of the main engine on both sides. Two fiberglass fuel tanks with perforated aluminum screens are outboard and each tank has its' own sight glass for a quick fuel level viewing. Both tanks feed a supply tank in the forward bilge and this reservoir has a water in fuel alarm and a sump built in for stripping out water or fuel tank debris. This engine room is well laid out, has foam padding along the sole and has been equipped with all systems and components easy to inspect and service. The Lugger L688D main engine is keel cooled with a dry stack exhaust and mated to a Twin Disc 3.0:1 transmission. This is a continuous duty rated power plant that was engineered for non-stop passage making over several days or weeks. Fresh air intake from the cockpit risers and internal blowers keep air circulating and the hot air is directed up the stack to vent out above the engine room. circulation to maintain ideal engine room operating temps. Diesel fuel filtration is accomplished by dual Racor 900 filters and a Racor 500 filter for the generator. Oil changes are convenient through the use of a Reverso oil change system plumbed to the main engine and the generator. The 20-gallon Raritan water heater was replaced in 2015. In order to help with clean fuel **Sea Trek** has a fuel filtering system and the ability to transfer fuel between tanks.

- Lugger L668D 105 HP main engine
- Dry stack exhaust
- InsulTech exhaust blanket
- Twin Disc MG-55050 transmission 3.0:1 with pressure gauge (2019) *See Owner Comments at end of this specification
- Main engine mounts (2019)
- Fiberglass fuel tanks with inspection hatches
- Gravity drain fuel system to aluminum supply reservoir manifold with water in fuel alarm and sump drain
- Spurs line cutter (2018)
- Cutlass bearing (2018)
- (2) fiberglass fuel tanks, (1) aluminum supply tank
- Fresh water pump and strainer Shurflo freshwater pump (with spare)
- Naiad active fin stabilizer reservoir (upgraded to Multisea II in 2019)
- Jabsco stabilizer cooling pump (2020)
- Reverso oil change manifold for main and generator
- 8kW Northern Lights Generator with sound shield (sound proofing replaced 2019)
- Yanmar model 3GM30FV 24 BHP wing engine
- Kanzaki KM3V-drive transmission on wing engine. *Transmission new in 2014

Nordhavn 40 Sea Trek

- 10-gallon aluminum day tank with sight glass for wing engine
- Engine room blower
- New start battery for wing engine/generator (2019)
- Racor 900 duplex dual primary filters on main engine
- Dent vacuum gauge on Racors (2019)
- Racor 500 primary filter for genset
- Racor 900 for fuel transfer with Walbro pump and timer
- Secondary oil pressure and water temperature gauges (2020)
- Fireboy fire suppression with pull cable in saloon
- Fresh water rinse faucet with hoses
- Escape hatch, entrance access aft in saloon
- Jabsco electric bilge pump
- Ultra switch sensor for high water bilge pump
- Edson manual bilge pump
- (6) Closed circuit TV cameras (2020)
- All engine room lighting (110V and 12V) upgraded to LED (2019)
- Soft tile flooring

Head and shower: The guest head features a separate shower enclosure, an electric flush fresh water head, a vanity and medicine cabinet all highlighted by a beautiful Corian countertop with built in sink and teak trim throughout. Fresh air is circulated via two opening screened portholes supplemented by an exhaust fan in the shower.

- Corian countertop with built-in sink
- Mirror in teak framed cabinet with locker doors above sink
- Two opening screened portholes – one in shower one in head
- Fiberglass/gelcoat sole flooring
- Separate full headroom stall shower enclosure with tempered glass door
- Teak grate shower seat over molded fiberglass locker
- Access to starboard active fin stabilizer under shower seat
- Exhaust fan in shower overhead
- Whale Gulper sump pump for shower water discharge
- Raritan Marine Elegance electric freshwater head with smart controller and complete replacement kit for all components (2018)
- Waste lines replaced with Trident Premium hose (2018)
- Y-valve to holding tank or overboard
- Tank Watch holding tank monitor (2018)

Owner's Stateroom: The owner's stateroom is below the foredeck in the bow of the boat. Most prominent is her large island berth featuring a custom-made Zeno mattress (2020). There is storage underneath the steps and the bed (ideal for light, bulky provisions -paper towels, etc. - and spares). Below the bed is also access to the bow thruster and a separate house battery bank for powering the bow thruster and windlass. Ventilation is provided via the large hatch overhead, opening portlights

Nordhavn 40 Sea Trek

outboard and two round portlights aft in the Portuguese bridge. The interior hull sides have varnished teak ceilings. Forward are two locker doors that provide access to the chain locker. All cabinetry and furniture are teak: overhead lockers, drawers and hanging lockers. There is a built-in changing seat with upholstered cushion to starboard. Controls for the windlass and bow thruster are mounted in the bed frame. This room is carpeted. The black water holding tank is accessed below the carpeted area at the foot of the bed. There is a flat screen television with built in DVD mounted on the aft bulkhead.

- Centerline queen berth with Zeno custom mattress (2020) and storage underneath
- Two large cedar-lined hanging closets with lights
- Teak bureau with drawers
- Overhead teak lockers along berth on both sides
- Port-side and starboard side book racks
- Reading lights
- Air conditioning and heat controls
- ProScan TV with DVD mounted aft
- Overhead hatch with insect screen
- Two oval opening screened portlights outboard on each side (with deadlights)
- Two round opening screened portholes aft – bringing in light and air from the Portuguese bridge
- Cabin door has mirror on hallway side

Boat Deck: The large boat deck stows the athwartship mounted Highfield 10'5" aluminum-hull inflatable dinghy powered by a 20 HP Tohatsu outboard with electric start (new in 2019). The dinghy is launched via remote controls for the electric winches mounted on the boom. New lines and cables were installed in 2018. Weaver removeable jack stands and tie downs for securing the tender. There is a large fiberglass deck box mounted forward to port. The Viking life raft is mounted to starboard on the stainless-steel railing

- Highfield aluminum hull RIB 10'5" dinghy with steering wheel and cover (2019)
- Garmin navigation with transducer for dinghy (2019)
- Forespar mast and boom for dinghy (new lines and cable 2018)
- Electric winch with custom cover and remote
- Viking RescuYou Pro 4-person off shore life raft (2018)
- Large dock box mounted port side
- Stainless steel fender holder

Flybridge: The Flybridge is atop the pilothouse which places you up high with an unrestricted 360-degree view. There are two helm chairs providing a comfortable perch. Overhead a framed Bimini and atop that is a series of solar panels braced on a stainless framework. Driving from the flybridge is a joy, primary navigation and communication electronics are repeated.

- Highfield aluminum hull RIB 10'5" dinghy with steering wheel and cover (2019)
- Garmin navigation with transducer for dinghy (2019)
- Forespar mast and boom for dinghy (new lines and cable 2018)
- Electric winch with custom cover and remote
- Viking RescuYou Pro 4-person off shore life raft (2018)

Jeff Merrill Yacht Sales, Inc. © 2021 All Rights Reserved www.JMYS.com

Nordhavn 40 Sea Trek

- Large dock box mounted port side
- Stainless steel fender holder
- Inflatable dock platform with electric pump

Foredeck and Exterior

- Hull was painted with AlexSeal (2017)
- Deck superstructure is white gelcoat and deck is molded gray nonskid gelcoat
- Portuguese Bridge with recessed storage lockers
- Overhead courtesy lighting
- Maxwell VM 2200 electric windlass with capstan
- Anchor bale roller (2019)
- Windlass controls at foredeck, pilothouse and flybridge
- 35 KG Buglers anchor with 400' 3/8 HT chain
- Chain roller fairlead for anchor chain
- Mantus anchor snubber
- Dock lines and fenders
- Four-step removable boarding ladder for swim platform
- Aluminum painted mast and boom
- Boom winches for dinghy launching
- Mast has a tabernacle at the base for lowering

Electrical: General summary of electrical equipment aboard **Sea Trek**.

- Northern Lights 8 kW generator with sound shield
- Magnum 3 kW inverter/charger with smart controller and advanced remote battery monitoring kit (2019)
- All batteries enclosed in FRP boxes with strap-down lids (2019)
- Smart shore power outlets amidships on starboard side
- 30-amp shore power cord for house
- 30-amp shore power cord for air conditioning
- Various electrical splitters
- 12V DC, 110V AC, 230V AC systems
- LED lighting upgrade
- Galvanic isolator
- Copper bonding system
- Balmar 160-amp alternator with Balmar Max Charge regulator
- 730-watt LG solar system with 2 LG 365-watt panels, Victron MPPT controller with Bluetooth, wireless battery monitors on both forward and aft battery banks (new 2019)

Nordhavn 40 Sea Trek

LAYOUT: Raised Pilothouse

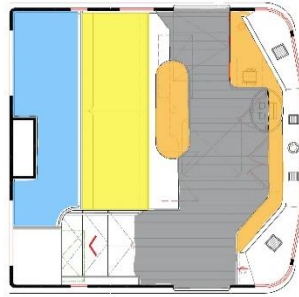

LAYOUT: Main and Lower Deck – Saloon, Galley Head and Staterooms

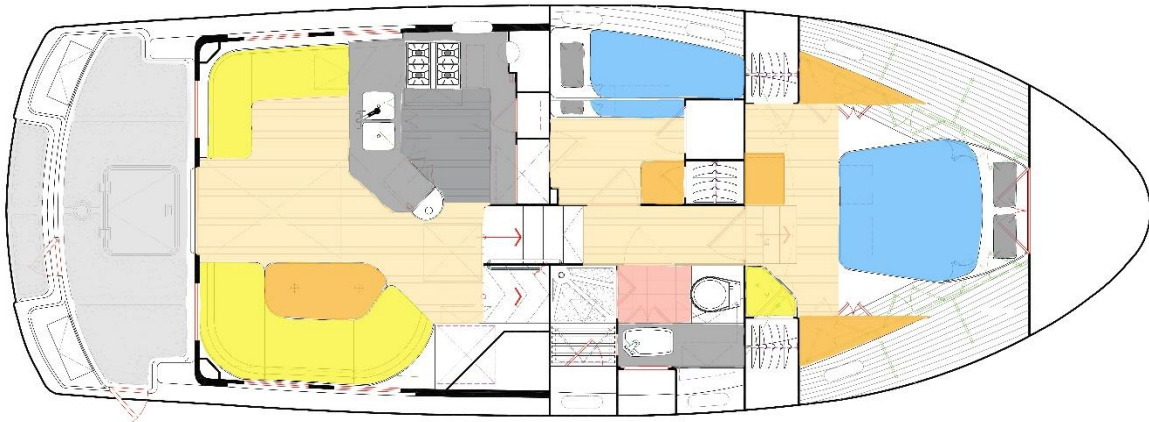

Safety:

- Fireboy engine room fire suppression system with pull cable (recertified 2019)
- Viking 4-person Life raft (2018)
- EPIRB (recertified 2018)
- Two throwable life rings with automatic crew overboard marker lights mounted into deck outboard of pilothouse
- Air horn
- Engine room high water bilge alarm
- Required US Coast Guard placards and equipment – current dates
- Offshore automatic inflatable lifejackets (4)
- Recreational automatic inflatable lifejackets (2)
- PFD Type I lifejackets (adult & child sizes)

Nordhavn 40 Sea Trek

SPECIFICATIONS:

YACHT NAME:	SEA TREK
BRAND AND MODEL:	Nordhavn 40
TYPE:	Long range trawler yacht with raised pilothouse and flybridge
LOCATION:	Daytona Beach, FL
MODEL YEAR:	2002
HULL NUMBER:	32
HULL COLOR:	Hull Pearl Gray Alexseal paint/Jade Mist stripes (painted 2017)
DECK:	White deck with gray nonskid (gelcoat)
REGISTRY:	United States Coast Guard documented
DESIGNER:	Jeff Leishman
BUILDER:	Pacific Seacraft - Fullerton, CA USA
HULL MATERIAL:	Solid fiberglass
DISPLACEMENT:	50,000 LBS. 22.68 MT
BALLAST:	4,000 LBS. 1.82 MT
SPEED:	Cruise 7.0 knots @1700 RPM. Top 8 knots @ 2100 RPM WOT=2400
LOA:	39'9" 12.12 M
LWL:	35'5" 10.79 M
BEAM:	14' 6" 4.42 M
DRAFT:	5'6" 1.7 M
AIR DRAFT:	Approximately 32' 9.75 M with mast up. Note: Mast has tabernacle on base, air draft profile can be lowered to 18' 5.49 M
AB RATIO	2.3:1
DL RATIO	380
CP - PRISMATIC COEFFICIENT	0.60
ENGINE	Lugger model L668D 105 BHP (Hours~ 3,395 December 2020) Twin Disc 3.0:1 transmission
PROPELLER / SHAFT	2" stainless steel shaft 4 blade bronze propeller
MAIN EXHAUST:	Keel cooled, dry exhaust
WING ENGINE:	Yanmar model 3GM30FV 24 BHP, Kanzaki KM3V-drive transmission (replaced 2014) (Hours ~110 December 2020)
THRUSTER:	Side Power 8 HP electric bow thruster (Q-Prop upgrade kit installed 2020)
STABILIZATION:	Naiad 174 Multisea II hydraulic active fin stabilizers (upgraded 2019)
ELECTRICAL:	60 Hertz – US style – 30-amp
SHORE POWER:	30-amp for house and 30-amp air con

Nordhavn 40 Sea Trek

GENERATOR:	Northern Lights 8kW generator with sound shield (~3,370 hours December 2020)
INVERTER/CHARGER:	Magnum 2812 MS Pure sine wave inverter/charger (3.0 - 3.9 kW rating)
BATTERIES:	Lifeline (5) AGM House Batteries and Start Batteries (New 2019)
INTERIOR LIGHTING:	Low voltage LED lighting upgraded
CLIMATE CONTROL:	Marine Air reverse cycle HVAC: 44,000 BTU (3) compressors (Saloon unit new 2019)
MACHINERY EQUIPMENT:	Reverso oil changer for main and generator Racor Duplex for main Walbro fuel transfer pump with Racor filter
WINDLASS:	Maxwell VC2200 vertical electric windlass with gypsy and capstan
GROUND TACKLE:	35 KG Buegel anchor with 400' 3/8" HT chain
MAST AND BOOM	Forespar mast and boom for dinghy with electric winch (new lines and cable 2018)
TENDER AND OUTBOARD:	Highfield CL310HY 10'5" aluminum hull, inflatable dinghy with seat and steering console 20HP Tohatsu outboard with electric start and tilt (All new July 2019)
NAV/COM BRANDS:	Simrad Raymarine Icom KVH OptiPlex
ENTERTAINMENT:	Entertainment cabinet in Saloon with Fusion Bluetooth compatible stereo (4) speakers and 24" Samsung flat screen TV (All new 2018) Master flat screen television
STATEROOMS:	(2) staterooms: Owner forward, Guest to port
BEDDING:	Centerline queen (Owner) forward with custom Zeno mattress (2020) (2) Bunk beds in port guest stateroom Pilothouse watch berth
HEAD:	One: Raritan Marine Elegance freshwater toilet (electric freshwater)
SHOWERS:	Two: Stand up in head with door Cockpit shower
LAUNDRY:	Splendide model WD2100XC combo washer/dryer, vented
GALLEY:	(4) drawers (all new 2018) Vitrefrigo 110V/12V refrigerator/freezer Note: freezer is 110V with ice maker Seaward Princess three-burner propane stove and oven with broiler GE Profile microwave oven with exhaust fan Broan 1055 trash compactor
INTERIOR WOOD:	Light Teak
INTERIOR COUNTERS:	Corian counters
INTERIOR UPHOLSTERY:	Ultraleather
INTERIOR FLOORING:	Teak and Holly hardwood Berber carpet in Saloon/Owners and Guest suites Lonseal in Pilothouse and Galley
BILGE PUMPS:	Two (2) Rule electric bilge pumps (1) Edson manual
TANKAGE: (approx.)	
FUEL:	920 gallons 3,482 liters (Two fiberglass tanks)
HOLDING BLACK:	68 gallons 257.5 liters (One fiberglass tank)
FRESH WATER:	220 gallons 833 liters (One fiberglass, Two plastic tanks)

Nordhavn 40 Sea Trek

SAFETY:	Fireboy engine room fire suppression system (serviced 2019) USCG safety package EPIRB (new 2018) Viking RescYou Pro 4-person offshore life raft Engine room high water bilge alarm
PHOTO DATE:	Most photos taken July 2020
Note: All information is believed accurate but should be verified.	

Sea Trek is a full displacement long range trawler that has excellent equipment and has been cared for by fastidious owners. They have had their hands on every system and upgraded a vast inventory of equipment. She is stabilized, climate controlled and is ready to take off to explore. She is a proven passage maker (sister ships have crossed oceans non-stop and the builder took a Nordhavn 40 around the world in 2001). She was built by Pacific Seacraft in California. Made in the U.S.A.

Detailed maintenance records confirming pride of ownership are available for review by request*. All manuals and logbook have also been digitized for easy reference.

You can read all about the cruising accomplishments of the Nordhavn 40 online and by studying magazine reviews and owner blogs. Most of the detailed photos of **Sea Trek** were taken in July 2020 (many more images are available by request- [contact the listing broker*](#)).



<https://youtu.be/oYbBj4lBBq8>

Nordhavn 40 Sea Trek



For additional information please visit Sea Trek's website, www.Nordhavn40forsale.com

Exclusions: Potential purchasers should assume that items on the vessel at the time of viewing, but not specifically listed on this sheet, are not included with the sale of the yacht. These specifications are believed to be true and correct but cannot be guaranteed. Items excluded include, but are not limited to Paintings, tools, handheld nav gear and binoculars. Owner's personal effects and clothing will be removed prior to closing.

Disclaimer: Jeff Merrill Yacht Sales, Inc. presents the details of this vessel in good faith but cannot guarantee or warrant the accuracy of this information nor guarantee or warrant the condition of the vessel. Buyers should instruct their agents and their surveyors to investigate all details the buyers desire validated. This vessel is offered subject to prior sale, price change, or withdrawal without notice.

***OWNER COMMENTS:** Details of Sea Trek Insurance Claim - 2018

*In September 2018, **Sea Trek** was on a mooring ball in Beaufort, SC at the Beaufort Downtown Marina. Unfortunately, given the tides/currents and opposing wind, the shackle on the mooring ball failed to rotate properly. This caused the mooring ball to submerge underneath Sea Trek resulting in the mooring line becoming entangled in the stabilizer fins. In the process of trying to remedy the situation, a line had to be cut to release Sea Trek from the mooring. Unbeknownst to us, a line wedged between the stabilizer and the hull which then wrapped around the prop and shaft. When the main engine was engaged, the line that was wrapped around the shaft caused a sudden stop which impacted the engine mounts.*

Jeff Merrill Yacht Sales, Inc. © 2021 All Rights Reserved www.JMYS.com

Nordhavn 40 Sea Trek

Repairs were performed at the highly regarded shipyard, Thunderbolt Marine Inc. in Savannah, Georgia. Specific repairs related to the incident included new engine mounts. However, in addition to that and, out of an abundance of caution, we chose to replace the entire main gear system which included a new transmission with an upgrade to include a mechanical pressure gauge as well as the transmission oil cooler. We also had both stabilizer fins pulled and rebuilt to factory specifications.

We have used the boat over 1,090 engine hours (as of July 27, 2020) and over 7,000 nautical miles since then (a large percentage of that was offshore), with no issues arising from this incident.

*This unhappy event actually turned into a blessing in disguise while we paused our adventure while **Sea Trek** was being repaired to do a major refit of almost every major system including the installation of a new comprehensive electronics/navigation package (Simrad multi-function displays, radar, KVH LTE, etc.), upgraded the inverter/charger, the addition of a 35- 40 GPH watermaker, 760 watt solar panels system with Victron and LC components. Plus, a Viking Rescyou Pro Offshore life raft, replaced and upgraded all batteries, new refrigerator and freezer, new fresh water electronic controlled head and much more.*

Brokerage: JMYS is a US based (licensed and bonded yacht brokerage in California, Florida and Washington) with an international emphasis specializing in ocean capable trawlers and recreational tugs. Our brokers are experienced boaters, most are trawler owner/operators with thousands of hours and miles at sea. We treat our clients with respect, we are responsive and not pushy. Our focus is to become your loyal advocate, always looking out for your best interests. The team at JMYS has extensive trawler and motor yacht product knowledge and our skills are available for coaching after the sale has concluded.

Co-Brokerage: Fellow yacht broker association members: **Sea Trek** is available for Co-Brokerage.

Nordhavn 40 Sea Trek

***Listing broker. Jeff Merrill, CPYB** (Certified Professional Yacht Broker) has extensive product knowledge of the trawler market plus intimate knowledge of the Nordhavn 40. He helped clients build several new 40's (US and China) during his 14 years with PAE and continues to be active in the Nordhavn brokerage market. Jeff is a familiar face to YouTube viewers, is a regular presenter at TrawlerFest and is one of the instructors for Boaters University online courses.

This listing specification has been approved by the sellers for accuracy. The photos, images and descriptive content are copyrighted by JMYS and may not be copied or used without specific written permission. All inspections are by appointment only. Please contact listing broker, **Jeff Merrill, CPYB** by phone, text or email for additional information or to schedule your personal showing. Jeff is always available via Mobile (949) 355-4950 (call or text). You can send a detailed Email to: Jeff@JMYS.com.



Licensed and Bonded in California, Florida and Washington.

Skype: jeff.merrill | You Tube: Jeff Merrill Yachts | Twitter: @merrillyachts | LinkedIn: jeff.merrill
Facebook: Jeff Merrill Yacht Sales | Instagram: jeffmerrilljmys | Yacht Brokers Association of America |
International Yacht Brokers Association (Florida) | Northwest Yacht Brokers Association |
California Yacht Brokers Association – President 2015 and 2016

