

Snowbird 73 *True Love*



JMYS

Jeff Merrill Yacht Sales, Inc. | www.JMYS.com
4153 Country Club Drive | Long Beach, CA 90807

Florida address: Jeff Merrill Yacht Sales, Inc. | 2650 W State Road 84, Suite 103 | Ft. Lauderdale, FL 33312



TRUE LOVE

Price: \$869,000.00

Location: Deltaville, VA

Snowbird 73 *True Love*



Snowbird 73 - Talk Through Tour

<https://www.youtube.com/watch?v=cSZYquRSBFM>

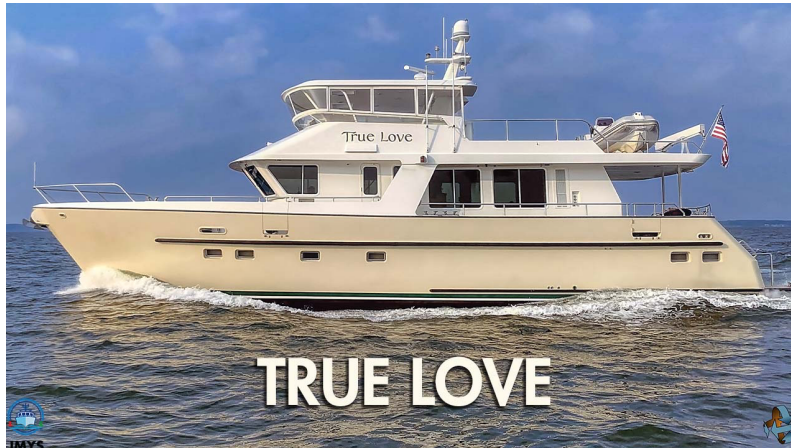

Snowbird 73 - 360 Trawler Spin:

https://www.youtube.com/watch?v=VqB6_Exhqfo

INTRODUCTION:

True Love is a performance semi-displacement trawler motor yacht that will appeal to discriminating buyers who may also be considering comparable quality series-built brands such as Fleming, Marlow, Offshore, Hampton, Ocean Alexander, and Outer Reef.

Improvements and upgrades completed in 2023 include:

- Replace HVAC / chiller system x 2
CTM Model CW-60HS, 60,000 btu
- New Miele clothes washer WXD160 WCS USA
- New Miele clothes dryer TXD160WP USA
- New air handler in aft cabin
- New refrigerator in galley - U-Line 24" 2000 series stainless steel
- New refrigerator on aft deck U-2074RB-00
- Replaced mirror ceiling in owner head

Snowbird 73 *True Love*

Created out of custom aluminum alloy, she is an outstanding island hopper and coastal cruiser. Offered for sale by her second owners, **True Love** represents a unique opportunity for an experienced cruiser who can appreciate the outstanding value she represents. It may seem difficult to establish value for a one-of-a-kind original, but one factual measure is the price she cost to build new, which was over six million dollars in 2005!

The first owners were an experienced cruising couple who owned several sailboats and purchased two Grand Banks trawlers before deciding to order one final yacht that would satisfy their desires for the ideal cruising boat. It had to be appealing, practical and above all, easy to operate and maintain. They studied the trawler models marketed by the leading yacht builders but could not find anything suitable. They came to the realization that a stock boat would not work. They were in the fortunate position to afford a custom new build which ended up being their best solution. They engaged renowned naval architect, Gregory Marshall, to work out the profile and layout that they wanted. With designs completed, they interviewed several builders in Canada (their home country) before selecting Park Isle Marine in British Columbia for construction.

For the size and performance they were looking for, it was determined that aluminum alloy construction would give them the strength and weight they needed. Their boat savvy and marine trade experienced son was hired as project manager to oversee his parents' ambitious goal. A very positive collaborative effort was commenced in 2004.

Every aspect of the boat was thoroughly researched with the goal of achieving their "perfect floating home". The design was enhanced by creating a bill of materials that specified the best available, industry leading equipment. The launch was a huge success, a beautiful build completed with compliments and congratulations all around. Then the vessel was shipped to Florida for test trips and a Bahamas cruise. Unfortunately, one aspect was a huge disappointment. The original concept specified a diesel electric propulsion package which, unfortunately, was never able to meet the performance promises.

The final solution after many trial runs and conferences was to start over. Two Scania engines (branded Yanmar) were installed by Deltaville Boatyard in Virginia. The propulsion change meant a two-year delay in their ability to go out cruising and even though the build year is listed as 2005, the owners were not able to enjoy **True Love** (originally called **Retired Sailor III**) until 2010. After several years of very enjoyable cruising, they were satisfied and had accomplished their objectives successfully. With time catching up, they completed their boating adventures and decided to sell their beloved boat. She was listed for sale for three and a half million dollars in 2015.

The owners of Deltaville Boatyard were her custodians and were also granted cruising privileges, a win/win situation for remote ownership and ultimately an arrangement was made to transfer possession to the people who knew this boat the best.

Snowbird 73 *True Love*

Hours reported in September 2023 are:

Port main = 3,204

Starboard main = 3,203

30 kW Generator = 3,858

12 kW Generator = 6,010

True Love is best summarized in one word “innovative”. She boasts a collection of best-in-class features and equipment. A comprehensive list of these selections is included here to help you understand the thought and attention to detail that went into this project. Reading through this write up will acquaint you with the thinking and detail, along with the time and effort that defined this build. However, nothing will tell her story better than actually getting aboard to see for yourself.

MAIN DECK

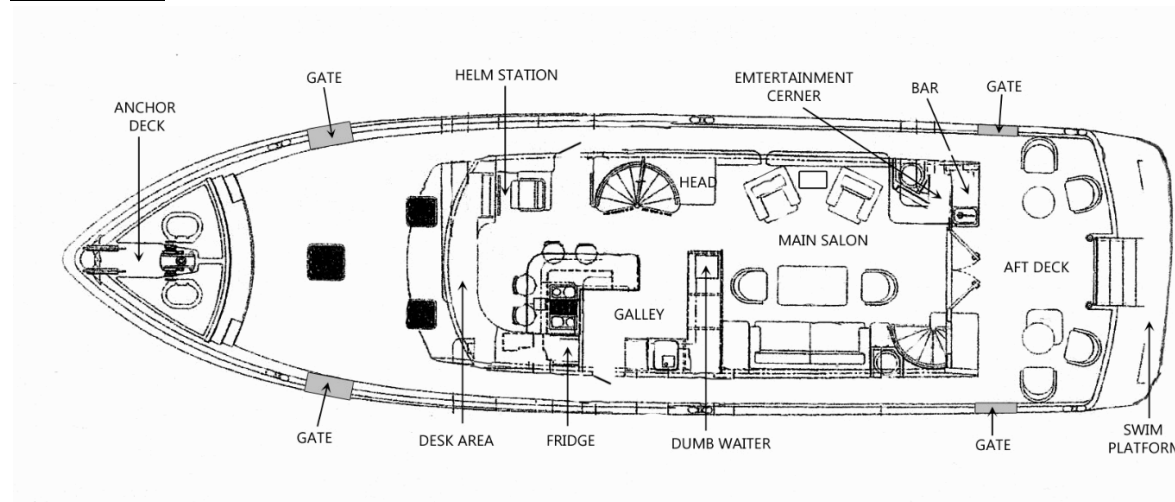

The large swim platform aft serves as the most convenient access from floating dock and by tender. You can also board the main deck (double walk around) of **True Love** using the Marquipt removable stairway through four gates in the side decks.

SWIM PLATFORM

A great first impression! You will appreciate her dock-sized swim platform for easy boarding. You can adjust the safety rail and detachable swim ladder. The large, hinged storage lockers are conveniently installed outboard in the transom where they secure fresh water hoses, shore power and assorted miscellaneous gear. The centerline promenade stairwell is wide with large steps that easily transition to the aft deck cockpit. The stairwell includes a hot and cold freshwater hand shower and has two opening port lights for the aft stateroom.

- Adjustable transom U-rail support
- Removable swim ladder
- Hinged storage lockers port and starboard for shore power and freshwater gear
- Hot and cold fresh water hand shower

Snowbird 73 *True Love*

- Marine 2000 decking
- UHMW rub railing for rugged protection

AFT DECK

True Love's covered aft deck is ideal for entertaining and provides an incredible view of your surroundings. You are five feet above the waterline which make this a very dry and secure boat. There are portable chairs and tables for relaxing as well as storage locker. There is a sink, ice maker and refrigerator as well as a sidebar beverage dispensing system. A safety gate is located at the top of the stairwell to fence in the cockpit and swings open for access to the swim platform. You can enter the saloon through the double French doors or go forward along either side deck. There are two boarding doors aft and moving along the side you will see engine room ventilation grills and fuel fill gauges.

- Icerette ice maker
- Uline bar fridge
- Sidebar beverage system
- Cupboard for glasses
- Hot and cold water in bar sink
- (2) stainless rod holders
- Moveable chairs and tables
- Hawse openings, line rollers and cleats
- Hinged aluminum gate aft to swim platform
- Deck boarding doors port and starboard
- Covered overhead

FOREDECK:

The foredeck was designed to provide a huge open space with high bulwarks and tall aluminum tubular railing for safety. The anchor deck is a raised stage with the windlass and chain lockers. The dual anchor well is angled forward to drain the mess from anchor wash down. There are two anchors ready to deploy with chain stoppers and cleats. The large deep chain lockers have a separate shelf aft for the Glendinning shore power retrievers and fresh water hoses. There are rollers and cleats for dock lines as well. Along the side decks are fender storage racks, cleats and freeing ports. The sole is durable Marine 2000 non-slip. Aft, below the reverse raked windows is a huge, hinged storage container for stowing lines and shore power attachments.

- Lofrans Titan B horizontal windlass with two outboard gypsies and a centerline top capstan includes foot buttons on deck and hand control.
- Bow rollers for both anchors
- (2) Delta Fast Set 110 lb. anchors
- Each anchor connected to 200' of G4 3/8" high test chain
- Painted Freeman hatches above both sides of the anchor locker
- Chain stoppers for anchors
- Built in deck rollers for fair leading dock lines

Snowbird 73 *True Love*

- Fresh water spigot
- Fender storage racks
- Freeing ports
- Two forward boarding gates
- (3) Lewmar hatches
- Large deck storage container
- Emergency ladder for forward stateroom
- Anchor wash down
- Shore power inlet connections with Glendinning power cord retriever
- Marine 2000 flooring

MAIN SALOON:

Entering the saloon from the raised aft deck through the water tight glass French doors you will be impressed with the inviting layout and wide-open vistas outboard providing a great sense of space. There are large opening windows, and the beautiful cherry wood is accented appropriately with warm colored ultra-suede wall covering. The cork flooring adds a practical and decorative touch that also has sound insulation advantages. The saloon was designed for both lounging and dining with a generous gathering area featuring a comfortable upholstered couch and matching arm chairs which are dogged down. There is an innovative high low coffee/dining table which can seat eight. An entertainment center with flat screen television is located in the aft starboard cabinetry with controls for the upper and main deck speakers.

There are two stairwells. The forward (starboard amidships) leads up to the flybridge and below to the owner stateroom, utility and third cabin. The aft stairwell leads down to the full beam guest stateroom and engine room.

- Three-person sofa
- (2) matching chairs
- Stand locker between chairs
- Picturesque opening windows with screens
- Adjustable dining table
- (4) folding captain's chairs stored under furniture
- Edge bound carpeting
- Cork flooring
- Phantom roller screens on deck doors
- Entertainment center – television and stereo

DAY HEAD

For convenience, forward on the starboard side of the saloon is a day head opposite the galley, aft of the forward stairs.

- Royal flush fresh water toilet
- Stainless steel sink
- Exhaust fan
- Grohe sink and shower fixtures

Snowbird 73 *True Love*

- Corian countertop
- Mirrored ceiling – laminate
- Frosted glass outboard for light and privacy

GALLEY:

Located forward along the port side deck there are two opposing L shaped Corian counters, with a spill lip all around, making this a marvelous area for preparing meals. The counter surface area is impressive. Four swivel chairs are positioned along the outside counter for dining. There are ample drawers below and lockers above. Below counter appliances include a microwave, sink and trash compactor. The four-burner electric cook top is divided by an electric BBQ with an exhaust hood above. One of the highlights is the custom designed dumbwaiter for easy delivery of food and drinks to the flybridge upper deck.

- Corian counters
- Cork flooring
- Uline bar size refrigerator with (2) refrigerated drawers below
- Miele electric four burner cook top with Barbeque in center
- Vent-a-hood above cook top
- Broan trash compactor
- Sharp microwave oven
- Deep storage drawers for pots and pans
- Double basin stainless steel sink
- Overhead lockers
- Side deck door with Phantom screen
- Dumbwaiter
- Galley equipment includes toaster oven, silverware, plates, glassware, table cloths, etc. will all remain onboard for the new owners
- (4) swivel bar chairs

LOWER HELM STATION AND DESK:

The design of the lower helm station was intended to keep the captain and guests connected during hours of cruising. The forward reverse raked windows provide excellent visibility ahead. This forward helm station includes a folding helm chair to starboard with a navigation console, thrusters and engine controls. Electrical breakers are concealed behind a locker door. An office like desk is to port with drawers and a printer. There is a wraparound counter behind the window for quick storage.

- A Desk
- Folding helm seat (serves as a table tray when folded forward)
- Stainless steel destroyer wheel
- Two single lever engine controls
- Engine and generator alarms

Jeff Merrill Yacht Sales, Inc. © 2023 All Rights Reserved. www.JMYS.com

Snowbird 73 *True Love*

- (2) Northern Light generator control panels
- ABT bow and stern thruster proportional controls
- Furuno chart plotter with radar – multi-purpose LCD display
- Simrad autopilot and rudder angle indicators
- Furuno depth display
- Electronics panel with breakers
- Eaton hydraulic pump emergency steering system
- Electric compass
- Windlass control
- Red overhead lights
- Engine controls
- Maretron system on display
- Windshield wipers with washers
- Running lights and anchor light control panel
- Delta T override
- VHF
- Watermaker panel
- Electronic breakers panel
- Fireboy panel
- Canon Printer on sliding shelf
- Drawers and lockers
- Side windows open
- Side deck door to starboard with Phantom screen

LOWER DECK

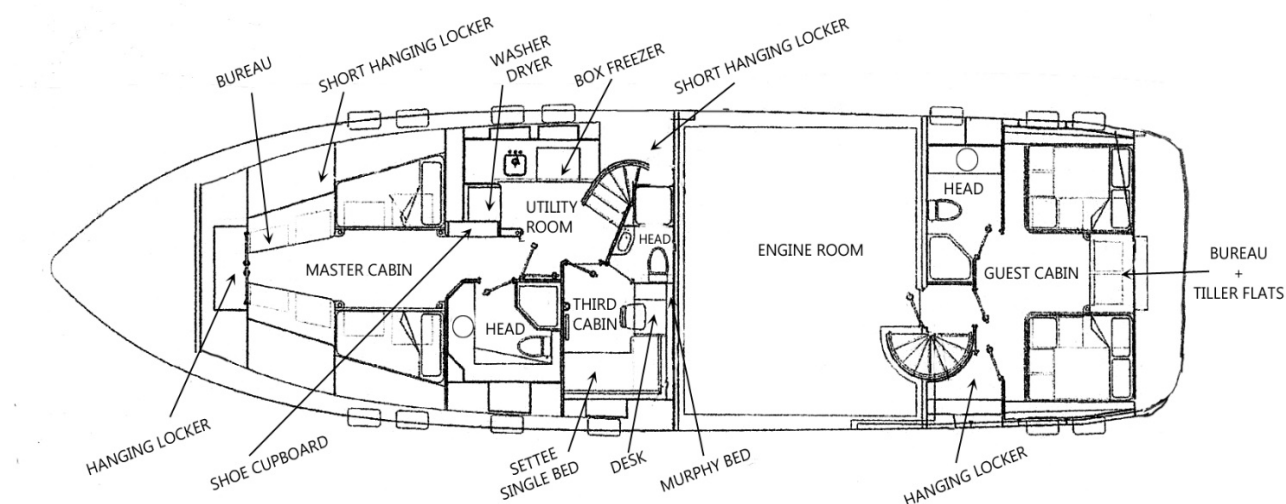

Snowbird 73 *True Love*

The forward lower-level deck begins with the Utility room at the base of the stairs that begin at the saloon / galley intersection. Across to port is the third cabin (office/den) and the owners' stateroom is located towards the bow.

UTILITY/LAUNDRY ROOM

The forward stairs lead down to a large utility room that connects to the port guest cabin and owner stateroom forward. There is a covered sink, a top loading chest freezer and a Miele clothes washer and dryer. There are sliding locker doors outboard for additional storage. Opening portlights provide additional ventilation. The stairs lift to reveal the central vacuum canister, a safe and extra storage space.

- Miele clothes washing machine (Replaced January 2023)
- Miele clothes drying machine (Replaced January 2023)
- Large sink with Corian split covers
- 5 cu. ft Woods deep chest freezer
- Central vacuum storage of hoses
- Safe
- Opening port lights
- Small hanging locker
- Cupboard with owners and ships manuals
- Cork flooring

FORWARD PORT STATEROOM

This stateroom has a single bed size settee and a hinged single Murphy bed in the bulkhead with a small desk with drawers below. Primarily used as a den with couch and desk it has the convenience of quickly converting to a comfortable cabin. There are storage lockers on the outboard wall and hidden ones behind the settee cushions. The head and shower are ensuite. This cabin would make an excellent captain's quarters.

- Large hanging locker and drawers
- Opening port light
- Hella fan
- Flat screen monitor with a DVD player
- Grohe sink and shower fixtures – in head
- Cast marble poly-resin countertop - head
- Mirrored ceiling – laminate –in head

OWNER STATEROOM- FORWARD

The original owners chose the area below the foredeck as their stateroom because of the extra light from the three hatches and the ability to hear the motion of the bow. Closing the door from the Utility landing, this is a spacious private stateroom with ensuite head and shower. For sleeping there are two three quarter size beds outboard. A wide centerline walkway is covered with a rug. The cork flooring has an innovative locking system that covers several large storage compartments in the bilge area, containing plastic bins. The bins hold extensive spare parts and

Snowbird 73 *True Love*

tools with an estimated replacement value of \$10,000.00. There is a complete inventory sheet of contents. There is a floor to ceiling shoe locker to starboard as you enter. There are his and hers hanging lockers with a handy lowering bar system for convenient hanging of short items above the bureaus, as well as a full-length hanging locker.

- Full bedding including sheets, bedcovers, pillows, etc.
- Edge bound carpet
- Large hanging lockers
- (3) Lewmar hatches with screens and black out
- Lowering hanging bar system
- (4) Opening port lights – two per side
- Black out curtains on port lights
- Black out curtains and screens on hatches
- (2) Hella wall fans

OWNER HEAD:

This is a convenient and private head with shower and sink. It is paneled with cherry wood and wall coverings and includes a mirrored medicine cabinet and lockers.

- Grohe fixtures in sink and shower
- Soap dispenser
- Lockers and drawers
- Mirrored medicine cabinet
- Royal Flush fresh water toilet
- Exhaust fan
- Opening port light
- Hella wall fan
- Excellent overhead LED lighting
- Grohe sink and shower fixtures
- Cast marble poly-resin countertop
- Mirrored ceiling - laminate

The aft lower-level deck has a curved stairway from the aft port corner of the saloon. The landing at the base of the stairs allows you to go forward to the engine room or aft to the full beam VIP guest stateroom.

VIP GUEST STATEROOM – AFT:

This is a unique layout that was a special requirement for the original owners who loved family style cruising. Located underneath the aft deck is a true full beam stateroom with large queen-sized beds port and starboard and an ensuite shower and head. Between the beds and aft is the bureau with a large countertop and several drawers underneath. The bureau cabinetry is easily removed to allow access to the watertight “Tiller Flats” area and the steering gear.

- Queen sized berths outboard port and starboard
- Large hanging locker with mirror

Snowbird 73 *True Love*

- Custom fitted designer bedspread and pillows
- Area carpet
- Large bureau with drawers
- Emergency escape hatch to aft deck
- (4) Opening port lights outboard with black out blinds
- (2) Hella wall fans
- Dimming overhead LED lighting
- Mood lighting behind valances
- Watertight Freeman hatch access to “Tiller Flats”

TILLER FLATS:

The “flats” are located behind the removable bureau in the guest stateroom. This is where all the rudder steering gear and stern thruster equipment is serviced.

- Jastram steering helm cylinders
- Accusteer dual autopilot pumps
- Emergency tiller
- Tides seals on rudder bearings
- Stern thruster
- 2,000 pounds of ballast - secured
- Steering bypass system

GUEST HEAD

This head is spacious with excellent lighting.

- Shower
- Mirrored medicine cabinet
- Royal Flush toilet
- Ceiling exhaust fan
- Hella wall fan
- Opening port light
- LED overhead lighting
- Grohe sink and shower fixtures
- Cast marble poly-resin countertop
- Mirrored ceiling – laminate

ENGINE ROOM:

This “stand up” engine room is something you would hope to find on a much larger yacht. The importance of installing reliable gear that is easy to access and service has always been the priority. You enter through a Diamond Sea Glaze door with viewing window. The engine room is easy to move around in and has railing inboard of the engines for hand support. The sure-footed flooring locks in place. The centerline walk way enables instant access forward to the stabilizers and watermaker. The two generators are installed aft. There are three fuel tanks, two outboard and one beneath the sole. Aft is an electrical panel with breakers and spare fuses.

Snowbird 73 *True Love*

Each raw water system has a separate through hull for intake. A unique discharge water sea chest returns overboard. The Delta T ventilation system moves a massive amount of air. For safety there is a fire suppression bottle. There is even an emergency escape hatch with built-in steps, and there is also a signal alert red light on flybridge to notify crew if needed.

- (2) Scania 720 HP main engines (branded Yanmar)
- Stainless rails around engines
- AquaDrive thrust bearings
- Tides shaft seals
- Northern Lights 12 kW generator
- Northern Lights 30 kW generator
- Reverso fuel polishing, priming and transfer system
- Reverso 210 GPH Separ pump
- Algae X fuel conditioner
- Reverso oil change system
- Delta T engine room ventilation system
- Three aluminum fuel tanks
- Buell air compressor
- TRAC active fin stabilizers
- TRAC steering
- TRAC bow and stern thruster
- Odyssey AGM batteries on sliding shelves
- Electrical panel with breakers and fuses
- Maretron engine performance displays
- Fireboy fire suppression with engine shutdown and manual release
- Cruisair chilled water air conditioning
- Village Marine PWV 1200 gallon per day 220 V AC watermaker

- Locked in and easily removable flooring
- Engine room emergency light
- Engine room emergency escape hatch
- Small work bench with vise
- 2 Dual Racor fuel filters with petcock drains
- Video monitoring to the Furuno
- Red signal alert light

UPPER DECK

Snowbird 73 *True Love*

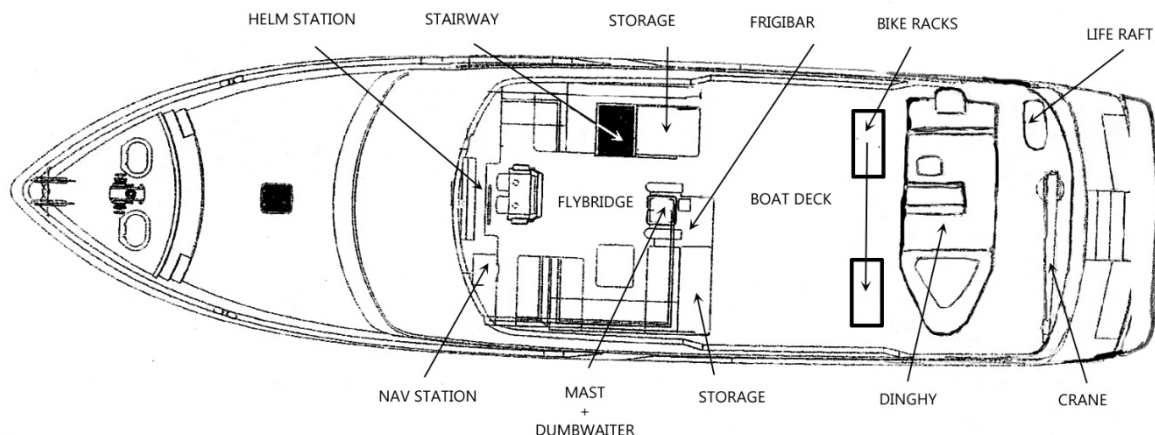

FLYBRIDGE

The flybridge stairs from the main deck level below lead to a sliding door with screen, which secures the interior living areas from the upper deck. This top deck is all on one level with the area forward of the mast enclosed with clear Lexan panels. The side panels are mounted on separate tracks allowing them to be opened independently or they can be removed and stored in vinyl bags. This area has proven to be the most popular area of the boat, whether underway or at anchor and can be temperature controlled. Centered forward is the helm station which has all the necessary nav /com electronics easily reached from the two-seater Stidd helm bench. Below the console is storage space for life jackets etc. and there is a movable chart box on top. The crew enjoys the forward-facing seating port and starboard. For meals there is a U-shaped seating area with a drop-leaf table. The aluminum hardtop has opening hatches giving extra lighting and ventilation. The flybridge and boat deck are divided by the mast which has a clever lowering apparatus for powering under low bridges and easy access to the mast head electronics. One of the highlights is the built-in dumbwaiter from the galley which allows the easy delivery of food and drinks between levels.

The area between the flybridge and boat deck is designed as open space for sunning, exercising or just relaxing. There are legacy bike mounts (no bicycles included). Plasteak flooring provides a finished and practical surface.

The boat deck stores the Apex 15' RIB mounted athwartships and the Steelhead crane, which can launch off the stern or either side.

- Stidd bench seat at helm
- Stainless helm
- Engine controls
- Navigation and communication instruments
- TRAC stabilizer controls
- Bow and stern thruster controls

Snowbird 73 *True Love*

- Instruments and controls for the main engines
- Forward bench seats port and starboard
- U - shaped settee
- Aluminum hardtop covering
- (2) Weaver Maxwell Offshore hatches in overhead hard top
- Enclosed area with sliding Lexan panels
- Heat and air conditioning
- Moveable chart box
- Adjustable signal mast lowers for bridge clearance
- Remote windlass control
- Dumbwaiter
- Custom fabricated fiberglass signal mast with nav/com antennas.
- Speco Technologies horn
- Remote controlled spot light
- Plasteak decking
- Coast Guard required equipment, flares, lifejackets etc.
- Viking 6 UKLS – 6-man life raft
- Note: Exercise equipment shown in photos and video are not included in this sale

BOAT DECK:

The boat deck area is surrounded by safety railings with lots of open deck space for reclining and enjoying the sun and fresh air. There are two large storage lockers, the starboard one contains a wash-down hose and there is a handy low box fridge / freezer alongside. The tender is mounted across the beam and can be launched off the transom or to either side with the Steelhead crane aft.

- 15' Apex RIB (14'6"/4.42M)
- Yamaha 50 HP outboard
- Steelhead CT900 – 900 lb. crane
- (2) storage lockers
- Frigobar electric chest freezer
- Wash-down hose

EXTERIOR

- Marine 2000 flooring is used on main deck and swim platform surfaces
- Boarding gates on bow and stern, port, starboard and swim platform stairway
- Aluminum exterior handrails surround the deck
- Full beam swim platform
- 1 moveable staple on swim platform
- Cleats on swim platform
- Transom storage lockers – port and starboard for shore power and shore water
- Fortress anchor storage in transom locker
- Spot Free water filtration system

Jeff Merrill Yacht Sales, Inc. © 2023 All Rights Reserved. www.JMYS.com

Snowbird 73 *True Love*

- Shore water intake system with filters
- Hoseowner fresh water hoses forward and aft
- Hot and cold freshwater shower in swim platform steps
- Boarding gate at top of stairs to aft deck
- Aft deck has rollers and cleats in aft lower corners
- 4 Chairs and 2 tables on aft deck
- Storage locker to port on aft deck
- Icer-ette ice maker and refrigerator with a cupboard above for glasses
- Sidebar beverage system
- Wide side decks port and starboard – covered
- Boat hook storage
- Retractable railing, mid ship port and starboard to access dock cleats
- Recessed life rings in outboard gunwales (port and starboard)
- Large hawsers
- Fender storage holders
- Lifesling
- Raised anchor platform foredeck
- Shore power connections forward and aft with Glendinning's
- Outlet for connection to dockside Cable TV and Telephone
- Lofrans Titan B horizontal windlass with two outboard gypsies.
- Centerline top capstan with foot and hand controls
- Bow rollers for two anchors
- Two Delta Fast Set 110 lb. anchors
- Each anchor connected to 200' of G4 3/8" high test chain
- Chain stoppers for anchors
- Built in deck rollers for fair leading dock lines
- Anchor snubber bridle
- Two painted Freeman hatches for access to the chain locker
- Burgee staff on bow pulpit
- 3 Lewmar hatches in foredeck
- Large storage box on foredeck
- Escape ladder built into storage box over hatch
- Recessed boarding ladder storage on port side
- Emergency escape hatch from engine room on port side deck
- Built in diesel fuel tank fills on house with analog gauges and venting
- Fenders and dock lines
- Stainless steel flagpole with Canadian Ensign
- Diamond Sea Glaze doors and windows
- All exterior doors have Phantom roller screens
- Hand held spotlight

Snowbird 73 *True Love*

MACHINERY FEATURES AND EQUIPMENT:

- Twin Scania 6SY-STP 720 HP engines (Yanmar) with ZF transmissions 2.64:1 reduction
- DeAngelo marine exhaust with Borel engine exhaust alarms and Centek water lift mufflers
- Aquamet 22, 3" propeller shafts
- Tides Marine drip less shaft seals
- Twin screw 5 blade 36" x 28" bronze propellers
- Spurs line cutters on both main propeller shafts
- Spare 4 blade propellers
- Sea chest for outlet water discharge
- Miller-Leaman seawater strainers
- TCI seacock's - flanged ball valve
- Sea chest raw water discharge manifold
- Delta T engine room ventilation system
- 12 kW Northern Lights generator
- 30 kW Northern Lights generator
- Reverso fuel polishing pump and manifold with control panel
- Dual Racor fuel filters
- (2) Outback VFX 3524 3500W Inverters
- Odyssey AGM batteries on sliding shelves in engine room
- Glendinning cable owner shore cord retrievers fore and aft
- TRAC 370 active fin stabilizers
- ABT TRAC 12 hydraulic bow and stern thrusters
- ABT hydraulic steering reservoir
- Accusteer helm pumps
- Tides seals on rudder posts
- Village Marine PWV 1200 gallon per day 220 V AC watermaker
- Torrid MVS 40-gallon hot water heater
- (2) Mach 5 freshwater pumps
- Trojan Technologies UV water sterilizer
- Reverso oil change system
- Fireboy fire suppression in engine room
- Lofrans Titan dual rode horizontal 24V windlass
- 2 Delta deep set 110 lb. galvanized anchors
- Steelhead CT900 crane
- Apex 15' RIB tender with Yamaha 50 HP outboard
- Charles 12 KVA isolation transformers for fore and aft 50 amp power feeds
- Speco horn
- Maretron systems monitoring
- Lonseal floor panels secured and easily removable for access

Snowbird 73 *True Love*

- Wheelhouse Technologies ships maintenance program, regularly updated
- Diagrams, manuals
- Huge assortment of spare parts (cataloged) and stored in bin under soles in bilge area
- Detailed log of receipts documenting expenses available from owner
- Marquipt boarding stairs

HOUSEHOLD CONVENIENCES:

- Village Marine PWV 1200 gallon per day 220 V AC watermaker
- Royal Flush freshwater toilets
- Cyclovac – central vacuum
- Dometic – Cruisair chilled water air conditioning
- Miele W1113 clothes washer
- Miele T1313 clothes dryer
- Miele KM 400 series four burner electric cook top with barbeque grill
- Vent-a-hood above stove top
- Uline full size refrigerator with two refrigerator drawers below
- Woods 5 cu ft. chest freezer
- Wacco bar fridge and Icer-ette ice maker
- Frigibar refrigerator/freezer chest
- Sharp microwave oven
- Toaster oven
- Spot Owner freshwater softeners
- Insinkerator garbage disposal
- Slide out trash bin
- Broan trash compactor
- Sidebar beverage system
- Soap dispensers at all sinks
- Fiddles on many surfaces
- Metal glides on drawers
- Magnetic catches on doors
- Phantom screens on outside doors
- Dumbwaiter in galley that ascends to flybridge
- Hot water circulation pump
- Flat screen TV, CD player, monitor, iPod attachment
- Speakers in ceiling on main, aft and upper deck
- Strip/mood lighting behind all valances

ELECTRICAL SYSTEMS:

Jeff Merrill Yacht Sales, Inc. © 2023 All Rights Reserved. www.JMYS.com

Snowbird 73 *True Love*

True Love was built to cruise in US and Bahamian waters and is set up with a very well-engineered electrical system.

- Dual 50A/240V shore power cords deployed from stern by Glendinning retrieval systems
- Dual 50A/240V shore power cords deployed from bow by Glendinning retrieval systems
- Both 50A/240V power feeds are routed through Charles isolation transformers
- Dual Outback inverter/charger units
- Northern Lights 12 kW generator
- Northern Lights 30 kW generator
- Odyssey AGM batteries – total of 1,254 Amp hours
- Paneltronics breaker panels
- DC distribution box
- Individual battery isolation switches
- Main AC and DC distribution and control panels
- Sub DC distribution and control panel in pilot house
- Bonding system and zincs
- Extensive lighting system on deck and through interior – mostly upgraded to LED
- Aqua Signal mast spotlight
- Golight Stryker Spotlight

ELECTRONICS

The amount of navigation, communication and entertainment electronics supplied throughout **True Love** is astounding. She is well integrated with excellent electronics for reliable 'away from land' travel.

- Compasses: - Ritchie floating on flybridge and KVH digital on lower helm.
- VHF radios: - Icom IC-M604 at the upper and lower stations
- Microphones: - Icom HM-157 (Command mic) remote in the flybridge and connected to the lower station VHF.
- Autopilots: - Simrad AP25 on flybridge and lower helm
- Depth sounders: - Furuno, F1-50 Multi at the upper and lower helms.
- GPS: - Via Furuno display equipment and Maretron GPS200 antenna-receiver.
- GPS: - Hand held Garmin Mariner in flybridge console locker
- Radar: -Via multi-function display and open array on signal mast.
- Fish finders: - Furuno DFF1on flybridge with Simrad combo transducer and MB-1100 matching equipment.
- Weather Station: - Furuno PB150 on the flybridge.
- Multi-function instruments: - Furuno MU-120C at lower helm and MU-170C on flybridge
- Furuno Software Installed: - NavNet, MaxSea navigation, Network sounder DFF1, PG 500 Heading sensor, Radar sensor, Sirius satellite weather, plus BBWX1 receiver

Jeff Merrill Yacht Sales, Inc. © 2023 All Rights Reserved. www.JMYS.com

Snowbird 73 *True Love*

- Control units: - Furuno MCU001 at the upper and lower helm
- Processor Unit: - Furuno MPU001 at the upper flybridge
- Heading sensor: - Furuno PG 500
- AIS system: - Furuno FA-59 Class B transponder.
- Black Box: - Furuno MFDBB on flybridge.
- Radar sensor: - Furuno DRS6A on flybridge.
- Additional monitors: - Starboard side on flybridge
- Antennas: - Airmar weather, VHF, Maretron GPS, Trac phone and vision, AIS-GPA-017. Mounted outboard of flybridge and on signal mast.
- Video Monitoring: - Axis Network Cameras. (2) 211M in engine room, (1) 215 PTZ on aft deck. Closed circuit television
- Phone System: - Charles Industries C-Phone communications system 9404 model; Panasonic KX-Tg6411T cordless phone stations - office, saloon, 3 cabins, hard wired – engine room and flybridge; Telular SX5T wireless terminal,
- Internet: - access via TracPhone; Thrane & Thrane Fleet 33 Inmarsat.
- Ethernet Hub: - Furuno HUV-101 on the flybridge.
- Internet switch: -Netgear EN104TP; in entertainment cabinet.
- Printer: - Canon MG5120 in lower helm desk
- Engine and systems monitoring: - Maretron DSM250 displays at flybridge, lower helm, and OEM displays in engine room.
- Headsets: - (2) pair Tech Link radio headsets
- Electronic chart chip

ENTERTAINMENT ELECTRONICS:

- AV Surround receiver: - Denon AVR-2106.
- Speaker control: - Russound SDB series speaker selector.
- Direct TV: - HD Receiver.
- Television: - Sony, flat screen in entertainment cent
- Denon receiver and DVD, plus Direct TV
- Television antennas: - TracVision 4 plus MultiSat control.
- Television/VCR/DVD player(s): - Clarion VS755 digital media player in 3rd cabin
- DVD Video Player and Monitor: - Denon DVD-1720 in third cabin
- Speakers: - in saloon, galley, aft deck and flybridge headliners

PLUMBING SYSTEMS

True Love includes very well thought out fresh water, black water and gray water plumbing. Redundancy is built into all three systems. All dock water is pre-filtered.

- Village Marine PWV 1200 gallon per day 220 V AC watermaker

Jeff Merrill Yacht Sales, Inc. © 2023 All Rights Reserved. www.JMYS.com

Snowbird 73 *True Love*

- Torrid MVS 40-gallon hot water heater
- (2) Mach 5 - fresh water pumps
- Trojan Technologies UV water sterilizer
- (4) Royal Flush Neo classic freshwater toilets
- Dometic black water vent filters
- Headhunter gray and black water discharge pumps
- Insinkerator garbage disposal
- Spot Free dock water inlet filter
- Liquatech "whole house" water filter
- (3) Hoseowner fresh water spooled hoses - fore, aft and upper deck locker
- Hot and cold fresh water shower at swim platform steps
- Select valve for dock water or boat water wash down
- Accumulator tank for pressure smoothing.
- Miele clothes washer
- Extra freshwater taps for fly bridge and foredeck
- Pilothouse window washer/wipers
- Electric overboard pump for black and gray water tanks
- Black and gray have deck plate pump outs for shore evacuation
- Bilge pumps – (2) in engine room, (1) forward owner and (1) aft stateroom
- Johnson bilge pumps
- Rule bilge pumps
- Hot water circulation pump

MISCELLANEOUS FEATURES AND SAFETY EQUIPMENT:

- All Coast Guard required equipment
- Emergency signal flares
- Life jackets
- Viking 6UKLS six-man life raft
- Fireboy fire protection system with automatic shutdown in engine room
- Ships manuals with all systems and drawings
- Extensive spare parts and tool inventory, estimated replacement value \$10,000+

TANKAGE:

Fuel = 1,710 gallons | 6,473 liters

Fresh water = 212 gallons | 802.5 liters

Black water = 309 gallons | 1,170 liters

Gray water = 251 gallons | 95 liters

Snowbird 73 *True Love*

*Continual maintenance work to care for and refresh **True Love** has been ongoing at her home base at the Deltaville Boatyard. Every effort has been made to keep her clean, reliable, and ready to continue cruising.*

SOME HISTORY:

True Love was delivered to her original owners in May 2006 in British Columbia, Canada. After initial sea trials, shake downs and commissioning in the San Juan Islands she was transported as cargo to Fort Lauderdale, FL for extensive review of the diesel electric propulsion. After trials, it was determined that the diesel electric package was not going to live up to the expectations and it was agreed to move her north to Virginia for an extensive retrofit at one of the best boat yards in the US, Deltaville Boatyard. The owner of the yard, Keith Ruse, took on the project with great care and the owners monitored the progress which ultimately took 2 years to complete. Marine industry expert, Steve D'Antonio, was hired as a consultant for the project and helped oversee the transition.

In April of 2010 the new and improved **Retired Sailor III** was re-launched and finally began her cruising career. In her early active years, she cruised well over 10,000 miles travelling from Virginia to the Bahamas and Turks. She is an incredible trawler and many enjoyable family cruises have taken place in this veritable "floating home away from home".

Continual upgrades in systems and equipment on top of the original build selections make **True Love** an outstanding purchase for anyone looking to own the ultimate coastal cruiser. If it is your desire to see the world and travel along coastal waters in style and comfort please review this very detailed listing to learn more about **True Love**. She is not only exceptionally outfitted, but she represents an incredible value when you consider that she cost over \$6,000,000.00 to build and is now fully functional and truly shows like a lightly used, almost new boat due to her limited use despite the years that have passed since her original launch.

TESTIMONIAL

By Steve D'Antonio, Marine Consultant

*"I've had the pleasure of being involved with **Retired Sailor III** for the past seven years, having first gone aboard during her commissioning process in Victoria, BC. Since then, I've worked with the owners, Bev and Ann Collombin, consulting on and overseeing a variety of projects, repairs and upgrades, including the repower. Truly no expense has been spared in maintaining **Retired Sailor III** during my tenure with her. Only the finest, highest quality equipment has been used, all of which has been installed and maintained in keeping with the American Boat and Yacht Council's, as well as the equipment manufacturers', rigorous standards. I'm not one to exaggerate, which is why, when I say attention to detail in the initial build, as well as work carried out thereafter, is second to none, it represents the very highest praise. This is a fine vessel and one of my personal favorites."*

HULL CONSTRUCTION:

Most production trawlers marketed to the public take advantage of the simplicity of duplicating sister ships through the use of fiberglass construction. Provided the design is well founded and

Jeff Merrill Yacht Sales, Inc. © 2023 All Rights Reserved. www.JMYS.com

Snowbird 73 *True Love*

the tooling is well made, the builder can offer a series of hulls that are uniform in construction and the manufacturing process is more streamlined and faster to crank out boats. There is an argument to be made for building trawlers out of metal - with steel and aluminum being the preferred materials. For a full displacement yacht where weight is less critical, steel is more popular. **True Love** was constructed using aluminum alloy for better strength to weight ratios and to keep her lighter to gain more speed. The entire design was first computer modeled (at significant expense) and these precise dimensions enabled the aluminum to be cut to exact specifications then welded together. The initial frames were set up to develop a robust hull form.

CONSTRUCTION DETAILS AND FEATURES:

True Love is a three-level flush deck boat

- Lower Deck - Staterooms fore and aft of engine room.
- Main Deck – Saloon, galley forward, pilot station.
- Upper Deck - Enclosed flybridge forward and tender storage.
- Aluminum alloy hull construction with 3/8" plating below the waterline and 1/4" plating above over longitudinal and athwartship framing and stringers.
- Watertight bulkheads – anchor locker, forward engine room, aft engine room and tiller flats.
- Galvanic protection with zinc anodes / bonding system
- Interior spray foam insulation to the waterline and under the decks.
- Hull faired then painted with Awlgrip Moon Dust
- Rub rails aluminum with UHMW rounded support edges
- 8-degree trim wedges on transom underbody
- Propeller pockets
- Plasteak flooring on upper deck
- Marine 2000 flooring on main deck
- Diamond Sea Glaze custom doors and windows
- Freeman watertight hatches
- Fiberglass covered, aluminum framed flybridge hard top with opening hatches
- Fiberglass signal mast with antennas, hinged for bridge clearance
- Interior joinery crafted from American cherry
- Barriga Natural Cork flooring throughout interior living spaces
- PYI Floor anchors for cork sole latches
- Majilite Prestige shell color headliners
- Corian Mojave counters in galley and Corian Aurora in Utility room
- Cast marble poly-resin counters in head and showers
- Ultra-suede on outboard walls
- Grohe sink and shower fixtures
- Phantom screens for outside doors

Snowbird 73 *True Love*

- LED overhead lighting throughout with dimmers.
- Mood strip lighting behind all valances



LISTING BROKERS COMMENTS:

True Love is a stellar example of an ideal coastal cruising trawler. This is quite simply an extraordinary yacht. Her two owners have contributed their expertise and care and enjoyed many years of trouble-free cruising. She is a wonderful live aboard for months on end.

Her active use and regular maintenance regimen have kept her in Bristol condition. **True Love** is truly at home in stormy offshore weather and equally comfortable plying calm coastal waters on shore. Throughout her life, there has never been a limitation due to budget. She has the coastal cruising experience to take you and your family safely to numerous ports of call. If you are a discriminating buyer looking for an innovative yacht that includes the necessities of home and you have longed to own a unique exceptionally designed and outfitted one-of-a-kind motor yacht and, in a position to take off for adventures, you deserve a closer look – let's get you aboard!

True Love is truly "ready to cruise" and will continue providing her new owners the special luxury of comfortable cruising with safety and redundancy.

Please contact listing agent, Jeff Merrill, to arrange for a viewing. She is available for inspection by appointment only; we will do everything we can to accommodate a last-minute showing. Once aboard you will truly be able to appreciate the thinking that has been incorporated to create this trawler masterpiece.

Jeff Merrill Yacht Sales, Inc. © 2023 All Rights Reserved. www.JMYS.com

Snowbird 73 *True Love*

For additional information please visit **True Love's** website: www.Snowbird73.com

Exclusions: Potential purchasers should assume that items on the vessel at the time of viewing, but not specifically listed on this sheet, are not included with the sale of the yacht. These specifications are believed to be true and correct but cannot be guaranteed. Items excluded include, but are not limited to Paintings, tools, handheld nav gear and binoculars. Owner's personal effects and clothing will be removed prior to closing.

Disclaimer: Jeff Merrill Yacht Sales, Inc. presents the details of this vessel in good faith but cannot guarantee or warrant the accuracy of this information nor guarantee or warrant the condition of the vessel. Buyers should instruct their agents and their surveyors to investigate all details the buyers desire validated. This vessel is offered subject to prior sale, price change, or withdrawal without notice.

Brokerage: JMYS is a US based (licensed and bonded yacht brokerage in California, Florida and Washington) with an international emphasis specializing in ocean capable trawlers and recreational tugs. Our brokers are experienced boaters, most are trawler owner/operators with thousands of hours and miles at sea. We treat our clients with respect, we are responsive and not pushy. Our focus is to become your loyal advocate, always looking out for your best interests. The team at JMYS has extensive trawler and motor yacht product knowledge and our skills are available for coaching after the sale has concluded. **Co-Brokerage:** Fellow yacht broker association members: **True Love** is available for Co-Brokerage.

***Listing broker. Jeff Merrill, CPYB** (Certified Professional Yacht Broker) has extensive product knowledge of the trawler market plus direct experience with this custom aluminum trawler. Jeff was her listing broker several years ago and has kept in regular contact with her current owners. He has been aboard and underway several times. Jeff is a familiar face to YouTube viewers and a regular presenter at TrawlerFest. He writes about trawlers for *Ocean Navigator* and *PassageMaker* magazines and is one of the online instructors for Boaters University.

This listing specification has been approved by the sellers for accuracy. The photos, images and descriptive content are copyrighted by JMYS and may not be copied or used without specific written permission. All inspections are by appointment only. Please contact listing broker, **Jeff Merrill, CPYB** by phone- call or text his mobile +1 (949) 355-4950 for email for additional information or to schedule your personal showing. You can send a detailed email to: Jeff@JMYS.com

Snowbird 73 *True Love*



Licensed and Bonded in California, Florida, Virginia and Washington.

Skype: jeff.merrill | You Tube: Jeff Merrill Yachts | Twitter: @merrillyachts | LinkedIn: jeff.merrill

Facebook: Jeff Merrill Yacht Sales | Instagram: JMYSTrawlers

Chairman, Certification Advisory Council (CAC) for CPYB 2023 and 2024

Yacht Brokers Association of America | International Yacht Brokers Association (Florida) | Northwest

Yacht Brokers Association | California Yacht Brokers Association – President 2015 and 2016

