

Nordhavn 56 Motorsailer *NordSail One*



JMYS

Jeff Merrill Yacht Sales, Inc. | www.JMYS.com
3010 Old Ranch Parkway, Suite 440 | Seal Beach, CA 90740

Florida address: Jeff Merrill Yacht Sales, Inc. | 3321 S.E. 14th Avenue | Ft. Lauderdale, FL 33316



NordSail One

Asking: \$895,000.00 **Location: San Diego, CA**
LLC Owned

Few sail boats have the potential to cross oceans with equal ease under both sail and power. The Nordhavn 56 is a rare design that beautifully marries the potential to sail forever with a main engine power plant engineered by the passage making trawler leaders at PAE/Nordhavn.

NordSail One is the first of the series and led the charge that resulted in a further seven hulls to follow. The cost to order a new motorsailer today would exceed 2.5 million dollars and require a long wait.

Approaching *NordSail One*, you will admire an elegant looking sailing yacht with a roomy forward deck and a trawler like pilothouse that combines the salon and inside helm station. The transom has a

Nordhavn 56 Motorsailer **NordSail One**

molded-in swim platform and you ascend a few steps to arrive in the raised (and covered) cockpit which initiates the upper level entering the saloon and inside helm.

Her sailing performance is genuine, with a balanced sail plan and powered winches for ease of control. One brilliant innovation is her forward sailing helm station outside and ahead of the pilothouse. There is a large steering wheel on a binnacle with the essential navigation read outs mounted for quick reference. This outside well has a teak grate and comfortable seating, affording the skipper a great view of the sails and surroundings. This provides a secure center cockpit with excellent visibility and surprisingly easy sail controls.

The headsail is adjusted via a hydraulic furler and hydraulic primary winches and has a high cut foot for a clear view along the horizon. The full batten mainsail is stowed in a Leisurefurl boom that is supported by a Navtec hydraulic rod boom vang. There is an assortment of Lewmar hydraulic/manual winches to simplify sail trim adjustments. Sheet controls are on deck and on the mast. **NordSail One** also has the optional cruising spinnaker package. Any sailboat can travel with strong winds, but one of the amazing attributes of **NordSail One** is how well she moves in a soft breeze. She is well balanced and stiff, but lively as well.

The deck is hemmed by solid stainless rails. The foredeck has multiple opening hatches, the forward most containing a spacious sail locker that is just aft of the chain locker. Dual anchor rollers feed a Maxwell windlass, an impressive ground tackle arrangement to set the hook when you arrive in paradise. The Forespar double spreader mast is secured with stout standing rigging and massive stainless-steel chain plates.

Atop the pilothouse is an arch for nav/com antennas and the ships tender mounted athwartships. The boom has a built-in electric winch box for launching the RIB. You access the pilothouse roof via a ladder in the cockpit- aft, safe and secure.

The aft deck has winches for the cruising spinnaker, propane locker, gas barbecue on custom rail mount and storage, a ladder to the pilothouse deck and a built-in console with sink, electric barbeque and refrigerator. This is an outstanding place to entertain and an ideal location to relax once you have arrived at your destination.

NordSail One's interior is a gorgeous blend of varnished teak with granite counters. There are very few sailboats that provide such impressive visibility to the outside world from inside. This is achieved by installing large windows in the upper level and additional windows along the galley and hallway plus deck hatches and hull portlights.

Entering the salon through the Dutch door you will immediately appreciate the sparkling fit and finish that has made the construction yard, Ta Shing in Taiwan, world renowned for their quality.

The salon has two ottomans to port fronting a flat screen television. To starboard there is a U-shaped dinette with a fixed teak table. The forward area is all pilothouse centered by a Stidd helm chair with an impressive dash arrangement making it easy to monitor the ships systems and navigate. Controls and panels for the main engine, generator, thrusters and the Hundested propeller are neatly arranged and within easy reach.

Nordhavn 56 Motorsailer *NordSail One*

A short flight of stairs takes you down to the middle level with the port hallway passing along the engine room inboard on centerline and leading up to the guest stateroom. The VIP stateroom has a walk around island berth on centerline with lockers, drawers, a television, hatches and opening port lights. The head and separate shower stall are forward. It would not be difficult to mistake this for the owner stateroom and may be the preferred place to sleep when you are at rest.

The engine room has a large opening door and you step down onto decking that surrounds the Luger main engine. The keel stepped mast and fuel supply reservoir are forward. The fuel valves (supply and return) are outboard to starboard and the Racor fuel filters are easy to observe to port. The sailing cockpit floor above is cleverly laid out to give you full standing headroom forward and to port in the engine room. When was the last time you heard of a sailboat under 100' in length that has standing headroom in the engine room?

The ships electrical panel is across from the engine room door. Outboard to port in the hallway (under the side deck) are a series of large cabinet doors that contain the separate Asko clothes washer and dryer and a water maker locker – an extremely efficient use of space.

Working to starboard you arrive in the galley – laid out for convenient cooking when underway and heeled over in a blow. The large stainless sink is forward and the galley appliances include a trash compactor and a propane three burner stove and oven as well as a microwave. The granite counters have grab rails and there are plenty of lockers and drawers for galley ware and provisions.

Meals can be served in the aft quadrant at the fixed teak table with settees on both sides. The outboard settee is long enough to serve as an extra berth in rough seas. The Vitrifrigo refrigerator and freezer drawers rest between the galley dinette and the aft facing stairway that goes to the lower level owner stateroom.

The owner stateroom is on the lower level and takes over most of the space beneath the saloon. The walk around island berth is up high and easy to get in and out of and to make. There is a flat screen television and numerous lockers and drawers. There is a desk/vanity with mirror and an adjoining head and stall shower outboard to starboard.

You can enter the lazarette from the cockpit on deck or through a dogged door aft in the owner shower. The lazarette is roomy with ships batteries, inverter, generator, diesel hydronic heat, stern thruster and fire suppression all positioned for easy servicing.

There is so much to discover, please read on to learn more.

YACHT NAME:	<i>NordSail One</i>
BRAND AND MODEL:	NORDHAVN 56 Motorsailer
TYPE:	Long range ocean cruising sailboat with two helm stations
MODEL YEAR:	2009
HULL COLOR:	Gray gel coat
REGISTRY:	United States Coast Guard documented

Nordhavn 56 Motorsailer *NordSail One*

DESIGNER:	Jeff Leishman
BUILDER:	P.A.E./Ta Shing – Tainan, Taiwan
HULL MATERIAL:	Solid Fiberglass
DISPLACEMENT:	95,000 lbs. / 43.09 MT
BALLAST: (Keel)	17,500 lbs. / 7.95 MT
RANGE:	3,000 miles @ 7 knots under power, unlimited sail
SPEED:	Cruise 8, Top 10 knots under power
LOA:	57'5" / 17.5 M
LWL:	52'6" / 16.0 M
BEAM:	16'7" / 5.05 M
DRAFT:	7'0" / 2.13 M
AIR DRAFT:	74' / 22.55 M to top of mast (est.)
MAIN ENGINE:	LUGGER L1066T 165 Horsepower @ 2400 RPM (Main hours: ~2,924) January, 2022
EXHAUST:	Wet exhaust
PROPELLER:	Hundested Model #VP 4 FR-ELC variable pitch - four blade
SAILS:	Full batten in boom furling main, roller furling genoa, cruising spinnaker - North sails
MAST:	Forespar mast
BOOM:	Leisurefurl boom. Box with winch for dinghy launch
WINCHES:	Lewmar - manual and hydraulic
THRUSTERS:	Side Power 15 HP 24-volt Bow thruster and Stern thruster
ELECTRICAL:	60 Hertz – US style - 50-amp service for house and air conditioning
GENERATOR:	Northern Lights 12 kW (Generator hours: ~2,120) January, 2022
INVERTER/CHARGER:	Outback 24-volt Inverter (# VFX3524) with bypass / Mastervolt charger
BATTERIES:	Lifeline AGM, main engine start/Battleborn lithium house, thruster and comm
WATER MAKER:	Village Marine SPW water maker (600 gallons / day)
CLIMATE CONTROL:	Cruisair Air conditioning/Olympia OL-60 diesel hydronic heat
WINDLASS:	Maxwell 24-volt VWC 3500 windlass
TENDER AND OUTBOARD:	Aquapro 11'-5" SRM1101 tender with 20 HP Honda outboard

Nordhavn 56 Motorsailer *NordSail One*

NAV/COM:	Furuno / B&G / Icom / Simrad / JRC
ENTERTAINMENT:	Samsung flat screen TV's 55", 43", 32", 19". Bose Surround in salon. (3) Blu-ray players
STATEROOMS:	(2) Owner aft, Guest forward
HEADS:	(2) Tecma electric freshwater
SHOWERS:	(2) Owner and Guest
LAUNDRY:	Asko clothes washer / Asko clothes dryer
GALLEY:	Force 10 propane stove and oven, Vitrefrigo Refrigerator/Freezer drawers
INTERIOR WOOD:	Teak and white laminate
INTERIOR COUNTERS:	Granite counters
INTERIOR UPHOLSTERY:	Ultraleather
INTERIOR FLOORING:	Teak and spruce
SAFETY:	Fire suppression engine room and lazarette / Liferaft / EPIRB
TANKAGE: (approx.)	
FUEL:	800 gallons / 3,038.3L (two fiberglass and one aluminum supply tank)
HOLDING BLACK:	75 gallons / 283.9L (one fiberglass tank)
FRESH WATER:	250 gallons / 946.4L (three fiberglass tanks)

Note: All information is believed accurate but should be verified. Photos from 2017.

There is a YouTube video on JMYS.com you can watch featuring *NordSail One*:



Please visit the dedicated website with additional information www.Nordhavn56ForSale.com

Nordhavn 56 Motorsailer *NordSail One*

LAYOUT: Upper Level – Cockpit and Saloon/Pilothouse:

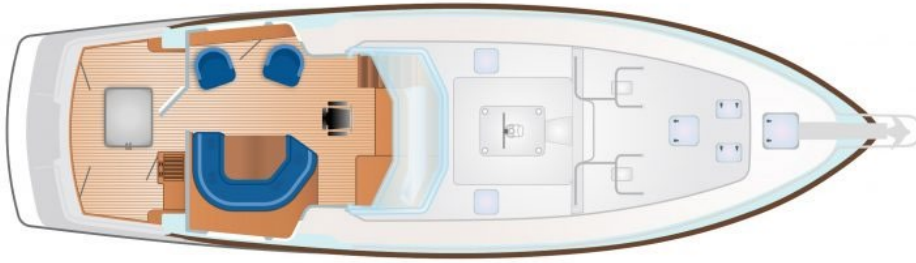

LAYOUT: Lower Level – Galley and Staterooms:

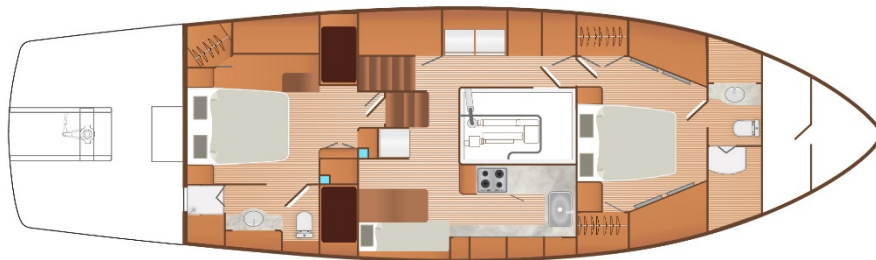

NordSail One is more properly defined as a “trawlersailer” since, in addition to being an easily handled sailboat that gallops along across the wind spectrum, she benefits from two decades of PAE experience building long range trawlers and fifteen years of Mason full displacement sailboats prior. Her sail plan is easily trimmed for all breeze conditions. Her spacious engine room boasts diesel propulsion from her reliable Lugger main engine that spins the incredible Hundested variable pitch propeller for optimum rpm/burn rate and loading. As the owner, you have a variety of underway options to enjoy the journey with easily furled sails and possibly the most efficient engine package ever installed on a sailing yacht.

NordSail One is available for inspection by appointment only as the sellers continue to enjoy her while searching for a new owner.

Why is she for sale? The owners were cruising Mexico. In 2022, their plans were to cruise to the PNW. While bringing the boat back up to California, an unfortunate accident happened due to a winch failure (which has been corrected). This event led to their cruising plans cancellation and decision to sell.

Items to be aware of: Secondary on mast Radome not functioning. M5 satellite not operating, KVH /Dish discontinued support. NordSail One and NordSail One Sat Wi-Fi routers not functioning due to not having a password. SSB radio not operational. Nobeltec nav computer missing mouse and keyboard.

Exclusions: Potential purchasers should assume that items on the vessel at the time of viewing, but not specifically listed on this sheet, are not included with the sale of the yacht. These specifications are believed to be true and correct but cannot be guaranteed. Items excluded include, but are not limited to Paintings, tools, handheld nav gear and binoculars. Owner’s personal effects and clothing will be removed prior to closing.

Nordhavn 56 Motorsailer *NordSail One*

Disclaimer: Jeff Merrill Yacht Sales, Inc. presents the details of this vessel in good faith but cannot guarantee or warrant the accuracy of this information nor guarantee or warrant the condition of the vessel. Buyers should instruct their agents and their surveyors to investigate all details the buyers desire validated. This vessel is offered subject to prior sale, price change, or withdrawal without notice.

Brokerage: JMYS is a US based (licensed and bonded yacht brokerage in California and Florida) with an international emphasis specializing in ocean capable trawlers. Our brokers are experienced boaters, most are trawler owner/operators with thousands of hours and miles at sea. We treat our clients with respect, we are responsive and not pushy. Our focus is to become your loyal advocate, always looking out for your best interests. The team at JMYS has extensive trawler and motor yacht product knowledge and our skills are available for coaching after the sale has concluded.

Co-Brokerage: Fellow yacht broker association members: This listing is available for co-brokerage and JMYS is a 50/50 house. Courtesy showings are available by appointment. Florida listings subject to appropriate broker licensing required by law.

***Listing broker. Jeff Merrill, CPYB** (Certified Professional Yacht Broker) has extensive product knowledge of the trawler market plus intimate knowledge of the Nordhavn 56 Motorsailer. Jeff is a familiar face to YouTube viewers. This listing specification has been approved by the sellers for accuracy. The photos, images and descriptive content are copyrighted by JMYS and may not be copied or used without specific written permission. All inspections are by appointment only. Please contact listing broker, **Jeff Merrill, CPYB** by phone, text or email for additional information or to schedule your personal showing.



Jeff Merrill, CPYB Certified Professional Yacht Broker | **Licensed and Bonded in California and Florida**
Mobile phone: +1 949.355.4950 – call or text Email: Jeff@JMYS.com

Skype: jeff.merrill YouTube: Jeff Merrill Yachts Instagram: JMYS Trawlers Website: www.JMYS.com

Twitter: @merrillyachts LinkedIn: jeff.merrill Facebook: Jeff Merrill Yacht Sales

Member California Yacht Brokers Association – President 2015 and 2016

Member International Yacht Brokers Association, Northwest Yacht Brokers Association and Yacht Brokers Association of America

