

Nordhavn 62 Island Greeter



JMYS

Jeff Merrill Yacht Sales, Inc. | www.JMYS.com
4153 Country Club Drive | Long Beach, CA 90807

Florida address: Jeff Merrill Yacht Sales, Inc. | 3321 S.E. 14th Avenue | Ft. Lauderdale, FL 33316



Island Greeter

Price: \$1,575,000.00

Location: Anacortes, WA

(Note: Slip available separately for sale or for lease)

Jeff Merrill Yacht Sales, Inc. © 2023 All Rights Reserved www.JMYS.com

Nordhavn 62 Island Greeter

INTRODUCTION:

Island Greeter is an active and lightly used original owner Nordhavn 62 in exceptional condition. Two years of planning and construction, getting all of the details right, merged into fifteen years of cruising, primarily during the spring and summer months up in the Pacific Northwest. **The owners also purchased and own the slip at Skyline marina in Anacortes – you can purchase a ready-to-go Nordhavn 62 and acquire the slip to give you a home base.**

Hull number 34 of 39 built, she had the benefit of seeing the selections made by predecessor hulls which dramatically improved the overall package. Wide body saloon for more interior space (with two larger windows, a nicer feel than the original three). Oval vs. round portlights. Custom fiberglass dry stack mast with antennas. File drawers with metal glides. Stern bustle which adds waterline offshore and provides a convenient dinghy dock platform with the small generator inside.

Inside is gorgeous. Gloss cherry woodwork, rich and exquisite. The hallway forward connects to the engine room, owner stateroom, guest stateroom and spectacular VIP forward with an inviting island berth. Each stateroom has a convenient head and shower access. The pilothouse has a well-planned forward instrument dash, settee with table and the practical office with stool.

On deck she has a centerline hydraulic crane for launching two dinghies. The upper aft deck is ideal for getting outside, out of the wind and relaxing with a mug of coffee or a glass of wine. Her machinery is dependable. Lugger main engine with dry stack exhaust, Lugger wing engine, two Northern Lights generators, ABT active fin stabilizers, hydraulic windlass and thrusters. Lifeline AGM batteries.

SPECIFICATIONS:	
YACHT NAME:	<i>ISLAND GREETER</i>
BRAND AND MODEL:	Nordhavn 62
TYPE:	Aft pilothouse long range trawler yacht
LOCATION:	Anacortes, WA
MODEL YEAR:	2007
HULL NUMBER:	34
HULL COLOR:	Gray gelcoat
DECK:	White deck with gray nonskid (gelcoat)
REGISTRY:	United States Coast Guard documented
DESIGNER:	Jeff Leishman
BUILDER:	Ta Shing - Taiwan ROC
HULL MATERIAL:	Solid fiberglass
DISPLACEMENT:	155,000 Lbs. 70.31 MT
BALLAST:	7,000 Lbs. 3,182 KG
SPEED:	Cruise 9.5 knots. Top 11.0 knots.
RANGE:	3,000 miles at cruise speed

Nordhavn 62 Island Greeter

LOA:	67' 20.42 (with bustle)
LWL:	55' 6" 16.92 M
BEAM:	19' 4" 5.89 M
DRAFT:	6'10" 2.08 M
AIR DRAFT:	Stack height above waterline (approximate) 23'9" 7.24
A/B RATIO	2.2:1
CP - PRISMATIC COEFFICIENT	0.6
ENGINE:	Lugger L1276A, 12.5-liter Turbo, 340 BHP@ 1,800 RPM continuous (Hours~ 3,100 January 2023) Twin Disc Power Commander Model EC-200 Control System (4) stations
TRANSMISSION:	Twin Disc MG-5091SC 2.95:1 ratio.
PROPELLER / SHAFT:	3" Aquamet 17 shaft 4 blade 41 x 30 bronze propeller. Spurs line cutter.
MAIN EXHAUST:	Keel cooled, dry exhaust. Walter keel cooler.
WING ENGINE:	LUGGER Model LP445D 85 BHP @2200 RPM continuous (Hours ~215 January 2023) Morse dual lever controller ZF Hurth V-drive transmission 2.47:1 1.5" Aquamet 17 shaft Gori 3-blade feathering propeller 24 x 19.
LUBE OIL:	Oberdorfer 991-32-A97 oil transfer pump 125/473 L gallon new oil tank 125 gallon /473 L used oil tank (both tanks are aluminum). Note: Used oil tank converted to wing engine diesel supply tank.
HYDRAULICS:	Hydraulics systems include bow and stern thrusters, starboard windlass, anchor chain wash and emergency bilge pump Keel coolers Main engine and wing engine driven pumps
THRUSTERS:	American Bow Thruster TRAC 10" – 25 HP bow and stern thruster.
STABILIZATION:	TRAC digital model 250 hydraulic active fin stabilizers
AT REST:	Flopper stopper booms port and starboard
ELECTRICAL:	60 Hertz – US style – 50-amp
SHORE POWER:	Foredeck: 50-amp and 30-amp for house 50-amp for air con Cockpit: 50-amp for house with Glendinning CM7 cord retriever. Universal electric system to operate from 60 Hz to 50 Hz with cruising generator
GENERATOR 1:	Northern Lights 20kW generator with sound shield Lugger Model M844LK (~695 hours January 2023)

Nordhavn 62 Island Greeter

GENERATOR 2:	Northern Lights 8kW generator with sound shield Luggier Model M753K (~ 1,195 hours January 2023) in stern bustle. Note: Has auto-start.
INVERTER/CHARGER:	(2) Xantrex Trace SW4024MC2 pure sine wave inverters Inverter bypass switch Victron Skylla TG 24/80 battery charger Smart Boost transformer
BATTERIES:	(14) Lifeline 8D AGM batteries for house bank (2) Lifeline 4D AGM batteries for Main start (2) Lifeline AGM Group 31 batteries for Wing Engine/Generators start.
INTERIOR LIGHTING:	Cantalupi and AAA halogen lighting
CLIMATE CONTROL:	Cruisair reverse cycle HVAC: (5) compressor assemblies and (7) air handler/fan coil assemblies. SMXir temperature controllers. Approximately 136,000 BTU's. (4) each King 2200-Watt 240 Volt dial a watt heaters
MACHINERY EQUIPMENT:	Hydraulically driven 24 VD Electrodyne E250-24 heavy duty alternator Cruising generator up to 8kW Racor Duplex for main Oberdorfer 991-32-A97 fuel transfer pump with Racor filter Walbro 6803 fuel boost pump Nutone CV-353-W central vacuum system Kahlenberg dual trumpet air horn with compressor Deck box with 40 gallon aluminum gasoline tank with 24V fuel dispenser hose and nozzle for tenders Pre-wired with breaker and platform for future SCUBA air compressor Mighty Pure MP-36B UV fresh water sterilizer (2) Fresh water pumps (2) back up holding tank pumps (2) back up air conditioning pump (4) underwater lights
WINDLASSES:	Maxwell VWC 4500 vertical capstan hydraulic windlass (starboard, primary) with Auto Anchor 500C electronic controller. Port bow windlass is Maxwell Liberty RC1700 24V electric vertical windlass. Maxwell VWC 4500 vertical capstan 24V electric windlass in cockpit.
GROUND TACKLE:	300 LB. Aritex stainless steel plow with swivel and 500' of 1/2" high test chain Secondary bow anchor with 400' chain
CRANE:	Aritex hydraulic-electric model HSC-1000 crane rated to 2,200 lbs. Center on foredeck with stainless steel crutch support post.

Nordhavn 62 Island Greeter

TENDER AND OUTBOARD:	Nautica 17' inflatable dinghy with seat and steering console 115 HP Yamaha outboard Nautica 10' inflatable dinghy 15 HP Yamaha outboard Both tenders have cradles, tie downs and covers.
NAV/COM BRANDS:	Simrad Icom IBM monitors Wesmar KVH Nobeltec
NAV/COM POWER:	(1) Lifeline AGM Group Size 31 battery and Xantrex Tru-charge multi-stage battery charger for Nav/Com.
ENTERTAINMENT:	Entertainment cabinet in saloon Stereo with speakers in cockpit and upper aft deck TV lift with large Sharp Aquos flat screen television in saloon Sharp Aquos flat screen television on galley counter Sharp Aquos flat screen television in owner stateroom Sharp Aquos flat screen television in port stateroom Sharp Aquos flat screen television in VIP stateroom Dish TV sub expired
STATEROOMS:	Three: Owner aft, Guest port side, VIP forward
BEDDING:	Owner island berth amidship with custom HMC mattress (2) single berths in port guest stateroom VIP island berth with custom HMC mattress.
HEADS:	Three: Sealand model 506 vacuum freshwater toilets (electric freshwater)
HOT WATER:	30-gallon Torrid (2018) water heater tank with mixing valve – electric heated and engine heated.
SHOWERS:	Four: Stand up in owner head with door Stand up in guest head with door Stand up off VIP with door (3) interior showers have sump pumps Cockpit shower.
LAUNDRY:	Asko clothes washer and Asko clothes dryer. Built in laundry folding shelf.
GALLEY:	Sub Zero door refrigerators and freezers with Icemaker Four-burner propane stove cook top Separate under counter electric oven with broiler GE Profile microwave oven with exhaust fan Miele G832SC dishwasher GE monogram trash compactor Double basin ss sink with garbage disposal Galley appliances with stainless steel surfaces Built in GE propane cockpit barbeque with rotisserie
INTERIOR WOOD:	Gloss cherry
INTERIOR COUNTERS:	Granite counters
INTERIOR UPHOLSTERY:	Ultraleather

Nordhavn 62 Island Greeter

INTERIOR FLOORING:	Teak and spruce hardwood throughout (much covered with carpet)
BILGE PUMPS:	(4) Par 34600 electric bilge pumps (2) Rule 21R electric bilge pumps (3) Edson 638 manual bilge pumps Ultra senior safety switch Rule super switch high water bilge pump High water bilge alarms Back up float switches
TANKAGE: (approx.)	
FUEL:	2,575 gallons 9,735 liters (Four fiberglass primary tanks, one aluminum tank)
HOLDING BLACK:	130 gallons 492 liters (Two fiberglass tanks 70 in bustle, 60 below main engine)
FRESH WATER:	570 gallons 2,158 L (One fiberglass tank)
SAFETY:	Sea-Fire FE-241 auto/manual engine room fire suppression system Sea Fire self-actuating extinguishers forward and amidships bilge USCG safety package EPIRB Switlik SAR 6H TSD MK II six-person offshore life raft (out of service, needs re-pack) Engine room high water bilge alarm Hydraulic anchor wash valve for bilge pump Smoke detectors Lifesling in cannister
PHOTO DATE:	Most photos taken January 2022
Note: All information is believed accurate but should be verified.	

Layout: Raised Pilothouse

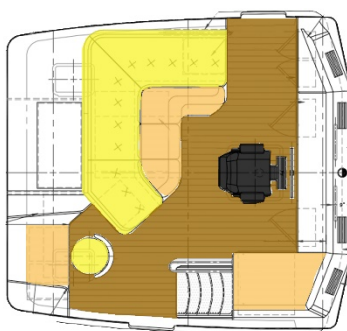

Layout: Lower Deck Staterooms and Heads

Nordhavn 62 Island Greeter

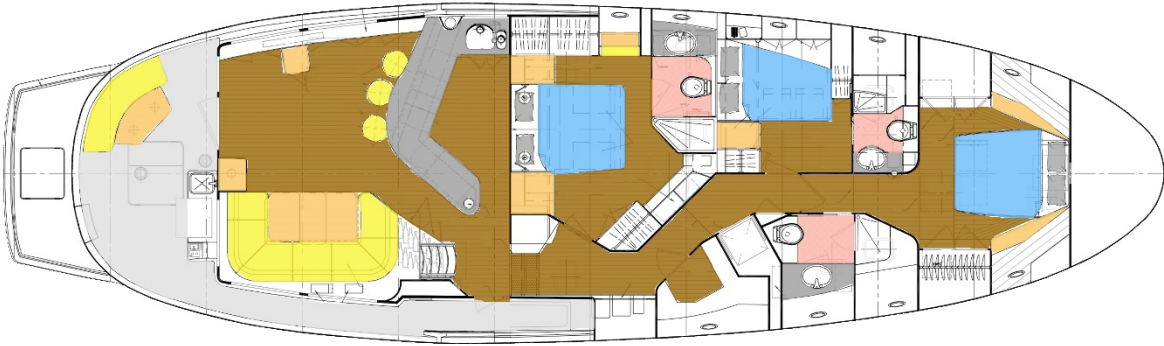

ACCOMMODATIONS and LAYOUT:

You can get all around the deck with side door hull to starboard and access from the stern bustle. It is extremely easy to dock, you have control stations not only in the cockpit for backing into a slip, but also outboard port and starboard on the Portuguese bridge.

Aboard and inside *Island Greeter* you will find the luxury and craftsmanship that the Ta Shing yard in Taiwan is world famous for. The saloon is spacious, with large outboard windows and gently transitions to the galley with the choice of going forward to the staterooms (and engine room access) or up top to the pilothouse.

The accommodations forward of the galley are comprised of the usual large owner stateroom aft with ensuite head and shower and then the port stateroom forward with ensuite head and shower, then a truly impressive and sought after forward VIP stateroom featuring a luxurious island berth.

This 62 has an impressive pilothouse with Stidd helm chair, great access and visibility for all electronics and a comfortable bench behind the helm for guests to gather underway. The bridge also includes a desk with swing out chair.

There is a stainless stem guard on the bow at waterline to help protect the hull from flotsam. The foredeck features two fiberglass deck boxes, two RIB dinghies and a polished stainless-steel crane. Dual anchors with appropriate ground tackle are in place. There is a "midship" shore power connection station to starboard.

The cockpit has a home style propane barbeque and seating. The stern bustle includes a Glendinning shore power retriever and inside houses a generator.

MAIN SALOON

Entering the saloon through a wide watertight door you are immediately struck by beauty, elegance and openness, this is an area that both flows and provides numerous comfortable seating arrangements.

Nordhavn 62 Island Greeter

The port side entrance is easy access (you could add a reclining chair, but they prefer the open space). There is also an entertainment island and outboard a flat screen television on a concealed lift. To starboard in the saloon is a beautiful dinette with teak table that has removable middle section.

The interior of **Island Greeter** is all high gloss varnished cherry which has been carefully selected and beautifully matched. The floors except where specified are traditional varnished teak and spruce. The cabin doors have the new magnetic catches. All rooms have dimmer switches for the overhead lights.

- Gloss varnished dinette table. Two fixed pieces with removable center leaf for easier outboard seating access.
- Ultraleather wrapped cushions surrounding dinette
- Bose Lifestyle 35 stereo system
- Aritex TV lift system
- Sharp Aquos 37" LCD display TV
- Built in media cabinet with glass door for remote beams
- DVD player
- Digital AV receiver
- XM satellite radio
- DirecTV
- (2) Large Ekornes chairs with ottomans
- Cloth window shades
- Overhead lights on dimmers and rope lighting in overhead
- All doors and windows are built by PCM
- There is a PCM Dutch door opposite the galley to starboard to let the natural sea breeze enter without allowing the sea in

GALLEY

The huge outboard window forward in the galley complements the saloon windows and accentuates your view from the galley. This galley features a four-burner propane cook top, supplemented with a below counter electric oven. Appliances include a dishwasher, microwave convection oven, trash compactor plus two refrigerators and a freezer. The granite counter offers an expansive serving area and the light color blends well with the saloon furniture.

- Two Subzero refrigerators – model 249RP – cherry faces
- Subzero refrigerator/freezer - model 245 with ice maker – cherry face
- GE Microwave/convection oven - model JVM1490SS
- Thermador 4 burner cook top - propane
- Miele 18" dishwasher
- GE Profile full size oven - model JK915SOF255– all electric
- Double sink with soap dispenser
- Garbage disposal
- Galley post wire chase is covered in cherry
- GE Monogram trash compactor
- Pull out shelves in galley locker outboard of trash compactor
- Wider diameter stand pipe conduit in cherry (wire run from engine room to pilothouse)
- Granite counter tops

Nordhavn 62 Island Greeter

OWNER STATEROOM

Forward of the galley is a hallway which starts outboard to starboard with the electrical panel and finds the owner stateroom immediately to port. This aft location is much more comfortable in a seaway and focuses on a large island berth running fore/aft. Outboard to port is a built-in changing seat and forward to port is a head with shower. There is a full-length dressing mirror. A Sharp Aquos flat screen television is mounted on the forward bulkhead below the classic round deck windows. There is an incredible amount of storage for clothes with drawers and hanging lockers. The owner features a custom HMC inner spring mattress.

- Queen size berth with custom HMC inner spring mattress
- Headboard mirrors with beveled glass edges
- Upholstered changing seat, settee
- Large dresser drawers
- Large hanging locker
- 26" Sharp Aquos flat screen TV
- Cherry book shelf installed above owner bed – complete with cruising book library
- Overhead hatches with Ocean Air roller screen/shades: 1 large, 1 small
- 2 round portlights
- Combination safe for valuables
- Mirror headboard behind bed

OWNER HEAD

This is a convenient and private head with shower and sink. It is finished with varnished cherry (an upgrade from the standard gelcoat) and includes mirrored medicine cabinet and lockers.

- Granite counter top
- Shower: Molded fiberglass, with glass door
- Grohe fixtures in sink and shower
- Soap dispenser
- Cherry paneling and cabinetry with lockers and drawers
- Mirrored cherry medicine cabinet
- Sealand Vacuflush fresh water head
- Shower exhaust blower with timer
- (1) port light behind sink and (1) in shower
- (2) port lights outboard to port
- Overhead hatch with Ocean Air roller screen/shade

HALLWAY

Gorgeous teak and spruce floors reflect up to the varnished cherry panels of the hallway which runs the full length of the lower-level living quarters. At the beginning of the hallway to starboard is the ships main electrical panel with all of the necessary breakers and displays easily readable and logically labeled. This is convenient being right across from the owner stateroom and also close to the engine room which is accessed from the same area. There is a pantry locker to starboard and concealed laundry appliances.

- Pantry locker to starboard with built in shelves
- Asko clothes washer
- Asko clothes dryer

Jeff Merrill Yacht Sales, Inc. © 2023 All Rights Reserved www.JMYS.com

Nordhavn 62 Island Greeter

- Electrical panels
- Tank tender
- Tank watch display
- Generator controls for both units
- Battery switches
- Drawers and cabinets for storage
- Water maker remote panel

GUEST STATEROOM Port

The port stateroom has a double bunk bed running along the hull. There is storage and easy access to the en-suite head and shower.

- Two bunk berths
- Large hanging lockers
- Dorade vent letting in natural air flow from deck above
- Forward overhead storage locker
- Drawers and cabinets for storage
- (2) Port lights
- Large overhead hatch with Ocean Air roller screen/shade

GUEST HEAD

- Shower: molded fiberglass with seat
- Cherry panels and cabinetry
- Mirrored cherry medicine cabinet
- Electric shower drain with timer
- Grohe fixtures in sink and shower
- Sealand Vacuflush_fresh water head
- Shower exhaust blower with timer
- Port light in shower
- Overhead Hatch in head with Ocean Air roller screen/shade
- Granite countertop

VIP STATEROOM Forward

This is a stateroom that is the equal of the owner cabin. In fact, at anchor, this is likely the preferred accommodations due to the light and air flow. Very few Nordhavn 62s created an island berth in the forward stateroom. The ensuite head and shower make for a comfortable and private retreat.

- Island berth with custom mattress.
- Hanging lockers
- Hatches over bed with Ocean Air roller screen/shades
- Port lights port and starboard
- Extensive storage under berth

VIP HEAD forward

The forward head and shower is extremely convenient for the VIP's occupying this space. This head is light, airy and easy to keep fresh.

Nordhavn 62 Island Greeter

- Shower: separate compartment of molded fiberglass with seat
- Large sink with storage underneath
- Electric shower drain with timer
- Grohe fixtures in sink and shower
- Sealand Vacuflush_fresh water head
- Shower exhaust blower with timer
- Port light in shower
- Mirrored medicine cabinet
- Electric shower drain with timer
- Overhead hatch in head with Ocean Air roller screen/shades

PILOT HOUSE

The aft pilothouse on the Nordhavn 62 is one of this vessels' most attractive features. Incredible 360-degree visibility gives you a view perspective unequalled on other trawlers. This space is planned for underway operations and the gorgeous cherry joinery blends in with the luxurious feel of the living areas below. The display mounting surface areas are varnished cherry (not the charcoal laminate so commonly found) which are wonderfully outfitted marine electronics featuring large screen displays and redundant marine navigation. A very nice touch is the cherry console panels in the overhead. Aft of the helm is a nice bench seat area with varnished table and a watch berth aft atop a deep freezer. Starboard aft is an office area with desk surface and swing out chair with seat back. Both pilothouse doors are Dutch with cherry veneer on interior. On top is the contemporary design fiberglass dry stack exhaust upgraded.

- Luger main engine panel with analog gauges and Murphy digital
- Luger wing engine
- ABT TRAC active fin stabilizers
- ABT hydraulic controls for bow and stern thruster
- Hydraulic control button panel
- PCM Dutch Doors to port and starboard allow you to enjoy natural cross ventilation at anchor or while underway
- Large overhead hatch with Ocean Air roller screen/shade – sided with ss handrails
- Gloss varnished cherry table
- Instrument dash upgraded to cherry, not Formica (Note: spare cherry panels ordered when new for future instrument placement)
- GE 9 cubic foot freezer installed beneath watch berth
- Teak and spruce flooring with edge bound carpet covers
- Custom Stidd helm chair
- Cushioned bench seat with Ultraleather covering
- Dual Trumpet Kahlenberg horns
- Clock and Barometer
- Red overhead lights for night running
- Stainless steering wheel (stowed out of way in port under seat locker)
- Wesmar SS 395 Sonar
- (3) IBM 21" display monitors

Nordhavn 62 Island Greeter

- (2) Nobeltec radars with 6.5 ft. open array antenna, and a 72-mile range
- Furuno FA150 universal AIS system
- Furuno GP37 WAAS/DGPS
- Furuno SC50 Satellite GPS compass
- (2) Simrad AP50 with J50-40 autopilots
- Autopilot remotes
- Simrad FU50 follow up steering lever
- Jog lever controls are installed at each docking station
- Digital instruments include Furuno depth and speed transducers
- Furuno FCV582L 600W clear LCD depth sounder
- (2) Icom 602 VHF radio with DSC – get GPS input from Sat compass
- Iridium model 9555 satellite telephone with outside antenna
- Digital wireless cellular telephone repeater/amplifier
- KVH TracVision GP-HP Dual system for satellite television
- Mounted cameras for closed circuit television display
- XM satellite radio
- Ritchie compass
- Engine instruments for the main engine
- Engine instruments for the wing engine
- (2) Nobeltec chart navigation programs
- Pilothouse roof features the “new” style FRP (fiberglass) exhaust stack
- Dorade vents in overhead
- Three parallel sweep windshield wipers
- Windshield washer switch
- Overhead panels hinged with PYI twist locks, not screwed in place
- Stainless rails by pilothouse doors
- Overhead roof has stack arrangement, antenna mounts, kayak storage and a painted nonskid surface

PILOT HOUSE DESK

One of the great places to have a quiet retreat or to relax when not underway is in the pilothouse. When you are off watch, but want to stay near the action, you will appreciate the built-in desk with swing out chair which can be set up as an underway office complete with file drawers.

- Cherry desk surface with drawers
- Swing out stainless desk chair
- Computer and keyboard at desk

UPPER AFT DECK

Leaving the wheelhouse and heading aft you will find the “back patio” which has a fiberglass table and built-in seating with cushions. The area is covered with a stainless Bimini top and is a wonderful place to enjoy the view especially at anchor. Easy access to the anchor flopper stopper poles and stainless flopper plates which, when deployed on the outriggers, settles the boat when anchored.

- The entire aft deck from the pilothouse door aft is protected by a stainless awning covered with a Stamoid weather proof top.

Nordhavn 62 Island Greeter

- Awning includes lighting
- Custom propane compartment with (4) 6.5-gallon tanks. Two for cockpit BBQ, two for galley stove
- Two built in aft facing seats with back and bottom cushions (which double as storage lockers)
- Seating area can covert to an overnight outdoor sleeping area
- There is a three-piece fiberglass table for enjoying the view during cocktail hour.
- A curved bench seat faces forward.
- Two outrigger poles for the flopper stoppers are mounted forward
- Two custom stainless storage frames have also been installed to house the stainless flopper hinged plate bridle assemblies.

PORTUGUESE BRIDGE DECK

Forward of the wheelhouse is a protected well where you can safely marvel at the sweeping ocean views. There are docking stations outboard port and starboard and a huge storage locker just forward of the pilothouse windows.

- Large storage locker under the outside of the front pilot house windows
- Wing “docking” stations port and starboard
- Storage in the forward centered fiberglass box
- Flood lights for foredeck

FOREDECK

You can reach the foredeck from the center access provided in the Portuguese bridge. Prominently positioned on centerline is polished stainless-steel crane dividing the two tenders. A hydraulic windlass for the primary anchor to starboard and separate electric windlass for the secondary anchor are on the bow. There are also two large dock boxes for storage. There is a shore power collection to starboard. The railing is all stainless tubes, no cable life lines. The teak cap rail has been painted over with gray Awlgrip for ease of maintenance.

- Maxwell 4500 hydraulic primary windlass with foot buttons on deck and digital counter in pilothouse
- 300 LB. Aritex stainless steel plow with swivel and 500' of 1/2" high test chain
- Maxwell Liberty RC1700 24V electric vertical windlass - secondary
- Secondary bow anchor with 200' chain and 200' rope rode
- Fresh water spigot
- Hydraulically powered anchor wash
- Shore power inlet connections on starboard side – for house and air conditioning
- (2) fiberglass deck boxes for storage
- One deck box houses approximately 40 gallon gasoline tank with demand pump and hose
- (1) 18" Freeman hatch for access to chain locker
- Aritex polished stainless crane with 1,000 KG capacity and stainless boom crutch.
- Nautica 17' inflatable dinghy with seat and steering console with 115 HP Yamaha outboard
- Nautica 10' inflatable dinghy with 15 HP Yamaha outboard
- Both tenders have cradles, tie downs and covers

Nordhavn 62 Island Greeter

COCKPIT

Entering the cockpit, you have a fiberglass seating area and table to port. Centered and forward is an electric warping winch for stern anchoring assistance. The cockpit area also boasts a built-in sink, propane barbeque and storage cabinets. There is an aft docking control station, located outboard to starboard atop the console. The lazarette beneath houses air conditioning compressors, the emergency tiller and has plenty of room to stow gear.

- The aft cockpit area has a table and bench seat on port
- There is a large counter forward to starboard with a sink, drawers, and cabinets
- Propane barbeque mounted in console
- Stereo speakers in overhead
- Cockpit docking control station built in on the starboard end of the counter
- Maxwell VWC 3500 vertical capstan 24V electric windlass warping winch in cockpit with foot button control
- Storage locker below deck with access for steering
- (2) Accu-steer HPU-150-24 hydraulic steering pumps

STERN BUSTLE

The stern bustle built in aft of the cockpit provides a large swim platform and dinghy landing deck. The 50-amp shore power utilizes a built in electric cord spooler. The voluminous bustle chamber adds great storage for extra gear. The bustle also houses the hydraulic stern thruster.

- Removable hand rails for dinghy landing
- Swim step rungs on transom
- Freshwater hot and cold shower
- Fortress XS – 85 anchor with 600' $\frac{3}{4}$ " braided line on stainless steel reel
- Stainless stern tie reel, with 500' of $\frac{1}{2}$ " float line
- Glendinning shore power retriever with 100' cord
- Shore power connections for Air con, 30-amp house and TV/phone

ENGINE ROOM

The engine room is a long, broad area with a seating area to starboard where you can view the machinery and keep in touch with the pulse of your ship. The Lugger L1276A, 12.5-liter electronic engine sits beautifully on center with the shrouded exhaust traveling aft before turning up to the exhaust stack. On the starboard side aft is the Lugger wing engine and hydraulic alternator. The fuel manifolds are forward to starboard for easy access and manipulation. There is also a fuel polishing manifold. On the port side forward is the fresh water system, followed aft by both generators. All the way aft to port is the upgraded hydraulic steering system and watermaker. A built-in sea chest delivers sea water to the various engines and pumps that require cooling. This is an engine room that is easy to manage, and you are low and centered while underway.

- Lugger L1276A, 12.5-liter turbo, 340 BHP@ 1,800 RPM continuous
- Twin Disc Power Commander Model EC-200 Control System (4) stations
- Keel cooler and dry stack exhaust
- Transmission - Twin Disc model with 2.95 to 1 reduction
- Main engine has dual Racor fuel filter in addition to engine fuel filter
- 3" stainless steel shaft

Nordhavn 62 Island Greeter

- Four blade propeller with Spurs line cutter
- Electronic controls with pilothouse operation and three outside stations – port and starboard Portuguese bridge and cockpit
- Generator: 8kW Northern Lights in stern bustle (with auto-start)
- Generator: 20kW Northern Lights
- Wing engine: Lugger LP445D rated at 85 HP
- Gearbox: ZF Marine U drive 2.5 to 1 reduction, shaft 1:5” stainless steel driving a Gori 3 blade feathering propeller
- Wing engine also has PTO for hydraulic pump which runs the bow thruster, the stern thruster, deck wash and the anchor windlass
- Sea chest offset to port for better access and fitted with two spare connections for future additions
- Deluxe hydraulic system by American Bow Thruster including:
 - 25 HP bow thruster with four control stations
 - 25 HP stern thruster with four control stations
 - Both thrusters operated with proportional controls
- 180 GPM emergency bilge pump to three compartments
- 180 GPM anchor wash system
- ABT active fin stabilizers – Model #254 with 9 square foot fins.
- Engine room floor finished with white fiberglass flooring
- Fuel manifolds are all stainless steel with transfer, supply and return manifolds serving all fuel tanks
- Fuel transfer/boost pump with separate Racor filter
- SeaFire automatic fire extinguisher upgraded to include emergency hand pull in saloon
- Sealand vacuum pump for head
- Back up vacuum “S” pump for the toilet system
- 50-gallon new oil tank
- 200 gallon used oil tank converted to diesel fuel supply for wing engine
- Perko bronze strainers instead of local made
- Oil transfer pump of 2.5 GPM capacity to change oil in the main engine, the wing engine and the generators

SAFETY - General

- Sea-Fire FE-241 auto/manual engine room fire suppression system
- Sea Fire self-actuating extinguishers forward and amidships bilge
- USCG safety package
- EPIRB
- Switlik SAR 6H TSD MK II six-person offshore life raft (out of service, needs re-packing)
- Engine room high water bilge alarm
- Hydraulic anchor wash valve for bilge pump
- Back up bilge water float switches
- Smoke detectors
- Lifesling in cannister

Nordhavn 62 *Island Greeter*

Nordhavn 62 *Island Greeter* Talk Through Tour



<https://youtu.be/3VADTtGLNSM>

Nordhavn 62 *Island Greeter* 360 Tour

Nordhavn 62 Island Greeter



<https://nordhavn62forsale.com/360-tour/>



ADDITIONAL BROKER COMMENTS:

Island Greeter is a US Coast Guard Documented vessel. Jeff was involved in the new build construction and has also completed brokerage sales of several Nordhavn 62's. The Nordhavn 62 design is a marvelous offshore passage maker. She provides a very safe, solid and smooth ride. **Island Greeter** has

Jeff Merrill Yacht Sales, Inc. © 2023 All Rights Reserved www.JMYS.com

Nordhavn 62 Island Greeter

been well cared and always given the best service. She has spent many summers exploring the Pacific northwest and is ready to head right back out to sea.

For additional information please visit *Island Greeter's* website: www.Nordhavn62ForSale.com

Exclusions: Potential purchasers should assume that items on the vessel at the time of viewing, but not specifically listed on this sheet, are not included with the sale of the yacht. These specifications are believed to be true and correct but cannot be guaranteed. Items excluded include, but are not limited to Paintings, tools, handheld nav gear and binoculars. Owner's personal effects and clothing will be removed prior to closing.

Disclaimer: Jeff Merrill Yacht Sales, Inc. presents the details of this vessel in good faith but cannot guarantee or warrant the accuracy of this information nor guarantee or warrant the condition of the vessel. Buyers should instruct their agents and their surveyors to investigate all details the buyers desire validated. This vessel is offered subject to prior sale, price change, or withdrawal without notice.

Brokerage: JMYS is a US based (licensed and bonded yacht brokerage in California, Florida and Washington) with an international emphasis specializing in ocean capable trawlers and recreational tugs. Our brokers are experienced boaters, most are trawler owner/operators with thousands of hours and miles at sea. We treat our clients with respect, we are responsive and not pushy. Our focus is to become your loyal advocate, always looking out for your best interests. The team at JMYS has extensive trawler and motor yacht product knowledge and our skills are available for coaching after the sale has concluded.

Co-Brokerage: Fellow yacht broker association members: *Island Greeter* is available for Co-Brokerage.

***Listing broker. Jeff Merrill, CPYB** (Certified Professional Yacht Broker) has extensive product knowledge of the trawler market plus direct experience with the Nordhavn 62 including being the original build salesperson for Island Greeter. Jeff joined the maiden voyage from Dana Point, CA to Anacortes, WA where she has called home ever since. Jeff is a familiar face to YouTube viewers and a regular presenter at TrawlerFest. He writes about trawlers for *Ocean Navigator* and *PassageMaker* magazines and is one of the online instructors for *Boaters University*.

This listing specification has been approved by the sellers for accuracy. The photos, images and descriptive content are copyrighted by JMYS and may not be copied or used without specific written permission. All inspections are by appointment only. Please contact listing broker, **Jeff Merrill, CPYB** by phone, text or email for additional information or to schedule your personal showing. Jeff is always available via Mobile (949) 355-4950 (call or text). You can send a detailed Email to: Jeff@JMYS.com.



Licensed and Bonded in California, Florida and Washington.

Skype: jeff.merrill | You Tube: Jeff Merrill Yachts | Twitter: @merrillyachts | LinkedIn: jeff.merrill

Jeff Merrill Yacht Sales, Inc. © 2023 All Rights Reserved www.JMYS.com

Nordhavn 62 Island Greeter

Facebook: Jeff Merrill Yacht Sales | Instagram: jeffmerrilljmys | Yacht Brokers Association of America |
International Yacht Brokers Association (Florida) | Northwest Yacht Brokers Association |
California Yacht Brokers Association – President 2015 and 2016

