

# **Kadey Krogen 48 *Wanderer's Rest***



# **JMYS**

Jeff Merrill Yacht Sales, Inc. | [www.JMYS.com](http://www.JMYS.com)  
4153 Country Club Drive | Long Beach, CA 90807

Florida address: Jeff Merrill Yacht Sales, Inc. | 3321 S.E. 14th Avenue | Ft. Lauderdale, FL 33316



## ***Wanderer's Rest***

**Price: \$885,000.00      Location: Charleston, SC**

Jeff Merrill Yacht Sales, Inc. © 2022 All Rights Reserved [www.JMYS.com](http://www.JMYS.com)

# **Kadey Krogen 48 *Wanderer's Rest***

## **INTRODUCTION:**

With her graceful sweeping lines, pronounced bow and rugged profile, you can tell just from her looks that ***Wanderer's Rest*** is an offshore capable yacht.

Very few trawlers are as ideally suited for extended cruising as the Kadey Krogen 48 North Sea design.

With “go anywhere” range, the 48 glides through the water and provides a true “at home on any sea” waterfront traveling platform just as her builder advertises.

Her second owners have enjoyed her for over eight years and now ***Wanderer's Rest*** is offered for sale in cruise-ready mode.

She has a popular widebody saloon/deck arrangement which merges forward through the galley and below to a spacious two stateroom, two head arrangement layout.

On deck she is topped with a raised pilothouse and flybridge for underway operations and enjoys good outdoor living space forward, aft and aloft.

Quiet and comfortable underway and at rest, she is up to the challenge of exploring local and long-distance cruising adventures.

After six years of ownership, the time has come to pursue other activities.

In October 2022 she was hauled out at Washburn's in Solomons Island, Maryland to complete a new bottom paint job and regular maintenance mechanical services.

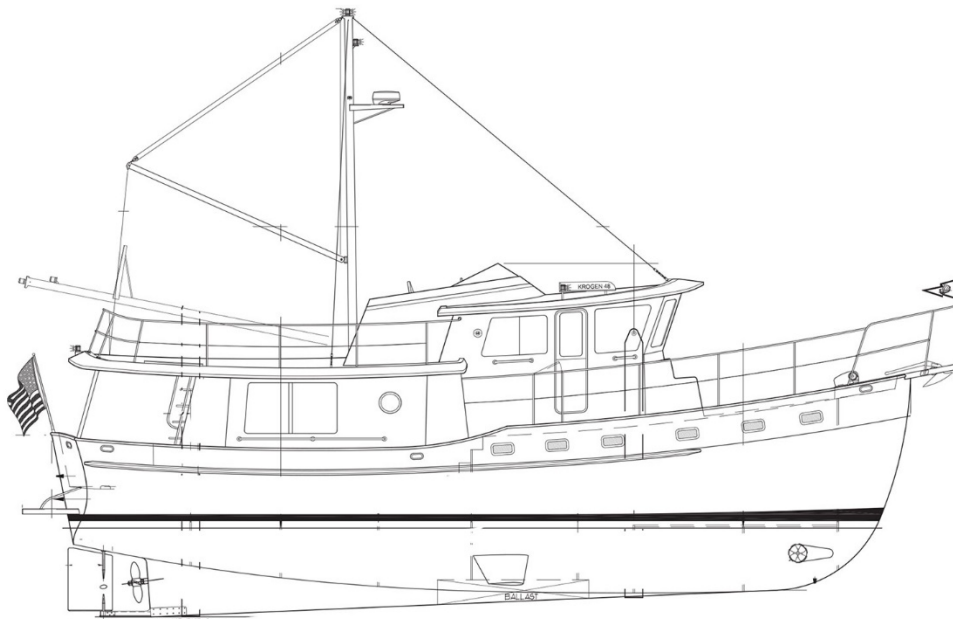

# Kadey Krogen 48 *Wanderer's Rest*

## LAYOUTS:

Boat deck, Flybridge, Pilothouse and Foredeck

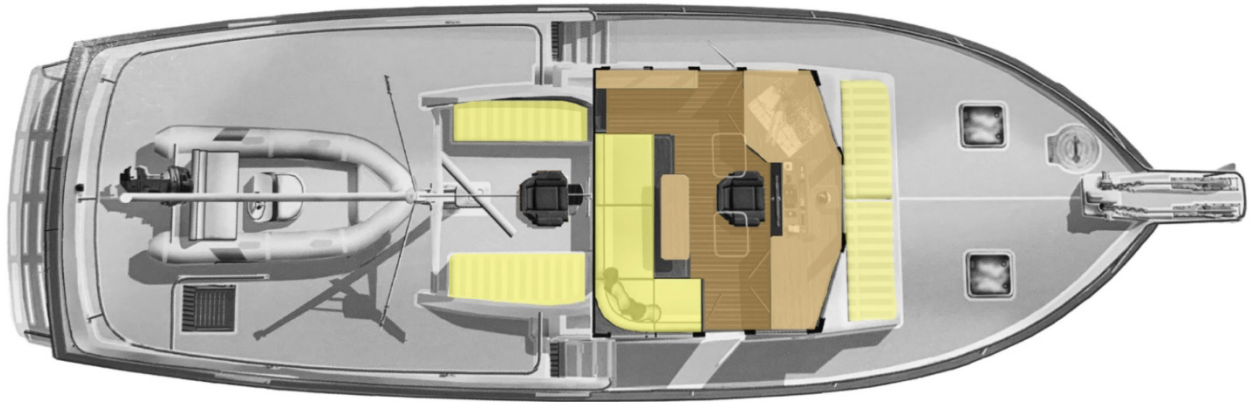

Saloon, Galley, Staterooms

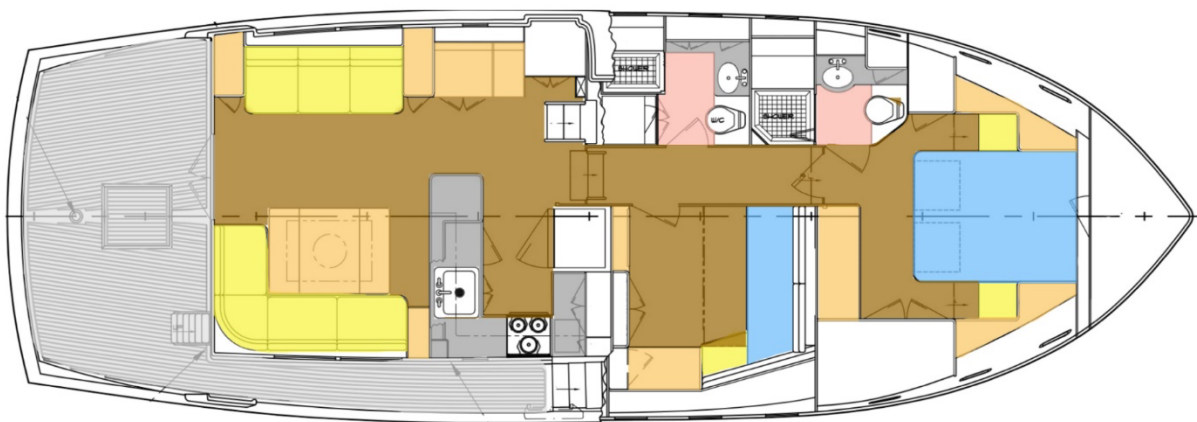

## SPECIFICATIONS:

<b>YACHT NAME:</b>	<b><i>Wanderer's Rest</i></b>
<b>BRAND AND MODEL:</b>	Kadey Krogen 48 North Sea (flybridge with Bimini top)
<b>TYPE:</b>	Long range passage maker with raised pilothouse
<b>LOCATION:</b>	Charleston, SC
<b>MODEL YEAR:</b>	2008
<b>HULL NUMBER:</b>	39
<b>HULL COLOR:</b>	White gelcoat   Blue whale and boot stripes   Red bottom paint
<b>REGISTRY:</b>	United States Coast Guard Documented
<b>DESIGNER:</b>	Jim Krogen
<b>BUILDER:</b>	Asia Harbor Yacht Builders Co., Ltd.
<b>HULL MATERIAL:</b>	Solid fiberglass
<b>DISPLACEMENT:</b>	56,450 lbs.   25.66 MT
<b>BALLAST:</b>	4,500 lbs.   2,045 KG (Lead)
<b>RANGE:</b>	3,020 miles @ 7 knots

Jeff Merrill Yacht Sales, Inc. © 2022 All Rights Reserved [www.JMYS.com](http://www.JMYS.com)

## Kadey Krogen 48 *Wanderer's Rest*

<b>SPEED:</b>	Cruise 7.5 to 8 knots. Top 9.0 knots
<b>LOA:</b>	53'   16.15 M
<b>LWL:</b>	45'5"   13.84 M
<b>BEAM:</b>	17'4"   5.28 M
<b>DRAFT:</b>	5'   1.52 M
<b>D/L:</b>	269
<b>A/B:</b>	2.6:1
<b>Cp:</b>	Prismatic Coefficient .60
<b>AIR DRAFT:</b>	29'0"   8.8 M to top of antennae (estimate)
<b>DECK:</b>	White deck with beige nonskid
<b>MAIN ENGINE:</b>	John Deere 6068 TFM75   225 HP (Main hours: ~5,756 (November 2022))
<b>TRANSMISSION</b>	Twin Disc model MG5061   3.0:1 reduction gear
<b>PROPELLER / SHAFT</b>	2.5" Aquamet 22 shaft   Four blade propeller   Spurs line cutter
<b>EXHAUST:</b>	Wet exhaust, Centek Vernalift muffler
<b>THRUSTER:</b>	TRAC/ABT 24V 12 HP bow thruster
<b>STABILIZATION:</b>	ABT TRAC 220 digital active fins
<b>ELECTRICAL:</b>	60 Hertz – US style - 50 amp
<b>SHORE POWER:</b>	50 amp (fore and aft)
<b>GENERATOR:</b>	Northern Lights 12 kW 240V 60Hz (Generator hours: ~2,719 November 2022)
<b>INVERTERS/CHARGERS:</b>	Two: (1) Magnum 2800-Watt inverter/charger   (1) Xantrex 3000-Watt inverter/charger
<b>BATTERIES:</b>	Lifeline AGM
<b>INTERIOR LIGHTING:</b>	Cantalupi lighting
<b>CLIMATE CONTROL:</b>	Cruisair air conditioning – reverse cycle   20,000 BTU in main saloon and pilothouse   12,000 BTU in owner stateroom   10,000 BTU for guest
<b>MACHINERY EQUIPMENT:</b>	Reverso oil changer for engine and generator   EST Total fuel management polish/transfer system
<b>WINDLASS:</b>	Maxwell HWC-2200 12V horizontal
<b>GROUND TACKLE:</b>	Rocna 40 lb. 250' 7/16" chain   Secondary Delta 88lb. 50' 7/16" chain with 150' 7/8" nylon rode   Spare Fortress anchor
<b>DAVIT/CRANE</b>	Marquipt 1000 electric davit
<b>TENDER AND OUTBOARD:</b>	2007 12' AB center console RIB   Yamaha 40 HP outboard
<b>NAV/COM BRANDS:</b>	Furuno   Coastal Explorer   Admiral   Raymarine   Standard Horizon
<b>ENTERTAINMENT:</b>	KVH Trac Vision Satellite TV   LG TV monitor
<b>STATEROOMS:</b>	Two: Owner stateroom (island berth)   Starboard guest stateroom (two single berths)
<b>BEDDING:</b>	Custom mattress in owner
<b>HEADS:</b>	(2) Vacuflush (freshwater)
<b>SHOWERS:</b>	(2) Owner and guest. Both with folding shower doors
<b>LAUNDRY:</b>	Bosch separate clothes washer and clothes dryer

## Kadey Krogen 48 *Wanderer's Rest*

<b>GALLEY:</b>	Force 10 propane (3) burner stove with propane oven   GE refrigerator   GE microwave convection oven   GE water purification   Koldfront wine cooler
<b>INTERIOR WOOD:</b>	Cherry - matte, semi-gloss finish
<b>INTERIOR COUNTERS:</b>	Corian counters
<b>INTERIOR UPHOLSTERY:</b>	Navy blue vinyl
<b>INTERIOR FLOORING:</b>	Parquet, covered with wool carpet
<b>BILGE PUMPS:</b>	Electric standard and electric highwater
<b>TANKAGE:</b> (approx.)	
<b>FUEL:</b>	1,000 gallons   4,546 L (Aluminum)
<b>HOLDING BLACK:</b>	100 gallons   378 L (Fiberglass)
<b>FRESH WATER:</b>	400 gallons   1,818 L (Stainless steel)
<b>ADDITIONAL EQUIPMENT:</b>	Stidd helm chair (Pilothouse)   Pompanette helm seat (flybridge)   Safe   Rod holders   Kahlenberg horns   (2) communication headsets   (2) folding bicycles   Raymarine CCTV cameras (engine room and stern)   PVC aft deck furniture
<b>SAFETY:</b>	Fireboy fire suppression in engine room   EPIRB on boat deck   Viking 6-person canister liferaft   ACR search light with controls at both helm stations   Loudhailer with fog signal   Marine Magellan alarm system   ACR ditch bag
<b>PHOTO DATE:</b>	Most photos taken September, 2022
	<b>Note: All information is believed accurate but should be verified.</b>

### ACCOMMODATIONS and LAYOUT:

#### COCKPIT AND SWIM PLATFORM

You can board *Wanderer's Rest* from the aft cockpit door via the swim platform (great when arriving by dinghy) or from the port cockpit or starboard side deck door. *Wanderer's Rest's* swim platform and cockpit also create a convenient hub for in-water sports such as diving or snorkeling. A recessed shore power cable (on electric spool) alongside fresh water taps connections are easily accessed on the cockpit starboard forward bulkhead against the house. Cockpit cap rails are Awlwood clear-coated, and the entire lower walking surfaces is decked with teak. There is also a wing door on the starboard side to deflect the breeze when enjoying the cockpit. From the cockpit you can head aft to the swim platform for a dinghy adventure, forward to starboard via the side deck which transits past the pilothouse and up to the foredeck, or straight ahead into the saloon.

- Fiberglass swim deck platform
- Stainless steel support staples
- Hot/cold freshwater cockpit shower
- Teak decking
- Starboard side deck wind door
- Shore power connections – 50 amp for house and air conditioning
- Glendinning shore retriever
- Covered overhead
- Access to lazarette below and starboard side deck forward

Jeff Merrill Yacht Sales, Inc. © 2022 All Rights Reserved [www.JMYS.com](http://www.JMYS.com)



# **Kadey Krogen 48 *Wanderer's Rest***

## **LAZARETTE**

There is a large opening hatch in the cockpit deck for entering the lazarette below. The lazarette houses the steering system and provides plenty of storage. You will find a lot of room to bring aboard your own requirements – imagine dive gear, water toys, and spares.

- Access to steering
- Storage space for items and gear

## **SALOON**

Two double welded aluminum weathertight doors with windows inset allow entrance into the saloon. ***Wanderer's Rest*** benefits from her widebody saloon (no walking side deck to port) so she boasts a much roomier and spacious interior than a double side deck edition. The saloon is carpeted wall to wall with Maslan 100% wool. The saloon aboard ***Wanderer's Rest*** creates a very open, airy, and pleasant environment for her owners and guests. For visibility, light and ventilation, there are large opening windows port and starboard as well as an opening window in the aft bulkhead.

To starboard is an L-shaped settee covered in navy blue vinyl that faces a teak wood hi-lo table that has the versatility to function as a coffee/cocktail table which can also lift and expand to a large dining table that will seat eight for meals. Forward of the settee is an end cabinet and entertainment center that houses a hidden LG flat screen television and Bose sound system.

To port are two leather Ekornes Stressless recliners and ottomans. Additionally, this area includes a beverage cabinet that houses a wine cooler, liquor storage as well as lockers and shelves. The engine room is accessed by a floor hatch forward in the sole.

- L shaped settee covered in navy blue vinyl
- Twin leather Ekornes chairs
- Parquet wood flooring
- Maslan 100% wool carpet
- LG flat screen TV
- Large windows
- Twin doubled welded aluminum entry doors
- Bose sound system
- Teak hi-lo table
- Brass analog barometer
- Brass analog clock

## **GALLEY**

The galley is forward of the saloon on the starboard side. It includes abundant food preparation space atop the Corian counters and there are multiple lockers and drawers for provisions, cook ware, utensils, etc. ***Wanderer's Rest*** has an impressive complement of GE appliances: full-size refrigerator/freezer, and convection microwave oven. There is a Force 10 (3) burner LPG stove with oven, and a large dual basin stainless-steel sink.

- GE microwave convection oven stainless steel
- GE refrigerator full size stainless steel
- Keurig coffee maker
- Koldfront wine cooler
- Force 10 3-burner propane stove and oven
- Corian counter tops

# **Kadey Krogen 48 Wanderer's Rest**

- Stainless steel double basin sink
- Spray head faucet
- Beveridge freshwater faucet

Moving forward from the galley you can go up to the pilothouse for underway operations and access to the decks, or down a short flight of steps to the lower-level living quarters which is comprised of two staterooms and two heads.

## **STARBOARD GUEST STATEROOM**

The guest stateroom is positioned to port on the accommodations level. There are twin single bunk beds (Jack and Jill stacking), as well as a desk with four drawers. There are two additional large drawers under the beds, and a hanging locker. Three opening portlights outboard. This room gives you flexibility for your overnight guests and is also a convenient long-range commissary for cruising as each bunk can serve as a huge storage shelf.

- Twin bunk beds
- Reading lights
- Working desk
- Drawers
- Bookshelves
- Three opening port lights

## **GUEST HEAD**

The guest head is across the hall to port from the guest stateroom. With independent door access, it is available for all passengers aboard. The single basin sink is below the mirrored vanity. The toilet is a fresh water Vacuflush. The standup shower has a bi-fold door and a built-in seat. The guest head also contains the stacked Bosch washer/dryer for onboard laundry requirements.

- Bosch brand clothes washer and clothes dryer
- Stand up shower with bi-fold door
- Fresh water Vacuflush toilet
- Corian countertop

## **OWNER STATEROOM**

The Owner stateroom is forward and features a queen-size island berth. This room enjoys full beam accommodations and is set up for comfort and convenience. Storage throughout is impressive. There are three hanging lockers, twelve large drawers and the bed lifts up to provide access to a large compartment under the berth. There are four stainless steel opening portlights and two overhead hatches giving plenty of light and ventilation.

- Walk around island queen bed
- Twelve large drawers
- Underbed storage
- Three hanging lockers
- Four stainless steel opening portlights
- Two overhead hatches
- Mirror and lights above bureau drawers

# **Kadey Krogen 48 *Wanderer's Rest***

## **OWNER HEAD**

To port, there is an en-suite head with sink counter, mirrored medicine cabinet above, Vacuflush freshwater toilet, stand up stall shower with bi-fold door and molded seat.

- Private en-suite head
- Corian countertop
- Freshwater Vacuflush toilet
- Standup shower with bi-fold doors
- Mirrored medicine cabinet

## **PILOTHOUSE**

Forward and up from the saloon/galley area is the raised pilothouse, the operations and command center of ***Wanderer's Rest***. She is outfitted for long distance offshore travel and is equipped with the priorities for safe and efficient piloting. The arrangement of displays and controls has been planned for quick glances and easy reach from the helm. Guests can enjoy the view behind the helm and facing forward from the large and comfortable L-shaped settee. This settee also converts to a double berth when needed. There are heavy, welded aluminum Dutch weathertight doors port and starboard providing easy access to the side decks. There are large opening windows port and starboard and two stainless steel opening ports in the aft bulkhead. The large reverse raked windows allow an incredible view forward.

- Stidd helm chair
- Furuno radar
- Simrad autopilot
- (2) Nauticomp monitors
- Coastal Explorer and Admiral 10 navigation software and computer
- Raymarine monitor with CCTV cameras in engine room, flybridge, and stern
- Raymarine ST60+ depth/speed
- Raymarine ST60+ wind instruments
- (2) Standard Horizon VHF radios
- ACR point pad for search light
- Forward facing L-shaped settee that converts to double berth
- Welded aluminum Dutch doors leading to side decks
- Overhead lighting

## **FOREDECK**

The ground tackle includes a Maxwell horizontal windlass with a 40 lb. Rocna and 250' of 7/16" chain. The bow pulpit secures two separate anchors on individual rollers. The secondary anchor is a 88 lb. Delta with 50' of 7/16" chain and 150' of 7/8" rode. There is also a spare Fortress anchor aboard. Shore power connections and both fresh and seawater washdown provide extra convenience in this area. The deck is uncluttered with two opening hatches above the Owner stateroom. Forward of the pilothouse windows is a built-in seat locker area with cushions (faded) that provide a great place to relax at anchor or underway in the right conditions.

- Maxwell HWC-2200 horizontal windlass
- 40 lb. Rocna primary
- 250' of 7/16" chain primary
- 88 lb. Delta secondary
- 50' of 7/16" chain and 150' of 7/8" rode secondary

Jeff Merrill Yacht Sales, Inc. © 2022 All Rights Reserved [www.JMYS.com](http://www.JMYS.com)



# **Kadey Krogen 48 *Wanderer's Rest***

- Shore power connections – 50 amp for house and air conditioning
- Sea water washdown
- Fresh water washdown
- Courtesy lights
- Non-skid surface
- Forward facing seating below pilot house windows

## **BOAT DECK**

The AB dinghy and Yamaha outboard are stowed on the boat deck landing which is above the cockpit/saloon and behind the pilothouse. You can access this area from the port side of the pilothouse up a short ladder with teak treads. With the dinghy launched, you have a tremendous deck area available to enjoy. Two folding bikes are included with **Wanderer's Rest**.

- 12' AB dinghy – inflatable sponsons, fiberglass hull
- Yamaha 40 HP outboard
- Two folding bikes
- Marquipt 1000 electric crane
- Non-skid surfaces
- Stainless steel safety rail

## **FLYBRIDGE**

The flybridge features a centerline helm captain's chair, and passenger lounge seating running along both sides. For underway operations you have easy reach access to the chart plotter, auto pilot, bow thruster controls, and dual VHF radios. This is a similar arrangement comparable to the primary helm below, providing just as much vessel control as the pilot house. The flybridge is a wonderful place to cruise underway or relax at rest during those warm, sunny days on the water.

- Pompanette centerline helm chair
- Molded in lounge seating on either side of helm chair
- Dual Standard Horizon VHF radios
- Simrad autopilot
- Furuno NavNet chartplotter
- Bow thruster controls
- Raymarine ST60+ depth/speed
- Raymarine ST60+ wind instruments
- Greemarine monitor
- ACR point pad for ACR search light
- Propane locker under seat (two five-gallon tanks)

## **ENGINE ROOM**

The large opening hatch forward in the saloon welcomes you to a very practical and well laid out engine room. The John Deere main engine can be serviced on all sides. ABT TRAC hydraulic stabilizers are installed forward and outboard. Racor fuel filters for the main engine and generator are positioned for easy access and this machinery space. There is also an ESI Fuel polishing system to insure clean diesel fuel delivery. Oil changes have been regularly conducted using the Reverso oil change system. Clean oil is supplemented by the secondary off engine oil filter. **Wanderer's Rest** comes equipped with multiple spare parts and tools.

- John Deere 6068 main engine

Jeff Merrill Yacht Sales, Inc. © 2022 All Rights Reserved [www.JMYS.com](http://www.JMYS.com)

# **Kadey Krogen 48 *Wanderer's Rest***

- ABT TRAC active fin stabilizers
- Reverso oil change system
- ESI fuel polishing
- Racor fuel filters
- Secondary off engine oil filter
- Phase Three charger
- Several tools and spare parts included
- Bright engine room lighting

## **PROPULSION**

Main Engine: John Deere model 6068TFM50 diesel producing 225 HP @ 2600 rpm direct drive with Twin Disc transmission.

Performance: Cruising Speed: 8 knots Cruising Speed at 1800 RPM.

Cruising Range: 1,450 nautical miles @ 9 knots. 2,000 nautical miles @ 8 knots. 2,550 nautical miles @ 7 knots. 3,000 nautical miles @ 5 knots.

## **ADDITIONAL BROKER COMMENTS:**

The Kadey Krogen 48 North Sea is rugged looking and has an appropriate stature with a tall bow that will cleave the waves and offer a dry ride in most sea conditions. ***Wanderer's Rest*** has been optimized and cared for to be enjoyed as a comfortable getaway platform. Thank you for reviewing these materials to better understand what she has to offer. We invite you to get in touch so that we may coordinate arrangements to get you aboard.

For additional information please visit ***Wanderer's Rest*** website: [www.KadeyKrogen48ForSale.com](http://www.KadeyKrogen48ForSale.com)



## **Kadey Krogen 48 Wanderer's Rest**

**Exclusions:** Potential purchasers should assume that items on the vessel at the time of viewing, but not specifically listed on this sheet, are not included with the sale of the yacht. These specifications are believed to be true and correct but cannot be guaranteed. Items excluded include, but are not limited to paintings, tools, handheld nav gear and binoculars. Owner's personal effects and clothing will be removed prior to closing.

**Disclaimer:** Jeff Merrill Yacht Sales, Inc. presents the details of this vessel in good faith but cannot guarantee or warrant the accuracy of this information nor guarantee or warrant the condition of the vessel. Buyers should instruct their agents and their surveyors to investigate all details the buyers desire validated. This vessel is offered subject to prior sale, price change, or withdrawal without notice.

**Brokerage:** JMYS is a US based (licensed and bonded yacht brokerage in California, Florida and Washington) with an international emphasis specializing in ocean capable trawlers. Our brokers are experienced boaters, most are trawler owner/operators with thousands of hours and miles at sea. We treat our clients with respect, we are responsive and not pushy. Our focus is to become your loyal advocate, always looking out for your best interests. The team at JMYS has extensive trawler and motor yacht product knowledge and our skills are available for coaching after the sale has concluded.

**Co-Brokerage:** Fellow yacht broker association members: This listing is available for co-brokerage and JMYS is a 50/50 house. Courtesy showings are available by appointment. Florida listings subject to appropriate broker licensing required by law.

**Listing broker. Mark Pittman** is a trawler owner and lifelong boating enthusiast. Mark is a dedicated trawler specialist who is not only knowledgeable about boating, but a true people person. Mark is dedicated to assisting his clients and sharing with them the joys of the trawler lifestyle.

Please contact listing broker, **Mark Pittman**, by phone, text or email for additional information or to schedule your personal showing. Mark is available via Mobile + 1 803.320.3586 (call or text). You can send a detailed Email to: [Mark@JMYS.com](mailto:Mark@JMYS.com).

