

Nordhavn 40 *Amarok*



JMYS

Jeff Merrill Yacht Sales, Inc. | www.JMYS.com
4153 Country Club Drive | Long Beach, CA 90807

Florida address: Jeff Merrill Yacht Sales, Inc. | 2650 W State Road 84, Suite 103 | Ft. Lauderdale, FL 33312



Amarok

Price: \$525,000.00

Location: San Diego, CA

Nordhavn 40 Amarok

Amarok is a standout among the Nordhavn 40 series, one of the smallest yet most capable passage makers built by Pacific Asian Enterprises. This full displacement trawler has safely and comfortably carried its solo captain from the Chesapeake Bay in Virginia to San Diego, California.

Key features that enhance *Amarok's* performance and safety include a comfortable flybridge and a comprehensive suite of electronics, including a FLIR night vision camera. While underway, the NAIAD stabilizers and proactive monitoring systems make for a smooth passage. Notably, *Amarok* is one of the few Nordhavn 40s equipped with a mast tabernacle, reducing its height from 32 to 18 feet for easier bridge clearance when on inland passage navigation.

Whether crossing oceans, cruising along beautiful shores or exploring inland waterways, **Amarok** stands out as a solid, stable vessel. It offers an efficient combination of economy, size, and comfort.

Amarok is a first-generation Nordhavn 40, hull number 32 of the 44 produced in California by the renowned cruising sailboat builder Pacific Seacraft.

SPECIFICATIONS

YACHT NAME:	AMAROK
BRAND AND MODEL	Nordhavn 40 Hull Number 32 Long range trawler yacht with raised pilothouse and flybridge
LOCATION	San Diego, California
MODEL YEAR	2002
COLOR	Hull: Grey Deck: White
REGISTRY	United States Coast Guard Documented
BUILDER	Pacific Seacraft - Fullerton, California USA
HULL MATERIAL	Solid fiberglass
DISPLACEMENT	50,000 LBS. 22.68 MT
BALLAST	4,000 LBS. 1.82 MT
SPEED	Cruise: 7.0 knots at 1500 RPM. Top speed: 8 knots at 2100 RPM WOT=2400 RPM
RANGE	2,500 Nautical miles at 6.0 knots
LENGTH OVER ALL	39'9" 12.12 M
LENGTH WATER LINE	35'5" 10.79 M
BEAM	14' 6" 4.42 M
DRAFT	5'6" 1.7 M
AIR DRAFT	Approximately 32' 9.75 M with mast up. 18' 5.49m Mast down
ENGINE	Single Lugger model L668D 105 BHP (Hours~ 5556, August 2024)
TRANSMISSION	Twin Disc MG-55050 transmission 3.0:1
PROPELLER/SHAFT	2" stainless steel shaft 4 blade bronze propeller

Nordhavn 40 Amarak

WING ENGINE	Yanmar model 3GM30FV24 BHP (Hours ~100 August 2024)
BOW THRUSTER	Side Power 8 HP electric
STABILIZATION	Naiad 174 Multisea II Hydraulic
ELECTRICAL	60 Hertz – US style – 30-amp
SHORE POWER	(1) 30-amp for house (1) 30-amp for air conditioning Mid-ship connection
GENERATOR	Northern Lights 8kW generator with sound shield (~4723 hours August 2024)
INVERTER/CHARGER	Magnum MS2812 120AC 12VDC 118W Spare unit purchased in 2024
INTERIOR LIGHTING	Low voltage LED
CLIMATE CONTROL	Marine Air reverse cycle HVAC: 44,000 BTU (3) compressors (Saloon unit replaced 2019)
MACHINERY EQUIPMENT	Reverso oil changer for main and generator Racor Duplex for main Walbro fuel transfer pump with Racor filter
WINDLASS	Maxwell VC2200 vertical 12V electric windlass with gypsy and capstan
GROUND TACKLE	35 KG Buegel anchor with 400' 3/8" HT chain
MAST AND BOOM	Forespar mast and boom for dinghy with electric winches. New lines and cable 2022, new winches 2022
TENDER AND OUTBOARD MOTOR	Highfield CL310HY 10'5" aluminum hull, inflatable dinghy with seat and steering console 20HP Tohatsu outboard with electric start and tilt Dinghy and outboard new 2019
NAV/COM BRANDS	Simrad Raymarine ICOM FLIR Vesper Marine
ENTERTAINMENT	26" ACER TV with DVD in Saloon 22" Proscan TV in owners' cabin Bluetooth speakers throughout
STATEROOMS	(2) staterooms: Owner forward, Guest to port
BEDDING	Owner: Custom queen mattress Guest: To port amidship with twin lower and single upper with custom mattresses
HEAD	One: Raritan Marine Elegance freshwater electric flush toilet
WATER MAKER	Watermakers, Inc. Model ISL 700 37 GPH
LAUNDRY	Splendide model WD2100XC combo washer/dryer, vented
GALLEY	Princess 3-burner LPG stove with oven Vitrifrigo 2-drawer refrigerator Vitrifrigo 2-drawer freezer GE Microwave oven Breville convection oven
INTERIOR WOOD	Teak
INTERIOR COUNTERS	Corian
INTERIOR UPHOLSTERY	Ultraleather
INTERIOR FLOORING	Teak and Holly hardwood in Saloon (refinished 2024) and Lower Hallway, Owners and Guest cabins (carpet 2024) Lonseal in Pilothouse and Galley Fiberglass non-skid in head
BILGE PUMPS	(1) Jabsco electric pump forward engine room bilge Whale Gusher electric aft engine room bilge (2023) (1) Edson manual pump
TANKAGE: (approx.)	

Nordhavn 40 Amarak

FUEL	920 gallons 3,482 liters (Two fiberglass tanks)
HOLDING BLACK	68 gallons 257.5 liters (One fiberglass tank)
FRESH WATER	220 gallons 833 liters (One fiberglass belly tank, Two plastic tanks port and starboard)
SAFETY	Fire Boy engine room fire suppression system (serviced 2022) (5) BCI handheld extinguishers USCG safety package EPIRB (2022) Viking RescYou Pro 4-person offshore life raft repacked 2022 Engine room high water bilge alarm Co2 alarm Smoke alarm
PHOTO DATE	Most photos taken August 2024
Note: All information is believed accurate but should be verified.	

LAYOUT: Raised Pilothouse

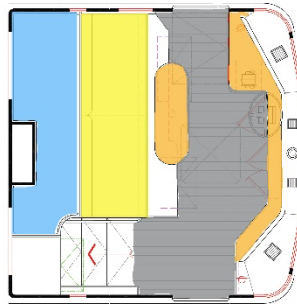

LAYOUT: Main and Lower Deck – Saloon, Galley Head and Staterooms

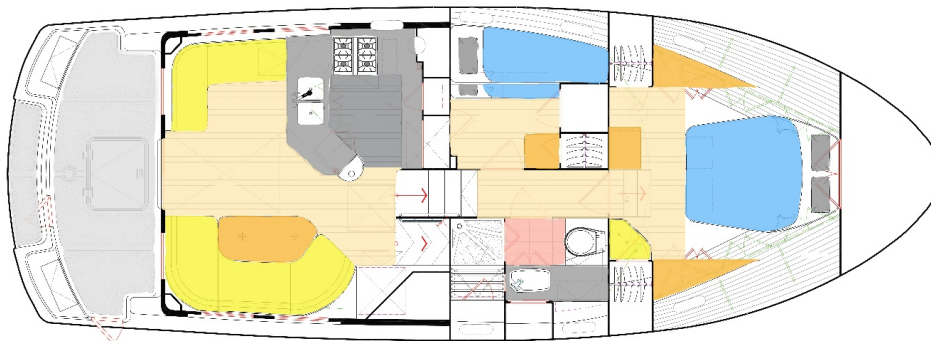

Nordhavn 40 *Amarok*

DESCRIPTION

Cockpit

Upon boarding *Amarok*, you'll immediately appreciate the spacious aft cockpit. This area offers a secure and protected space where you can relax, engage in fishing, or easily access the water through the swim platform and swim ladder. The boat deck partially extends over the cockpit, providing a blend of sun and shade. There are two molded-in seats located aft, with the starboard seat locker offering convenient storage and the port seat locker dedicated to propane tank storage. The lazarette is accessible through a generously sized hatch situated in the center of the cockpit floor, while the saloon is conveniently reached through a hinged centerline Dutch door raised to prevent water entry.

- Swim platform
- Swim ladder
- (2) fuel fills
- Boarding gate from swim platform to cockpit
- Salt water and freshwater wash down spigots
- Propane locker aft (2) 20 lb. tanks
- Emergency tiller deck plate access
- Hawse pipes with cleat horns for line handling
- Large fiberglass hatch for access to the lazarette

Lazarette

Access to the lazarette is available through a floor hatch in the cockpit. The inverter/charger, hot water tank, stern thruster, auto pilot, and battery banks are all located here. The lazarette also includes an emergency tiller and a spare anchor. This spacious area is ideal for storing additional supplies and gear.

- Magnum MS2812 inverter/charger | Spare MS2812 purchased 2024
- Concealed battery bank under forward bulkhead hinged lid step
- Whale Gulper electric bilge pump
- Watermakers Inc, Model ISL 700 reverse osmosis 37 GPH water maker
- Hydraulic steering ram
- Raymarine autopilot
- Seward 10-gallon hot water tank
- Fresh water accumulator tank
- Swim ladder
- Emergency tiller
- Locking rod from engine room to secure cockpit hatch

Saloon

Nordhavn 40 Amarok

Entering **Amarok** through the Diamond SeaGlaze weather tight door, you will find yourself in the saloon. *Amarok's* saloon arrangement includes a 6-person starboard settee, a 2-person port settee, and a 32" flat screen TV. The settee cushions are covered in white Ultra-leather. An adjustable teak table is movable. Air conditioning is provided by a 12,000 BTU Dometic reverse cycle AC.

- Teak and holly flooring that was refinished in 2024
- Movable High/Low teak table with folding leaves
- Slide windows with screens
- Teak magazine storage rack
- Teak book storage shelves
- 32" TV with DVD in Saloon Adjustable blinds on all windows
- Fusion stereo with marine-grade stereo speakers
- Controls for air conditioning
- Ship's clock and barometer

Galley

Moving forward on the same level as the saloon connects you to the galley portside. The beautiful teak faced column that provides delivery of the main engine dry stack exhaust creates a natural divide while retaining an open-air feeling. A new microwave oven (stainless surface) with an exhaust fan has also been installed. This is a functional galley with Corian counters, teak lockers and drawers and two opening portlights outboard. On the aft counter is a large stainless-steel sink with a Grohe faucet. There is a Seaward Princess three-burner propane stove and oven with broiler and overhead fan. The galley creates an intersection with two choices, you can go down the centerline hallway to reach the head and staterooms or continue up a few short steps to the pilothouse.

- Vitrefrigo 110V/12V 2-drawer refrigerator
- Vitrefrigo 110V 2-drawer freezer in cabinet to starboard opposite galley
- Seaward Princess three-burner propane stove and oven with broiler
- GE microwave oven with exhaust fan
- Broan trash compactor with teak face
- Large basin stainless steel sink
- Multiple teak drawers, lockers and overhead cabinets for storage
- Teak spice rack
- Teak paper towel rack
- Corian countertops
- Lonseal raised coin vinyl flooring
- Two opening portlights outboard

Pilothouse

The Pilothouse is accessed a few steps up from the entry level. The view from the pilothouse is outstanding - you are surrounded by windows looking forward, outboard and aft. There are Dutch Doors outboard to port and starboard for easy outside deck access. The navigation equipment was upgraded in 2018/2019 and includes a full suite of Simrad electronics complete with touchscreen control and with all

Nordhavn 40 Amarok

chart software up to date. There is a stainless-steel wheel with a well laid out dash area fitted with all of the electronics control screens smartly positioned above and below the forward windows. The electrical panel breaker is behind a clear door cabinet to starboard. On the horizontal dash you have the main engine and wing engine control levers. On the vertical face there are controls for the bow thruster, anchor windlass, horn, wipers, etc. All the primary ships systems are monitored from this raised pilothouse including controls for the watermaker, generator, inverter and air conditioning systems. The aft section has a watch berth, and a large sofa settee fronted by a custom, adjustable teak table making this an easy place to run the vessel or as a shipside office when in port.

- Two 12" Simrad NSS EVO3 MFD with remote Wi-Fi connections (2019)
- Two 7" Simrad NSS EVO3 MFD with remote Wi-Fi connections (2019)
- Simrad Halo 24 Radar (2024)
- FLIR MS232 Night Vision Camera
- NMEA 2000 networked NEP-2 switching installed (2019)
- Analog to digital instrument converter installed (2019)
- Seven (7) CCTV cameras covering Stern and key engine room function – (2020)
- Dedicated OptiPlex computer and 13" screen running Coastal Explorer with NMEA 2000 interface (2019)
- New In-hull transducer installed (2019)
- Thru-hull Airmar Speed /Temp Transducer (2019)
- ICOM M506 NMEA 2000/AIS VHF Radio with hailer (2020)
- ICOM M502 NMEA 182 VHF Radio
- Ritchie Compass
- Raymarine 6001+ Autopilot with remote; Simrad Autopilot Computer for future upgrade.
- NAIAD stabilizer Multisea II control panel (2019)
- Bow thruster joystick control
- Maxwell anchor windlass control
- Magnum inverter /battery charger control
- Northern Lights genset monitor panel
- Marine Air air-conditioning and heat controls
- Large stainless-steel destroyer steering wheel
- Ultraleather bench helm seat
- Adjustable teak table in seating area
- Storage below foot landing
- Ultraleather watch berth
- Folding chart table outboard to port.
- Diamond SeaGlaze Dutch doors port and starboard
- Hynautic hydraulic steering
- Opening and screened side windows port and starboard
- Textilene window covers (two sets included)
- Generous storage underneath steps leading up to pilothouse

Nordhavn 40 *Amarok*

Down a few short steps in the center of the vessel, a wide hallway connects the upper entry level with the staterooms and head below. This entire lower level floor is carpeted except the head which has a gelcoat/fiberglass sole with non-skid.

GUEST STATEROOM

The guest stateroom is located midship and port side of *Amarok* and features two stacked bunks with engine room access along the aft bulkhead. The upper bunk is fixed, while the lower bunk can be pulled out for a wider sleeping area. Storage is available with two pull-out drawers beneath the lower bunk; one of which yields access to the port side stabilizer. Lighting includes overhead lights and reading lights by each bunk, and ventilation is provided by two portlights. The stateroom also includes a locker with a louvered door for the Splendide laundry appliance, alongside a hanging locker.

- LED overhead lighting
- (2) Halogen reading lamps
- Splendide washer dryer combo (vented)
- Hanging locker
- Diamond SeaGlaze dogged door to engine room
- Marine Air Systems 16,000 BTU air conditioning (shared with owner stateroom)
- (2) Portlight
- Bunk berths while lower bunk extends with filler

ENGINE ROOM

The engine room can be accessed through a door in the guest stateroom or through the saloon floor. It is designed for easy inspection and maintenance of all systems. The main engine is an efficient and reliable Luger LP668, keel cooled and equipped with a Twin Disc transmission. Here is also where the Northern Lights 8kW generator, and Yanmar 3GM30 Wing engine are housed. The hull has molded maintenance strakes for added headroom around the engine. Fuel is stored in fiberglass tanks with sight glasses, and a central tank in the bilge. Fuel is filtered by dual Racor 900 filters for the main, and a Racor 500 filter for the generator. There is a fuel pump and dedicated Racor 900 filter for transferring fuel between tanks.

- (2) Fiberglass fuel tanks with inspection hatches
- Gravity drain fuel system to an aluminum manifold tank (new in 2024) with water in fuel alarm and sump drain
- Spurs line cutter (2018)
- Cutlass bearing (2024)
- Fresh water pump and strainer Shurflo freshwater pump (with spare)
- Naiad active fin stabilizer reservoir (upgraded to Multisea II in 2019)
- Jabsco stabilizer cooling pump (2023)
- 10-gallon aluminum day tank with sight glass for wing engine
- Engine room blower (stack blower added in 2022)
- Racor 500 primary filter for genset
- Racor 900 for fuel transfer with Walbro pump and timer

Nordhavn 40 Amarak

- Jabsco electric bilge pump
- Ultra switch sensor for high water bilge pump
- Edson manual bilge pump
- (7) Closed circuit TV cameras (2020)
- All engine room lighting (110V and 12V) upgraded to LED (2019)

Head and Shower

The head aboard **Amarok** is located right across the companionway from the guest stateroom. The head features a separate enclosed shower, an electric head, vanity, and a medicine cabinet. The granite countertop has a built-in sink, adding to the head's luxurious feel. For air circulation, two screened portlights can be opened, and there is an exhaust fan in the shower area.

- Mirror in teak framed cabinet with locker doors above sink
- Two opening screened portholes – one in shower one in head
- Separate full headroom stall shower enclosure with tempered glass door
- Teak grate shower seat
- Access to starboard active fin stabilizer under shower seat
- Exhaust fan in shower overhead
- Whale Gulper sump pump for shower water discharge
- Raritan Marine Elegance electric freshwater head with smart controller and complete replacement kit for all components
- Waste lines replaced with Trident Premium hose
- Y-valve to holding tank or overboard
- Tank Watch holding tank monitor

Owner's Stateroom

The owner's stateroom aboard **Amarok** is located below the foredeck with a prominent island berth for maximum comfort. Beneath the mattress, there is access to the bow thruster and a separate house battery bank that powers the bow thruster and windlass. This space also serves as an excellent storage location. With a large hatch overhead, opening portlights outboard, and two round portlights aft in the Portuguese bridge, the owner's stateroom is well-ventilated. The interior hull sides have stylish varnished teak ceilings, and two locker doors at the forward give easy access to the chain locker. All cabinetry and furniture, including overhead lockers, drawers, and hanging lockers, are made of premium teak wood. The built-in changing seat with an Ultra-leather cushion adds to the room's comfort.

- Centerline queen berth with Zeno custom mattress (2020) and storage underneath
- Two large cedar-lined hanging closets with lights
- Teak bureau with drawers
- Overhead teak lockers along berth on both sides
- Air conditioning and heat controls
- ProScan TV with DVD mounted aft
- Overhead hatch with insect screen
- Two oval opening screened portlights outboard on each side (with deadlights)

Nordhavn 40 Amarak

Boat Deck

The large boat deck stows the athwartship mounted Highfield 10'5" aluminum-hull inflatable dinghy powered by a 20 HP Tohatsu outboard with electric start (new in 2019). The dinghy is launched via remote controls for the electric winches mounted on the boom. New lines and cables were installed in 2018, and new winches (2) were installed in 2022. Weaver removeable jack stands and tie downs for securing the tender. There is a large fiberglass deck box mounted forward to port. The Viking life raft is mounted to starboard on the stainless-steel railing

- Garmin navigation with transducer for dinghy (2019)
- Forespar mast and boom for dinghy (new lines and cable 2022, new winches in 2022)
- Viking RescuYou Pro 4-person offshore life raft (Repacked 2022)
- Large dock box mounted port side
- Stainless steel fender holder
- Secondary engine room exhaust fan in stack (2022)

Flybridge

The Flybridge is atop the pilothouse which places you up high with an unrestricted 360-degree view. There are two helm chairs providing a comfortable perch. Overhead is a framed Bimini and atop that is a series of solar panels braced on a stainless framework. Primary navigation and communication electronics are repeated.

Foredeck and Exterior

Traversing *Amarok's* Portuguese bridge and through a gate to starboard is her foredeck. The foredeck features molded storage, anchor well, red LED courtesy lights, fresh water washdown, and raw water washdown. The ground tackle consists of a 35 KG Buegel anchor with 400 feet of 3/8 inch chain and is managed by a Maxwell windlass. Tall stainless-steel safety railings provide a secure way to view the dolphins dancing in the bow wake while underway.

- Deck superstructure is white gelcoat, and deck is molded gray nonskid gelcoat
- Portuguese Bridge with recessed storage lockers
- Maxwell VM 2200 electric windlass with capstan
- Anchor chain bale roller
- Windlass controls at foredeck, pilothouse and flybridge
- 35 KG Buegel anchor with 400' 3/8 HT chain
- Chain roller fairlead for anchor chain
- Mantus anchor snubber
- Dock lines and fenders
- Four-step removable boarding ladder for swim platform
- Aluminum painted mast and boom
- Mast has a tabernacle at the base for lowering

Nordhavn 40 Amarak

Electrical: General summary

- Northern Lights 8 kW generator with sound shield
- Magnum MS2812 inverter/charger with smart controller and advanced remote battery monitoring kit (2019)
- All batteries enclosed in FRP boxes with strap-down lids (2019)
- Smart shore power outlets amidships on starboard side
- 30-amp shore power cord for house
- 30-amp shore power cord for air conditioning
- 12V DC, 110V AC
- LED lighting upgrade
- Galvanic isolator
- Copper bonding system
- Balmar 160-amp alternator with Balmar Max Charge regulator
- 730-watt LG solar system with (2) LG 365 watt panels, Victron MPPT controller with Bluetooth, wireless battery monitors on both forward and aft battery banks

Safety

- Fireboy engine room fire suppression system with pull cable
- Viking 4-person Life raft
- EPIRB
- Two throwable life rings with automatic crew overboard marker lights mounted into deck outboard of pilothouse
- Air horn
- Engine room high water bilge alarm
- Required US Coast Guard placards and equipment – current dates
- Offshore automatic inflatable lifejackets (4)
- Recreational automatic inflatable lifejackets (2)
- PFD Type I lifejackets

Nordhavn 40 Amarok

Non-Routine Maintenance & Upgrades:

New Helm Seats	Flybridge	May-21
New Boom Winches	Boat Deck	April-22
Replaced Exhaust elbow	Generator	May-22
Replaced Port NAIAD Cylinder	Propulsion	May-22
Repacked Life raft	Safety	May-22
New Bilge Pump in Lazarette	Bilge Pump	May-22
Replaced Exhaust Elbow	Wing Engine	August-22
New Lithium Batteries (3ea. 206 Ah)	Electrical	October-22
Replaced Hydraulic Cylinder	Navigation	July-23
Replaced Hydraulic Steering Pump	Navigation	July-23
Replaced Diesel Feed Tank	Fuel	January-24
Replaced Primary Alternator	Electrical	February-24
Replaced Secondary Alternator	Electrical	February-24
Pettit Odyssey Bottom Paint	Bottom	May-24
Replaced All Zincs	Bottom	May-24
Solar Panels (2 * 390 watts)	Electrical	May-24
Smart Plugs Outlets	Electrical	May-24
Spare Magnum 2812 Inverter/Charger	Electrical	May-24
Flir Night Camera	Electronics	May-24
Simrad Halo 24 Radar	Electronics	May-24
Bimini Cover / Replacement	Flybridge	May-24
New Fresh Water Pump	Fresh Water	May-24
Mantus Anchor Bridle with Claw	Ground Tackle	May-24
New Round Fenders	Ground Tackle	May-24
Hull Wash and Wax	Hull	May-24

Nordhavn 40 Amarak

Replaced Cutless Bearing	Propulsion	May-24
Replaced NAIAD Stabilizer Seals	Propulsion	May-24
Replaced Bow Thruster Propellers	Propulsion	May-24
New Black Water Pump	Waste	May-24
Replaced Transmission Oil Pump	Propulsion	May-24
Racor Fuel Filter for Generator	Fuel	May-24
Main Cabin Carpet	Cabin	May-24
Guest Cabin Carpet	Cabin	May-24
Replaced NAIAD Solenoid	Propulsion	June-24
Replaced NAIAD Starboard Cylinder	Propulsion	July-24
Varnish Saloon Floors	Saloon	July-24
New 30Amp Shore Power Cables	Electrical	July-24
New Dinghy Fuel Tank	Fuel	July-24

Detailed maintenance records confirming pride of ownership are available for review by request.

All manuals and logbooks have also been digitized for easy reference.

Nordhavn 40 Amarak

EXCLUSIONS

Potential purchasers should assume that items on the vessel at the time of viewing, but not specifically listed on this sheet, are not included with the sale of the yacht. These specifications are believed to be true and correct but cannot be guaranteed. Items excluded include, but are not limited to; paintings, books, personal items in lockers and drawers*, Scuba diving gear, fishing rods and reels, SUP and paddle, loose items in lazarette that are not boat specific, tools, decorations in staterooms, bedspreads, comforters, bed pillows, all towels, kitchen supplies (pots, pans, dishes, silverware), antique nautical items and binoculars. *Owner's personal effects and clothing will be removed prior to closing.

DISCLAIMER

Specifications and details of this vessel are provided in good faith for informational purposes only. Details regarding the specifications, operating characteristics and condition of the vessel have been obtained from sources believed reliable, but the owner and brokers cannot guarantee or warrant the accuracy of this information or the condition of the vessel. Buyer assumes responsibility to verify all speeds, capacities, consumptions and other measurements contained herein and otherwise provided and agrees to instruct his/her agent or surveyor to confirm such details prior to purchase. Vessel is offered subject to prior sale, price and inventory changes and withdrawal from market without notice.

Brokerage

JMYS is a US based (licensed and bonded yacht brokerage in California, Florida and Washington) with an international emphasis specializing in ocean capable trawlers and recreational tugs. Our brokers are experienced boaters, most are trawler owner/operators with thousands of hours and miles at sea. The team at JMYS has extensive trawler and motor yacht product knowledge and our skills are available for coaching after the sale has concluded.

Co-Brokerage

Fellow yacht broker association members: This listing is available for co-brokerage and JMYS is a 50/50 house. Courtesy showings are available by appointment.

This listing specification has been approved by the sellers for accuracy. The photos, images and descriptive content are copyrighted by JMYS and may not be copied or used without specific written permission.

Please contact listing broker, **Eric Bescoby**, by phone, text or email for additional information or to schedule your personal showing. Eric is available via Mobile 626-818-5053 (call, text, and WhatsApp). You can send a detailed email to: Eric@JMYS.com.

Nordhavn 40 Amarok

Listing Broker: Eric Bescoby



Licensed in California and Florida

Mobile Phone: 626-818-5053, E-mail: eric@JMYS.com

About the listing- broker: After regularly showing his Nordhavn 40 *Sprezzatura* to interested boaters in marinas and anchorages from Alaska to Maine, Eric met with Jeff Merrill to discuss joining JYMS to assist buyers and sellers of trawlers and share his knowledge and experience of trawler features, cruising, live-aboard life and places to explore.

Broker: Jeff Merrill



Licensed and Bonded in California, Florida, Virginia and Washington

Mobile Phone: 949-355-4950 E-mail: Jeff@JMYS.com

Skype: jeff.merrill | You Tube: Jeff Merrill Yachts | Twitter: @JMYS_Trawlers | LinkedIn: jeff.merrill

Facebook: Jeff Merrill Yacht Sales | Instagram: JMYSTrawlers

Chairman, Certification Advisory Council (CAC) for CPYB 2023 and 2024

Yacht Brokers Association of America | International Yacht Brokers Association (Florida) | Northwest Yacht Brokers Association | California Yacht Brokers Association – President 2015 and 2016

