

# American Tug 435 *Odyssey*



# JMYS

Jeff Merrill Yacht Sales, Inc. | [www.JMYS.com](http://www.JMYS.com)  
4153 Country Club Drive | Long Beach, CA 90807

Florida address: Jeff Merrill Yacht Sales, Inc. | 2650 W State Road 84, Suite 103 | Ft. Lauderdale, FL 33312



## ***ODYSSEY***

**Price: \$1,245,000.00    Location: Stuart, FL**

# American Tug 435 *Odyssey*

*Odyssey* is for sale by her second owner who purchased her through Tomco, the American Tug builder in La Conner, WA. After purchase, she remained in town and the factory oversaw the installation of CMC Waveless active fin stabilizers and then, after some cruising in the Pacific Northwest, the yard coordinated on deck cargo shipping from Vancouver, Canada to Fort Lauderdale, Florida.

As the 14<sup>th</sup> hull number in the series, *Odyssey* benefits from the product improvements of the sister ships that preceded her. The original owners ordered most of the popular factory options (including the flybridge) with plans for great adventures, but sadly had life circumstances making them unable to travel. This opened up a rare opportunity for the current owner to purchase a like-new boat (under 100 hours on main and generator) that was outfitted and ready to go.

*Odyssey* is an outstanding American Tug 435 featuring; Two stateroom, two head layout with flybridge. Some of the unique upgrades include a top berth in the guest stateroom and a door access from hallway landing for the guest head. The current owner/seller is an adventurous man: a seasoned mariner with thousands of miles at sea, a veteran private plane pilot and long-distance motorcycle rider - as well as being a very accomplished businessman in many fields. His appreciation of mechanical systems and care for machinery is obvious when you step aboard to see *Odysseys'* condition. The seller purchased *Odyssey* as his last boat to do the Great Loop which he has now completed. *Odyssey* is offered as a very well-established American Tug 435, ready for her next owners to create their own adventures.

## LAYOUT: Main Deck – Saloon, Galley and Pilothouse



## LAYOUT: Lower Deck – Staterooms and Heads

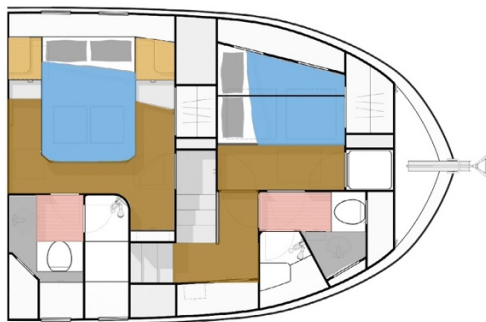

# American Tug 435 Odyssey

## Highlighted Equipment aboard Odyssey

- Cummins QSC8.3550HOI 542 HP – wet exhaust with Twin Disc MG-5075A transmission
- 9kW Northern Lights generator
- CMC Waveless digital electric active fin stabilizers
- Sleipner Sidepower SE100/185T 24 V bow and stern thrusters
- Groco oil change system
- Webasto 115/230 VAC reverse-cycle heating and air-conditioning (4) units. (2) 16,000, (1) 9,000 and (1) 6,000 BTU's
- (3) 115 VAC installed cabin heaters
- Magnum Magnasine MS-2012. 2000-watt inverter/charger with remote panel
- Lifeline AGM batteries
- Shore power connection aft
- Delta T ventilation fans in engine room
- Fireboy HFC 227 clean agent suppression in engine room
- Lofrans Tigress 12 VDC horizontal with chain wheel and capstan power up/down
- 275' of chain with color coding
- Lewmar 44 lb. claw anchor
- Side power remote – controls bow and stern thrusters
- Steelhead Marine ES1000 8-function tender crane with remote
- AB 10 VSX 10'6" Mares center console with Tohatsu 30 HP outboard
- US Watermaker 400 GPD water maker
- Heatercraft cockpit hot cold freshwater shower
- (2) Dometic Masterflush 12 VDC freshwater electric flush toilets with built in macerators
- Drinking water filter cartridges
- Bamboo mattress owner stateroom
- Bamboo mattress upper bunk and lower bed in guest stateroom
- Overhead hatches have Oceanaire roller screen/blinds
- Force 10 four burner propane stove and oven
- Nova Kool R5812 DC 12VDC refrigerator 5.8 Cu.Ft.
- Nova Kool freezer 5.9 Cu.Ft.
- Furrion FMCM 15 – SS microwave convection oven
- U-line ice maker in pilothouse
- (1) propane tank in cockpit locker
- Furrion flat screen television in saloon
- Furrion stereo system in saloon
- Asko clothes washer W2084
- Asko clothes dryer T208V
- Custom teak dinette table with folding leaves in saloon
- Intervac central vacuum
- (3) LLebroc helm chairs – two on flybridge and one in pilothouse
- Flybridge with helm chairs and bench seating on both sides

# American Tug 435 Odyssey

- Stainless steel framed Bimini with canvas covered top
- Stainless steel hinged arch with hydraulic lift

## Specifications:

<b>BRAND AND MODEL:</b>	AMERICAN TUG 435 (flybridge with framed top)
<b>TYPE:</b>	Coastal semi-displacement recreational tug with raised pilothouse
<b>LOCATION:</b>	Stuart, FL
<b>MODEL YEAR:</b>	2020 (first active use in 2023)
<b>HULL NUMBER:</b>	14
<b>HULL COLOR:</b>	Blue gelcoat
<b>REGISTRY:</b>	United States Coast Guard documented
<b>DESIGNER:</b>	Lynn Senour
<b>BUILDER:</b>	Tomco Marine Group (American Tugs – Krogen Group) – La Conner, WA
<b>HULL MATERIAL:</b>	Solid Fiberglass
<b>DISPLACEMENT:</b>	29,200 lbs.   13.3 MT
<b>BALLAST:</b>	Trim ballast in lazarette, starboard side
<b>RANGE:</b>	1,800 nm at 9.0 MPH
<b>SPEED:</b>	Cruise 9.0 MPH. Top 14 MPH
<b>LOA:</b>	43'7"   13.2 M
<b>LWL:</b>	38'6"   11.7 M
<b>BEAM:</b>	15'10"   4.8 M
<b>DRAFT:</b>	4'10"   1.5 M
<b>AIR DRAFT:</b>	27'   8.23 M arch up and antennal up   18'7"   5.6M arch down top of Bimini   22' with antennas down
<b>DECK:</b>	White deck with white nonskid
<b>MAIN ENGINE:</b>	Cummins QSC8.3550HOI   550 HP (Main hours: ~715 March 2025)
<b>EXHAUST:</b>	Traditional wet exhaust
<b>TRANSMISSION</b>	Twin Disc MG-5075A transmission 2.88:1 gear ratio
<b>PROPELLER / SHAFT</b>	2.5" stainless steel shaft   Tides Marine shaft seal   Five blade Nibral propeller 32" x 26"   Razor line cutter on shaft
<b>THRUSTERS:</b>	Sleipner Sidepower SE100/185T 24 V, 8 HP bow thruster   Sleipner Sidepower SE100/185T 24 V, 8 HP stern thruster
<b>STABILIZATION:</b>	CMC Marine LR Waveless digital active fins - electric
<b>ELECTRICAL:</b>	60 Hertz – US style - 50 Amp
<b>SHORE POWER:</b>	50-Amp for house. (Aft deck reel for cable).
<b>GENERATOR:</b>	Northern Lights 9 kW 240V 60Hz (Generator hours: ~905 March 2025)
<b>INVERTER/CHARGER:</b>	Magnum MagnaSine 2000-Watt inverter / charger
<b>BATTERIES:</b>	Lifeline AGM
<b>INTERIOR LIGHTING:</b>	LED lighting
<b>WATER MAKER:</b>	US Watermaker (400 gallons / day)
<b>CLIMATE CONTROL:</b>	Webasto Platinum series air conditioning (4) units (guest, owner, pilothouse and saloon) total of 48,000 BTU's   (3) 110V electrical heaters

# American Tug 435 Odyssey

<b>MACHINERY:</b>	Groco oil change pump
<b>WINDLASS:</b>	Lofrans Tigress 12 VDC horizontal electric 1500 W
<b>GROUND TACKLE:</b>	Lewmar 44 lb. claw   275' 5/16 " high test chain   Secondary Fortress anchor
<b>CRANE:</b>	Steelhead Marine ES1000 8-function tender crane. 1,000 pounds with handheld remote control
<b>TENDER AND OUTBOARD:</b>	AB 10 VSX 10'6" center console Mares   Tohatsu 30 HP outboard   Tender has full cover. Note: Road trailer for tender available, but not included in purchase
<b>NAV/COM BRANDS:</b>	Garmin   Icom
<b>ENTERTAINMENT:</b>	Furrion 27" flat screen TV in saloon   Furrion stereo with speakers
<b>STATEROOMS   BERTHS:</b>	(2) Owner aft, Guest forward. Sleeps Seven: (2) Owner. (2) Guest lower bunk. (1) Guest top bunk. (1) Pilothouse settee (1) Saloon starboard settee
<b>BEDDING:</b>	Custom "Bamboo" mattresses in Owner and Guest staterooms
<b>HEADS:</b>	(2) Dometic Masterflush (electric freshwater)
<b>SHOWERS:</b>	(2) Stall with door showers in Owner and Guest   Plus cockpit shower
<b>LAUNDRY:</b>	Asko separate clothes washer and clothes dryer
<b>GALLEY:</b>	Force 10 propane (3) burner stove with propane oven   NovaKool refrigerator / freezer   Furrion Convection microwave oven
<b>INTERIOR WOOD:</b>	Sapele. Matte, semi-gloss finish
<b>INTERIOR COUNTERS:</b>	Hard surface and laminate counters
<b>UPHOLSTERY:</b>	Ultraleather
<b>INTERIOR FLOORING:</b>	Sapele and Maple hardwood
<b>BILGE PUMPS:</b>	(3) Rule 2000 GPH 12 VDC submersible types each with automatic switches
<b>TANKAGE: (approx.)</b>	
<b>FUEL:</b>	640 US gallons   2423 L (aluminum)
<b>HOLDING BLACK:</b>	60 US gallons   227 L (molded plastic)
<b>HOLDING GRAY:</b>	60 US gallons   227 L (molded plastic) (with automatic pump discharge)
<b>FRESH WATER:</b>	196 US gallons   742 L (2 molded plastic tanks outboard aft engine room)
<b>ADDITIONAL EQUIPMENT:</b>	(3) Llebrec helm chairs   Delta T ventilation fans in engine room   Remote controller for thrusters   Eartec inter-crew communications headsets   Search light remote   Galvanic isolator
<b>SAFETY:</b>	Fireboy fire suppression in engine room with display in pilothouse and pull on top of galley refrigerator   Handheld fire suppression   Carbon Monoxide detectors and smoke detectors   (2) type IV life rings   ICOM handheld radios   USCG requirements   Xintex propane detector   Xintex CO detectors   (4) inflatable PFD's   (4) type I PFD's
<b>PHOTO DATE:</b>	Most detail photos were taken in November, 2024
	<b>Note: All information is believed accurate but should be verified.</b>

## General:

### Interior Finish/Trim

- Cabinetry with sapele veneers, solid sapele trim and drawer fronts
- Overhead and walls in marine grade vinyl with foam backing
- High quality carpet and padding

# American Tug 435 Odyssey

## Description:

Cockpit and Swim ladder: The swim platform includes tall safety rails and a built-in slide out swim ladder underneath that is accessible from the water. The cockpit has a wide boarding door that connects from the swim platform. Centered in the aft bulwark is a fiberglass console. The lid lifts to reveal a freshwater stainless steel sink basin. There is a hot/cold freshwater shower to port and inside the large door locker a large propane tank is secured to starboard. There is room to store hoses and cleaning supplies. Atop the bulwark surround are several neatly positioned stainless cleat posts.

The crane compression post stands up against the port forward bulkhead. Access to the lazarette below is available through two large cockpit hatches. Forward and outboard on both sides of the cockpit are molded in steps to provide easy access to the walking side decks and serve as boarding steps to a dock.

Note: Cockpit ladder to boat deck hatch has been removed and is stored away from boat. This ladder is included in the purchase and can be returned as a loose item at closing. The hatch in the boat deck is secured.

- (2) access hatches to lazarette below
- Center console aft with built in sink above and propane storage locker below (one propane tank installed)
- Magma propane barbeque rail mounted
- Aquatik hot / cold freshwater cockpit shower
- H-bitt stainless steel cleats
- US ensign flag on staff
- Foldable boarding ladder under swim platform
- Fresh water attachment
- Extra stainless handrails installed
- Stainless steel rack with dock line hooks on forward bulkhead
- Overhead hatch to boat deck (accessible when ladder is re-installed)
- Type IV throw ring with floating line
- 50-amp shore cable on a power reel (with foot button control)

Lazarette: There are two cockpit deck hatches outboard that provide access to the lazarette below. Each hatch has a small step ladder for access. Across the steering ram is a polyethylene storage cover with hinged lid.

- Northern Lights 9 kW generator forward, center with sound shield
- Generator intake through hull and strainer
- Start battery for generator and stern thruster
- TDI shore cord cable reel for 50-amp house shore power cord – to port
- 20' extension for 50-amp shore cord
- 30-amp and 35-amp dock power adapters (to 50-amp)
- Steelhead crane power pack and autopilot pump protected in polyethylene support structure – to port
- ELCI breaker

# American Tug 435 Odyssey

- Accu-steer autopilot pump
- Tides Marine shaft seal for rudder (dripless)
- Custom hinged cover over steering ram for storage
- Fortress anchor in red canvas carrier, spool with anchor rode and chain
- Emergency tiller

Saloon: A large panel window is inset into the door that provides entrance to the saloon from the cockpit. The saloon has large windows outboard and aft for excellent visibility and to stay connected with the outside. **Odyssey** has a comfortable built in settee to starboard. There are two folding directors chairs to port. To starboard, a beautiful custom moveable high-low teak table with folding leaves. The starboard forward section of the saloon (across from the galley) features an entertainment area with television and stereo. This area also has some storage lockers and a counter at the forward edge of the settee.

- Entry door has tall insert windows for great visibility
- Saloon table with folding leaves on moveable platform base
- Custom Ultraleather settee to starboard (7' long for sleeping if needed)
- Storage cabinets through out
- Hatches allowing access to engine compartment below
- Entertainment system with Furrion 27" flat screen television forward (needs outside provider plan for channel access)
- Furrion AM/FM/CD/DVD player with powered antenna and (2) stereo speakers
- Pleated day/night shades with two pulls, see through and block out
- 110V outlets
- (3) opening windows with removable screens
- 1000W 110V electric heater in saloon
- Overhead LED lights throughout
- Sapele and Maple sole

Galley: This galley is to port and connected at the same level with the saloon. The primary appliance is the Force 10 three-burner propane stove and oven. The galley includes a large single basin stainless steel sink. Cold food storage is provided by the stacked, standup separate NovaKool refrigerator and freezer units.

- Force 10 – 3 burner propane stove and oven
- Note: Engine room Fireboy pull on top of refrigerator
- NovaKool refrigerator (5.8 cubic feet)
- NovaKool freezer (5.8 cubic feet)
- Furrion convection microwave above stove
- Hard surface countertops
- Large, single basin stainless steel sink
- Wood cutting board mounts on top of sink
- Four drawers
- Sliding spice rack locker
- Multiple 110V outlets



# American Tug 435 Odyssey

- Sliding window with screen
- Sapele and maple sole

Engine Room: There are two access hatches in the saloon – one aft to port and one forward to starboard. Both hatches lift with gas spring struts and there are short step ladders for egress. The Cummins main engine is serviceable from both sides. There are two large aluminum fuel tanks outboard, with sight glasses and valves. The aft section of the engine room houses two freshwater tanks outboard.

- Cummins QSC8.3550HOI | 542 HP electronically controlled, common-rail fuel-injected diesel engine
- 100-amp alternator on main
- Groco intake strainer and through hull for main engine
- Tides Marine shaft seal (dripless)
- Custom shelf tops over batteries for securing spare parts and additional storage
- Battery switch panel and fuses mounted on aft bulkhead (port side)
- Groco oil change kit system
- Fireboy fire suppression
- Delta T ventilation
- CCTV camera mounted forward, facing aft
- US Watermaker and filters neatly installed ~~for easy access~~
- Fresh water pump, filter and accumulator tank
- Tool chest (most tools removed)
- Aft fuse and breaker panel
- Aft access to Racor fuel filters for main engine and generator
- Magnum Magnasine MS-2012 inverter/battery charger
- Webasto Isotemp 40 liter/10.5-gallon hot water tank – 750 W, 120 V with anti-scald valve

Pilothouse: A few steps up from the entry level leads to the raised pilothouse. There is a Llebroc helm chair for comfortably managing operations while underway. The forward dash area is well laid out with easy access to navigation screens and communications displays. Aft is a wide seat (can double as a bunk) and a table. Two sliding doors open outboard to allow access to the foredeck.

- Cummins digital power display
- Northern Lights generator display
- Bow and stern thruster joy sticks (On/Off)
- Thruster remote
- Search light remote
- Crane remote
- Large console for custom electronics installation, plus overhead console
- Dash console hinged for service and inspection
- (2) large Garmin displays (radar/plotter) Garmin 8616 = 16-inch displays
- Garmin sonar depth on plotters
- Garmin autopilot with nav route display function
- Garmin cruise data log with rudder angle indicator, wind speed and direction

**Jeff Merrill Yacht Sales, Inc. © 2025 All Rights Reserved [www.JMYS.com](http://www.JMYS.com)**



# American Tug 435 Odyssey

- (2) Garmin VHF radios
- CCTV camera system – engine room forward looking aft, radar arch looking aft
- Handheld LED high intensity 12V search light
- Inverter control panel
- Sapele and Maple sole
- Clock and barometer
- Center upholstered helm seat
- Ultraleather covered crew seating behind the helm with table
- Storage under seating
- Chart light on wand
- Access from pilothouse to upper deck (flybridge and boat deck) steps and door
- Counter and locker by steps to upper deck
- (2) sliding pilothouse doors outboard with opening windows and screens on upper portion
- Sapele and stainless hand holds throughout
- Lighted Ritchie compass
- Tank volume monitors
- Overboard black water pump-out key
- Special light dedicated to upper VHF
- LED lights throughout overheads
- Red lights over helm station for night navigation
- Intermittent windshield wipers with self-park and washing system
- 12V and 110V outlets
- Electrical panel behind dedicated door
- Helm breaker panel below dash for horn, deck lights, nav lights, compass light, etc.
- Helm bilge pump breaker panel
- Fireboy panel
- Tank monitor system with analog display (fuel, water, waste)
- (2) stereo speakers
- (6) opening windows and screens
- Storage caddy for three remotes: spotlight, crane and thruster controller
- Vinyl overlay sole mats trimmed in place by sliding doors
- U-line Icemaker
- Storage locker with shelves
- Carpeted sole
- Stairs aft that lead up to the full height hinged door access to the flybridge and boat deck

Landing: Going forward from the starboard side of the pilothouse you descend to the landing (companionway). The entire lower-level accommodations are carpeted (the head soles are Sapele and Maple). The guest cabin and head are forward, the owners' stateroom and head is aft and down a few steps.

- In-house vacuum system in companionway – full reach
- Motion sensing lights
- Stainless handrails

# American Tug 435 Odyssey

Guest Stateroom and Head: The guest stateroom forward features an upper bunk (for additional guest or storage) with a wide lower berth below. At the forward foot of the bed there is a large storage locker. Forward are lockers housing the separate Asko laundry washer and dryer. There is an overhead hatch with roller screen/shade and opening portlights with screens outboard. Under the sole is access to bow thruster, stabilizer control panel, holding tank pump out and other machinery access. The guest head has double door access, one from the stateroom and one from the hallway. The freshwater toilet and full standing shower with door are balanced with a built-in sink with a mirrored medicine cabinet above.

- Large lower side berth (77" L x 61" W = approximate Queen and tapered at foot)
- Upper bunk
- En-suite head with two entry doors, toilet, shower and counter with sink
- Hanging locker
- (2) large drawers under berth
- Overhead Bomar opening hatch
- Ocean Air Sky Screen for Bomar hatch
- (2) stainless steel port lights with screens and drapes
- Asko clothes washer
- Asko clothes dryer
- Carpeted sole
- Huge space below carpeted sole with access to black water tank, ~~macerator~~ holding tank pump as well as air-conditioning intake through hull, strainer and pump, plus bow thruster
- Stabilizer control unit mounted in below sole area
- Battery for windlass and bow thruster
- Custom shelf top for securing spare parts and additional storage

## Guest Head

- 12V Dometic freshwater toilet
- Vanity and mirror with overhead lighting
- Built-in shower stall with door and seat
- Hard surface countertops with stainless sink
- Two door access – from companion way and from stateroom
- Stainless steel ports with screens
- 110V outlets
- Sapele and Maple sole

Owner Stateroom and Head: The location of the owner stateroom aft makes for a quiet, private and comfortable sleeping area. The bed is an island configuration positioned athwartships. Along the starboard side is easy access to the head, sink, and shower.

- Center island queen berth (76" L x 60" W)
- Large drawers under berth
- Nightstand on each side of berth with drawers
- Reading lights
- (3) drawers with mirror above
- Large aromatic cedar lined hanging locker
- (2) stainless steel ports with screens and drapes

# American Tug 435 Odyssey

- 110V outlets
- Access to gray water tanks beneath carpeted sole
- Access to black water discharge through hull in forward hanging locker
- 750W 110V electrical heater in owner stateroom and forward head
- Carpeted sole

## Owner Head

- 12V Dometic freshwater toilet 12V
- Vanity and mirror with overhead lighting
- Built-in shower stall with seat
- Hard surface countertops with stainless sink
- Sapele and Maple sole
- Stainless steel ports with screens
- 110V outlets

## Exterior deck areas:

Foredeck: There are three Bomar hatches atop the foredeck house. Forward, the ground tackle features a with Lofrans Tigres horizontal electric windlass with 275' of chain rode (color coded) attached to the Lewmar claw anchor. There is a second bow roller and deck pipe for setting an additional anchor (the Fortress is stowed in the lazarette). The stainless railings are fitted with fender holders.

- (3) Bomar deck hatches in house roof
- 12V connection by pilothouse windows
- Stainless steel fender holders
- Lofrans Tigress horizontal windlass with capstan to port and gypsy to starboard – 12V
- Cats claw with turnbuckle to secure anchor chain and relieve pressure on windlass
- Foot button switches for windlass control
- Remote windlass control toggles on dash of pilothouse and flybridge
- Robust stainless steel anchor mount on stem
- Stainless steel breast plate on bow
- Primary anchor roller to starboard
- Stainless shank roll bar to assist with fair leading chain
- Lewmar 44 lb. claw anchor with 275' of 5/16" high tensile chain
- Secondary anchor roller to port
- Secondary anchor deck cap
- Hinged fiberglass access hatch to chain locker
- "V" bungee bridle for rough water anchoring out
- Underside of chain locker deck hatch has hooks for conveniently holding anchor bridle
- Divided chain locker enabling separate rodes
- Sea water deck wash connection
- Fresh water deck wash connection
- Stainless steel burgee staff for bow pulpit
- (2) Stainless steel H-Bitt fittings bow cleats for lines

# American Tug 435 Odyssey

Boat Deck: The boat deck houses the tender on centerline. The tender is launched by the Steelhead crane installed outboard to port. A custom aluminum launching bridle strong-back-bar is deck mounted. There is a step toolbox for storing dinghy related attachments.

- AB 10'6" Mares tender mounted on chocks with tie downs and cover (2021)
- Tohatsu 30 HP outboard engine (2021)
- Storage locker forward for dinghy covers
- Small foot storage locker for dinghy attachments
- Deck hatch is covered where cockpit ladder leads to (ladder has been removed)

Flybridge: The flybridge is a couple of steps up from the boat deck. There is a stainless-steel framed Bimini with canvas cover. There is a snap on canvas cover from the venturi windscreen aft, that protects the helm chairs and bench seating. Two LLebroc helm chairs are installed for easy operations. The navigation and electronics are easy to see and adjust. There is upholstered seating outboard on both sides.

The arch provides a convenient mounting surface for various navigation and communication antenna. The arch has a hydraulic lift to lower. There is a stainless-steel framed structure for navigation antenna installations. The port side dome is empty, a decoy to provide symmetry aloft.

- (2) LLebroc helm chairs
- Bench seats outboard port and starboard
- Engine shift – single lever
- Cummins engine display
- Sidepower bow and stern thruster lever (on/off controls)
- CMC stabilizer control panel
- Windlass remote control
- Navigation and communications electronics
- Garmin 8612 - 12" display (chart plotter/radar)
- Garmin autopilot
- Garmin remote VHF radio
- Stainless steel radar arch (hinged on hydraulic lift)
- (2) Radomes (one is empty for symmetry)
- 12V outlet
- Stainless steel framed Bimini cover

Additional information from AmericanTugs.com website:

## **Mechanical Systems**

- 9kW Northern Lights genset with sound shield
- Side-power SEP electric bow and stern thruster system
- Steelhead deck crane with hydraulic lift boom and rotation, 1000lb
- 2-1/2" Stainless alloy shaft with dripless shaft seals on main shaft and rudder shaft
- CNC machined Nibral, five-bladed propeller meets class "S" specifications

**Jeff Merrill Yacht Sales, Inc. © 2025 All Rights Reserved [www.JMYS.com](http://www.JMYS.com)**

# American Tug 435 Odyssey

- Composite rudder and skeg
- Oil changing system for main, gear and genset
- Racor 500 filter for genset
- Dual Racor 900 filters for main engine
- Seawater strainers on engine, genset and air conditioning systems
- Underwater exhaust system for main engine and generator
- Heavy duty sound deadening throughout engine room
- High water bilge alarm system
- (3) 2000 GPH bilge pumps with automatic float switches
- Waste discharge system
- Electronic shift and throttle system

## **Electrical System**

- Magnum 2000 W inverter/charger and battery monitor system
- AC and DC distribution panels in pilothouse with digital meter
- Battery selector switch system (remote controlled)
- Battery combiner system for charging
- (3) 8-D AGM batteries for house (735-amp hours)
- (1) 8-D AGM battery for main engine start
- (1) 4-D AGM battery forward - bow thruster and windlass
- (1) Grp 31 AGM battery for generator start
- Defroster system windshield in pilothouse
- Two nautical mile international LED navigation lights
- Dual trumpet air horn
- Shore power inlet in cockpit
- 12V LED courtesy lights throughout boat

## **Steering System**

- Autopilot valve system installed
- Edson stainless helm wheel
- Hydraulic helm pump and cylinder
- Integral rudder post with bearing and dripless seal

## **Tankage general**

- Tank monitoring system for all tanks
- Fresh water pressure system with accumulator tank
- Two poly water tanks, 200 gallons total
- 10.5-gallon Isotemp water tank water heater with heat exchanger and 110V heat
- Taste/odor filter for all fresh water
- 60-gallon waste tank
- 60-gallon greywater tank
- Two aluminum fuel tanks (640 gallons total) each with sight glass with valves

## **Deck general**

- Molded non-skid walking surfaces
- Three Bomar hatches in trunk cabin
- Hinged transom door

# American Tug 435 Odyssey

- Swim platform
- Cockpit propane / storage locker with hot/cold faucet, stainless steel sink and lid
- Seawater washdown system in bow
- Freshwater washdown system in bow
- (2) 2" fuel fill fittings
- (2) 1-1/2" water fill fittings
- (1) 1-1/2" waste pump out fitting
- 316 stainless steel 1-1/2" bow and side deck rails
- 316 stainless steel 1-1/2" upper deck rails
- 316 stainless steel 1-1/2" ladder from cockpit to upper deck
- 316 Stainless steel bow roller
- Color matched powder coated aluminum framed windows and sliding or hinged doors
- Hot and cold shower in cockpit

## **Safety and Mooring general**

- Lofrans Tigres anchor windlass 1500W /12V
- 275' of 5/16" H.T. galvanized chain
- 44 lb. Lewmar claw anchor
- Secondary bow roller
- (6) custom "h-bitt" mooring cleats (316 stainless steel)
- Fireboy Automatic fire extinguisher in engine room
- Fireboy Automatic engine shut down and bypass
- (4) portable fire extinguishers
- (4) fenders and mooring lines
- Extra dock lines
- Ships bell
- Generator spare parts kit
- Main engine spare parts kit

**Odyssey's** second owner purchased her from the factory and then patiently waited several months for the installation of active fin stabilizers supervised by the Tomco yard team. After a couple of weeks cruising in the Pacific northwest (Washington and Canada) she was loaded on a ship to Fort Lauderdale. Once in Florida waters she was recommissioned and then set off northbound to travel the route of the Great Loop. The detail photos were taken in November of 2024. Please review the additional information online including photos and our YouTube video. **Odyssey** is available for inspection by appointment – please get in touch to learn more. We welcome your inquiry, let's get you aboard!

## ADDITIONAL BROKER COMMENTS:

**Odyssey** is a US Coast Guard Documented vessel. She originally intended to cruise the Pacific Northwest, but life plans changed, and she sat idle for her first year and a half and was then purchased by her current owner (second owner, but truly the first user). After having the factory install active fin stabilizers and other upgrades (including a water maker, search light, etc.) she did a short season of shakedown cruising near the factory in La Conner, WA, then was shipped by sea freight to Fort Lauderdale where she was recommissioned and, after adding an AB Mares center console tender with outboard, headed north to enjoy the Great Loop. It is not common to find a flybridge model and **Odyssey** was built for east coast cruising with the larger generator and air conditioning package. Lightly used and carefully maintained, she is ready to take off on her next adventure.

Jeff Merrill Yacht Sales, Inc. © 2025 All Rights Reserved [www.JMYS.com](http://www.JMYS.com)



# American Tug 435 Odyssey

## Talk Through Tour – American Tug 435 Odyssey



<https://www.youtube.com/watch?v=GI3SgFsbk34>



**Exclusions:** Potential purchasers should assume that items on the vessel at the time of viewing, but not specifically listed on this sheet, are not included with the sale of the yacht. These specifications are believed to be true and correct but cannot be guaranteed. Items excluded include, but are not limited to Paintings, tools, handheld nav gear and binoculars. The owner's personal effects and clothing will be removed prior to closing.



## American Tug 435 Odyssey

**Disclaimer:** Jeff Merrill Yacht Sales, Inc. presents the details of this vessel in good faith but cannot guarantee or warrant the accuracy of this information nor guarantee or warrant the condition of the vessel. Buyers should instruct their agents and their surveyors to investigate all details the buyers desire validated. This vessel is offered subject to prior sale, price change, or withdrawal without notice.

**Brokerage:** JMYS is a US based (licensed and bonded yacht brokerage in California, Florida, Virginia and Washington) with an international emphasis specializing in ocean capable trawlers and recreational tugs. Our brokers are experienced boaters, most are trawler owner/operators with thousands of hours and miles at sea. We treat our clients with respect, we are responsive and not pushy. Our focus is to become your loyal advocate, always looking out for your best interests. The team at JMYS has extensive trawler and motor yacht product knowledge and our skills are available for coaching after the sale has concluded.

**Co-Brokerage:** Fellow yacht broker association members: **Odyssey** is available for Co-Brokerage, please call to discuss special listing arrangements in place.

This listing specification has been approved by the sellers for accuracy. The photos, images and descriptive content are copyrighted by JMYS and may not be copied or used without specific written permission.

**Listing broker. Jeff Merrill, CPYB** (Certified Professional Yacht Broker) has extensive product knowledge of the trawler market plus direct experience with the American Tug brand and is very well acquainted with the American Tug 435. He represented the owner as buyer when Odyssey was purchased in March of 2022. Jeff is a familiar face to YouTube viewers and a regular presenter at TrawlerFest. He has written dozens of articles about trawlers for *Ocean Navigator* and *PassageMaker* magazines and is one of the online instructors for *Boaters University*.

Please contact listing broker, **Jeff Merrill, CPYB** by phone, text or email for additional information or to schedule your personal showing. Jeff is available via Mobile + 1 949.355.4950 (Call, WhatsApp or Text). You can send a detailed Email to: [Jeff@JMYS.com](mailto:Jeff@JMYS.com).



**Licensed and Bonded in California, Florida, Virginia and Washington.**

Skype: jeff.merrill | You Tube: Jeff Merrill Yachts | Twitter: @merrillyachts | LinkedIn: jeff.merrill

Facebook: Jeff Merrill Yacht Sales | Instagram: JMYSTrawlers

Chairman, Certification Advisory Council (CAC) for CPYB 2023 and 2024

Yacht Brokers Association of America | International Yacht Brokers Association (Florida) | Northwest

# American Tug 435 Odyssey

Yacht Brokers Association | California Yacht Brokers Association – President 2015 and 2016



**\*Listing broker. John Hoffman**



**About the listing broker:** John Hoffman has years of experience working with the Nordhavn brand over the years, having retired from his position as Nordhavn Commissioning Manager in 2015. John's product knowledge, systems skills and friendly, helpful attitude have helped him excel as a JMYS yacht broker. John has his yacht salesman license in Florida and is eager to work with many current clients and also looking forward to helping new buyers and sellers. Please contact listing broker John Hoffman for additional information or to schedule a viewing appointment. You can email John at [John@JMYS.com](mailto:John@JMYS.com) or call/text +1 772.215.3720.