

Nordhavn 40 *Dei Amor*



JMYS

Jeff Merrill Yacht Sales, Inc. | www.JMYS.com
4153 Country Club Drive | Long Beach, CA 90807

Florida address: Jeff Merrill Yacht Sales, Inc. | 2650 W State Road 84, Suite 103 | Ft. Lauderdale, FL 33312

Dei Amor



Price: \$389,000.00

Location: Stuart, Florida

Dei Amor is hull 09 out of 44 of the first generation (US Built) boats. The Nordhavn 40 is a full displacement ocean crossing trawler. ***Dei Amor*** has active fin stabilizers for a smoother ride offshore. Diesel machinery features a dry stack Lugger main engine, Yanmar wing engine and Northern Lights generator

Purchased to test-the-waters, her current owners have refreshed her over two years of ownership with many improvements and upgrades (*see summary at the end). They have enjoyed every minute aboard and now desire to travel afloat on a larger platform.

Nordhavn 40 *Dei Amor*

The 40 is the sixth design from PAE and incorporates many features proven on larger boats. She has a 14'6" beam featuring a full width saloon / galley. Her layout boasts a raised pilothouse, two staterooms and a head with toilet and shower. The Nordhavn 40 offers excellent interior living space and comfort.

DESCRIPTION:

Boarding: The Nordhavn 40 has safe and convenient access from the dock or by water. *Dei Amor* offers an aft cockpit starboard side boarding door and a transom boarding door that connects with the built-in swim platform.

Cockpit: The aft deck offers a safe and protected area. Two molded-in seats are located aft (port and starboard), starboard used for storage and the port seat locker is for propane tank storage. A hot and cold shower for rinsing off after a swim is located inside the transom. The lazarette below is accessed via a large hatch located in the center of the cockpit floor while the saloon is accessed through a raised (to prevent water entry) hinged centerline door.

- Two boarding doors – aft and to starboard
- Magma Catalina2 infrared grill with/mount and cover (2023)
- Swim ladder for swim platform
- Two built in seats
- Hot and cold freshwater shower
- Air vents for engine room
- Diamond SeaGlaze door with window and dogs

Lazarette: The lazarette secures important equipment and provides immense storage space. The forward bulkhead has a hinged step which lifts up to reveal batteries. The inverter and watermaker are located to port. The hot water tank is mounted to starboard. An emergency tiller is included as well as a spare anchor.

- Concealed battery bank under forward bulkhead hinged lid step
- Xantrex Freedom SW 3012 3000-watt inverter/charger (2018)
- (5) Odyssey 8D AGM batteries (4 in lazarette 1 under main stateroom bed) (2025)
- Rule electric bilge pump
- Seawaterpro 40 GPH water maker (2024)
- Hynautic hydraulic steering ram
- Garmin Reactor 40 autopilot pump control (2023)
- Raritan 1700 series 12-gallon hot water tank
- Emergency tiller
- ST350 Side Shift stern thruster (2024)

Saloon: Upon entering the saloon, you will appreciate the exceptional living space this full beam design offers. To starboard is an L-shaped settee with storage below and a teak dining table, and the addition of a new quartz countertop with an overhang eating option includes two Ultra leather Stainless steel fixed stools (stools are from a Nordhavn 68). A teak cabinet with locker doors is portside allowing room for a full-size lounge chair. The sole (with engine room access panels) Teak and holly. For entertainment, a flat screen television is mounted forward to starboard.

- Wall to wall teak and holly flooring (2023)
- (2) Ultra leather Stainless steel fixed stools (2025)
- Teak saloon table

- Slide windows with screens
- Overhead lighting
- Reading lights
- Adjustable blinds on all windows
- Controls for air-conditioning
- Music speakers Garmin Fusion remote control (2023)
- Xantrex inverter/battery charger control
- Xantrex Link Pro battery monitor

Galley: The saloon connects you to the galley positioned portside. This galley features Quartz counters with teak lockers and drawers. There is a large stainless-steel double basin sink with faucet. A Seaward 10 three-burner propane stove and oven with overhead exhaust fan is located to port. Mother of Pearl backsplash tile with vintage 1941 Chicken of the seas fish.

- Vitrofrigo freezer/refrigerator (2) drawer 110V/12V (2025)
- Quartz countertops (2023)
- Additional Sub Zero 110V freezer in cabinet to starboard opposite galley
- Seaward three-burner propane stove and oven with broiler
- GE trash compactor (2023)
- GE microwave oven
- Dual basin stainless steel sink
- Multiple teak drawers, lockers and overhead cabinets for storage
- Lonseal raised coin vinyl flooring
- Air fryer/oven
- Toaster

Pilothouse: The pilothouse provides a dedicated space to run the ship. The stainless-steel helm wheel is surrounded by a well-designed dash area fitted with electronics control screens positioned above and below the forward windows. Navigation equipment includes; autopilot, fish finder, chart plotter / GPS, and VHF. The electrical panel breaker is behind a clear door cabinet to starboard. The main engine and wing engine Morse control levers are located above the helm. You have convenient access to controls for the bow thruster, anchor windlass, horn, and wipers. Additional pilothouse controls for the spotlight, generator, active fin stabilizer and air conditioning systems. Aft in the pilothouse there is a watch berth and a large sofa settee fronted by a teak table. Many owners enjoy meals in the pilothouse to appreciate the spectacular view. Two Dutch Doors outboard grant access to the Portuguese bridge.

- Garmin Chartplotter GPS 1243XSV (2023)
- Garmin Chartplotter GPSMAP 8612 (2022)
- Garmin Reactor 40 autopilot (2023)
- Garmin Reactor 40 wireless remote for autopilot (2023)
- Icom IC-M802 SSB transceiver
- Icom Marine IC-M604 VHF
- Garmin GMR 424 XHDZ Open Array 4' Radar (2024)
- Icom Class B AIS transponder MA – 500TR (needs service)
- Sirius weather GXM 54 (2024)

- Garmin Fusion Radio MS-RA770 (2023)
- Garmin Fusion flush mount speakers (2023)
- Garmin Transducer Airman (sonar) M265 LH (glycol cooled, in-hull, under bunk in VIP Stateroom) (2023)
- Starlink WIFI with (3) Eufy security cameras
- Ultra leather reupholstery of seating and berth (2023)
- 24" Samsung flat screen monitor – computer driven/RUKU box
- Ritchie Navigation flush mount lighted compass (2024)
- Airplane compass
- Standard Horizon floating HX 150 handheld VHF
- Floscan fuel flow gauge with digital tachometer
- Naiad stabilizer control panel
- Max Power bow thruster joystick control 2024
- Maxwell anchor windlass control (New OEM electric motor 2025)
- Northern Lights generator monitor panel
- Marine Air air-conditioning/heat reverse cycle
- Stainless-steel destroyer helm
- Ultra leather stainless steel helm stool
- Teak table forward of bench helm seat
- Storage below foot landing
- Folding chart table outboard to port.
- Diamond SeaGlaze Dutch doors port and starboard
- Hynautic hydraulic steering (*See JMYS Trawler Skills video on YouTube) (Shadow drive override 2023)
- Opening forward facing side window vents port and starboard
- Uniden handheld communicators
- Zinc Saver II 50-amp galvanic isolator
- ACR Rapid Ditch Express abandon ship bag
- Generous storage underneath steps leading up to pilothouse
- SIONYX night vision camera 2024

The galley / saloon level has a set of steps that descend to the staterooms and head below. This lower level is teak & holly (except the head which has synthetic vinyl teak and spruce cover).

Guest Stateroom: The guest stateroom to port and has an upper and lower set of berths. The upper bunk is fixed; the lower bunk can slide out to be made wider. Two portlights outboard can be opened for ventilation. The Splendide combination laundry appliance is secure in a locker with louvered door, next to a deep hanging locker and a bank of drawers. Below the lower bunk you have access to the active fin stabilizer on the port side. Aft in the guest stateroom is the door entry to the engine room.

- Marine fabric reupholstery of seating and berth (2023)
- Upper and lower berths
- Lower berth has a sliding base with fill cushion
- Teak ceilings outboard along hull
- Reading lights

Nordhavn 40 *Dei Amor*

- Two opening screened portlights
- Splendide clothing washer/dryer combination laundry appliance (2023)
- Dogged door entry access to engine room

Engine Room: The engine room is one of the best features of the Nordhavn 40. Access is through a dedicated door located aft in the guest stateroom (you can also enter though the sole, aft in the saloon). The maintenance strakes molded into the hull create additional headroom outboard of the main engine on both sides. Two fiberglass fuel tanks with perforated aluminum screens are outboard and each tank has its' own sight glass for a quick fuel level viewing. Both tanks feed a supply tank in the forward bilge.

The Luger L688D main engine is keel cooled with a dry stack exhaust and mated to a Twin Disc 3.0:1 transmission. This is a continuous duty rated power plant that was engineered for non-stop passage making over several days or weeks.

The engine room is well laid out and has been equipped with all systems and components easy to inspect and service. Fresh air intake from the cockpit risers and internal blowers keep air circulating and the hot air is directed up the stack to vent out above the engine room and upper aft deck. Diesel fuel filtration is accomplished by dual Racor 900 filters and a Racor 500 filter for the generator. To help with clean fuel *Dei Amor* has a fuel pump providing the ability to transfer fuel between tanks.

- Luger L668D 105 HP main engine
- Dry stack exhaust
- InsulTech exhaust blanket
- Twin Disc MG-55050 transmission 3.0:1
- Spurs line cutter
- (2) fiberglass fuel tanks, (1) aluminum supply tank
- Fresh water pump and strainer
- Naiad active fin stabilizer reservoir
- 10 kW Northern Lights generator with sound shield
- Yanmar model 3GM30FV 24 BHP wing engine
- Kanzaki KM3V-drive transmission on wing engine
- 10-gallon plastic day tank for wing engine
- Engine room blower
- Racor 900 duplex dual primary filters on main engine
- Racor 500 primary filter for generator
- Racor 900 for fuel transfer with Walbro pump and timer
- Escape hatch, entrance access aft in saloon
- Rule automatic electric bilge pump 2024
- Rule high water bilge pump 2023
- Ultra-switch sensor for high water bilge pump
- Edson manual bilge pump
- Engine room lighting

Head and shower: The head is conveniently located across from the guest stateroom. Practical in size and simple to maintain, there is a stand-up stall shower enclosure, an electric head, a vanity and

medicine cabinet. Fresh air is circulated via two opening screened portholes and supplemented by an exhaust fan in the shower.

- Vacuflush pump and all hoses replaced 2023
- Corian countertop with built-in sink
- Mirror in teak framed cabinet above sink
- Two opening screened portholes – one in shower one in head
- Vinyl teak and spruce look flooring
- Separate full headroom stall shower enclosure with tempered glass door
- Teak grate shower seat over molded fiberglass locker
- Access to starboard active fin stabilizer under shower seat
- Exhaust fan in shower overhead
- Y-valve to holding tank or overboard
- Tank Watch holding tank monitor

Owner Stateroom: The owner's stateroom is forward, taking advantage of the expansive interior created below the foredeck. The interior hull sides have varnished teak slat ceilings with teak & holly floors. Forward are two locker doors providing access to the chain locker. The large island berth comfortably sleeps two. Below the mattress you find access to the bow thruster and a separate house battery bank for powering the bow thruster and windlass. This is also an ideal place for chart storage and stowing the saloon storm plates). Ventilation is provided via the large hatch overhead, opening portlights outboard and two round portlights aft in the Portuguese bridge. All cabinetry and furniture including overhead lockers, drawers and hanging lockers are teak.

- Island berth
- Two large cedar-lined hanging lockers
- Teak bureau with drawers
- This stateroom flooring - teak & holly
- Overhead teak lockers along berth on both sides cedar lined 2024
- Port-side and starboard side book racks
- Reading lights
- Air conditioning controls
- Windlass and bow thruster shut off controls
- Flat screen television Supersonic 24" smart tv
- Overhead hatch with insect screen
- (2) opening screened portlights outboard on each side (with deadlights)
- (2) opening screened portlights allow for light and air from the Portuguese bridge deck
- Cabin door has mirror on hallway side

Boat Deck: There is a used West Marine inflatable dinghy (no paperwork and no outboard) available for free to the buyer. The dinghy is launched via remote controls for the electric winches mounted on the boom. The life raft is mounted on the pilothouse roof.

- Forespar mast and boom for dinghy
- Mast has hinged base for easier lowering
- Tender: West Marine 340 RIB from 2002. NOTE: No registration available. Free to buyer at closing, but no paperwork and no outboard
- Rule V33R electric winches with remote

Nordhavn 40 *Dei Amor*

- 1 of 2 Endurance EMD2500SS stainless steel davit winch (2025)
- 2 of 2 Endurance stainless steel davit winch 2023
- Switlik 6-person life raft (needs re-registration)

□

Foredeck and Exterior

- Gray gelcoat hull
- Deck superstructure is white gelcoat and deck is molded gray nonskid gelcoat
- Portuguese bridge with door to foredeck
- Courtesy lighting
- Maxwell VM 2200 electric windlass with capstan
- Windlass controls at foredeck and pilothouse
- 50 KG Bruce anchor with 400' 3/8 HT chain
- Dock lines and fenders
- Four-step removable boarding ladder for swim platform
- Aluminum painted mast and boom
- Boom winches for dinghy launching
- Mast has a hinged base for lowering

□

Electrical: General summary of electrical equipment aboard *Dei Amor*.

- Northern Lights 10 kW generator with sound shield
- Xantrex Freedom 30, 3000-Watt inverter/charger
- Shore power outlets amidships on starboard side
- 50-amp shore power cord for house/air conditioning
- 12V DC, 110V AC breakers
- Galvanic isolator
- Copper bonding system
- Leece Neville 160-amp alternator

Safety:

- Switlik 6 - person Life raft (needs re-registration)
- EPIRB (2DDAA DA222 BFDFF reg to 5/27)
- Engine room high water bilge alarm
- Acrylic storm plates for saloon windows
- USCG equipment

Owner improvements: Since purchase in June 2023, the following upgrades and improvements have been completed by the current owners:

Garmin GMR 424 XHDZ 4' open array radar (2024)

Garmin Airman transducer (sonar) M265 LH (2023)

Garmin Reactor 40 autopilot and pump (2023)

Garmin remote control autopilot (2023)

Garmin chart plotter GPS 1243XSV (2023)

Garmin Fusion stereo / radio MS – RA770 (2023)

Garmin Airmar M260 in hull sonar transducer (2023)

Nordhavn 40 *Dei Amor*

Sionyx night wave night camera (2024)
Starlink (2024)
Sirius weather GXM 54 (2024)
(2) AC/DC smart televisions – 16" Syvonix 2025, 24" Supersonic owner stateroom (2024)
Boom winch motors replaced (2024/25)
Seawaterpro 40 GPH water maker (2024)
Vitrofrigo drawer freezer/fridge installed in galley (2025)
(5) Odyssey 8D AGM batteries installed (2025)
Maxwell windlass motor replaced (2024)
ST350 Side Shift stern thruster (2024)
Naiad stabilizer port fin replaced. Both sides seals replaced (2025)
Fresh bottom paint (2025)
Teak and Holly flooring installed in saloon, hallway, guest stateroom and owner stateroom 2023
Quartz counter tops installed in galley (2023)
Ultra leather seating upholstery replaced in saloon, pilothouse, guest stateroom and owner stateroom (2023)
Magma Catalina 2 infrared barbecue grill with mount and cover (2024)
Fresh water pump replaced (2025)
Sump pump for shower replaced (2024)
Electric bilge pump replaced (2025)
Service work on main engine, wing engine and generator
Numerous spare parts

Nordhavn 40 *Dei Amor*

LAYOUT: Raised Pilothouse

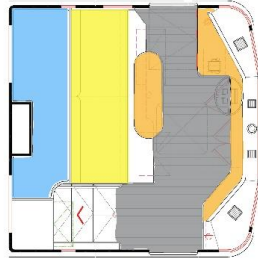

LAYOUT: Main and Lower Deck – Saloon, Galley Head and Staterooms



Nordhavn 40 *Dei Amor*

SPECIFICATIONS:	
YACHT NAME:	<i>Dei Amor</i>
BRAND AND MODEL:	Nordhavn 40
TYPE:	Long range trawler yacht with raised pilothouse
LOCATION:	Stuart, FL
MODEL YEAR:	2000
HULL NUMBER:	9
HULL COLOR:	Gray
DECK:	White deck with gray nonskid
REGISTRY:	USCG Documented (US built)
DESIGNER:	Jeff Leishman
BUILDER:	Pacific Seacraft - Fullerton, CA USA
HULL MATERIAL:	Solid fiberglass
DISPLACEMENT:	50,000 LBS. 22.68 MT
BALLAST:	4,000 LBS. 1.82 MT
SPEED:	Cruise 7.0 knots @1700 RPM. Top 8 knots @ 2100 RPM. WOT=2400
LOA:	39'9" 12.12 M
LWL:	35'5" 10.79 M
BEAM:	14' 6" 4.42 M
DRAFT:	5'6" 1.7 M
AIR DRAFT:	Approximately 32' 9.75 M with mast up. Hinged base for lowering.
AB RATIO	2.3:1
DL RATIO	380
CP - PRISMATIC COEFFICIENT	0.6
MAIN ENGINE	Lugger model L668D 105 BHP (Hours ~7,745 May 2025) Twin Disc 3.0:1 transmission
PROPELLER / SHAFT	2" stainless steel shaft 4 blade bronze propeller
MAIN EXHAUST:	Keel cooled, dry exhaust
WING ENGINE:	Yanmar model 3GM30 27 BHP, Kanzaki KM3V-drive transmission (~Hours 60 May 2025)
THRUSTERS:	Max Power 8 HP electric bow thruster ST350 Side Shift stern thruster (2024)
STABILIZATION:	Naiad active fin stabilizers Flopper stopper rig on port side
ELECTRICAL:	60 Hertz – US style – 50-amp

SHORE POWER:	50-amp for house and 50-amp air con
GENERATOR:	Northern Lights 10kW generator with sound shield (Hours ~11,000 May 2025)
INVERTER/CHARGER:	Xantrex Freedom 30 3000-Watt inverter/charger
BATTERIES:	Lifeline (5) AGM House batteries and Start batteries
INTERIOR LIGHTING:	LED lighting
CLIMATE CONTROL:	Marine Air A/C: 44,000 BTU (3) compressors. Reverse cycle heat in Pilot House
MACHINERY EQUIPMENT:	Racor Duplex for main Walbro fuel transfer pump with Racor filter
WINDLASS:	Maxwell 2200 vertical electric windlass with gypsy and capstan
GROUND TACKLE:	50 KG Bruce anchor with 400' 3/8" chain 60 lb. spade anchor with 50' chain and 125' of line
MAST AND BOOM	Forespar mast and boom Hinged base to lower mast for bridges Mast supports main engine exhaust Boom for dinghy with electric winches.
TENDER AND OUTBOARD:	West Marine 340 RIB from 2002. No paperwork, no outboard free to buyer at closing.
NAV/COM BRANDS:	Garmin
ENTERTAINMENT:	Supersonic/ Syvonix LCD flat screen TVs (one in saloon, one in owner cabin) Garmin Fusion stereo with speakers
STATEROOMS:	(2) staterooms: Owner forward, Guest to port
BEDDING:	Centerline queen (Owner) forward (2) Bunk beds in port guest stateroom Pilothouse watch berth
HEAD:	One: Sealand Vacuflush freshwater toilet (electric)
SHOWERS:	Two: Stand up in head with door Cockpit shower
WATER MAKER:	Seawaterpro 40 GPH water maker
LAUNDRY:	Splendide 2000 combo washer/dryer
GALLEY:	(1) Vitrofrigo freezer/refrigerator (2) drawer (1) Sub Zero freezer Seaward Princess three-burner propane stove and oven with broiler GE microwave oven GE trash compactor
INTERIOR WOOD:	Teak (with white laminate panels)
INTERIOR COUNTERS:	Corian counters
INTERIOR UPHOLSTERY:	Fabric
INTERIOR FLOORING:	Teak & Holly Lonseal
BILGE PUMPS:	(2) Rule electric bilge pumps (1) Edson manual

Nordhavn 40 *Dei Amor*

TANKAGE: (approx.)	
FUEL:	920 gallons 3,482 liters (Two fiberglass tanks)
HOLDING BLACK:	68 gallons 257.5 liters (One fiberglass tank)
FRESH WATER:	220 gallons 833 liters (One fiberglass, Two plastic tanks)
SAFETY:	USCG safety package ACR EPIRB (Needs service) Switlik 6-person offshore life raft Engine room high water bilge alarm
PHOTO DATE:	Most photos taken March, 2025
Note: All information is believed accurate but should be verified.	

Dei Amor is a full displacement long range trawler that has excellent equipment and a proven active traveler. She was built by Pacific Seacraft in California, proudly "Made in the U.S.A." a rare model in the trawler realm.

For additional information please visit *Dei Amor's* website: www.Nordhavn40ForSale.com

Exclusions: Potential purchasers should assume that items on the vessel at the time of viewing, but not specifically listed on this sheet, are not included with the sale of the yacht. These specifications are believed to be true and correct but cannot be guaranteed. Items excluded include, but are not limited to Paintings, tools, handheld nav gear and binoculars. The owner's personal effects and clothing will be removed prior to closing.

Disclaimer: Jeff Merrill Yacht Sales, Inc. presents the details of this vessel in good faith but cannot guarantee or warrant the accuracy of this information nor guarantee or warrant the condition of the vessel. Buyers should instruct their agents and their surveyors to investigate all details the buyers desire validated. This vessel is offered subject to prior sale, price change, or withdrawal without notice.

Brokerage: JMYS is a US based (licensed and bonded yacht brokerage in California and Florida) with an international emphasis specializing in ocean capable trawlers. Our brokers are experienced boaters, most are trawler owner/operators with thousands of hours and miles at sea. The team at JMYS has extensive trawler and motor yacht product knowledge, and our skills are available for coaching after the sale has concluded.

Co-Brokerage: Fellow yacht broker association members: This listing is available for co-brokerage to Florida licensed brokers.

*Listing broker. John Hoffman

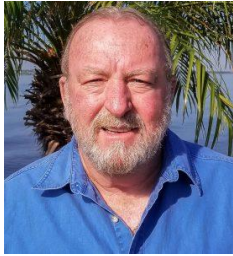

About the listing broker: John Hoffman has years of experience working with the Nordhavn brand over the years, having retired from his position as Nordhavn Commissioning Manager in 2015. John's product knowledge, systems skills and friendly, helpful attitude have helped him excel as a JMYS yacht broker. John has his yacht salesman license in Florida. Please contact listing broker John Hoffman for additional information or to schedule a viewing appointment. You can email John at John@JMYS.com or call/text +1 772.215.3720.



Licensed and Bonded in California, Florida, Virginia and Washington.

Skype: jeff.merrill | You Tube: Jeff Merrill Yachts | Twitter: @merrillyachts | LinkedIn: jeff.merrill

Facebook: Jeff Merrill Yacht Sales | Instagram: JMYS Trawlers

Chairman, Certification Advisory Council (CAC) for CPYB 2023, 2024 and 2025

Yacht Brokers

Association of America | International Yacht Brokers Association (Florida) | Northwest Yacht Brokers Association | California Yacht Brokers Association – President 2015 and 2016

