

Selene 53 *Le Chéile*



Jeff Merrill Yacht Sales, Inc. | www.JMYS.com
4153 Country Club Drive | Long Beach, CA 90807

Jeff Merrill Yacht Sales, Inc. | 6878 NW 20th Ave. | Fort Lauderdale, FL 33309-1513



2005 Selene 53 *Le Chéile*

PRICE: \$949,000.00

LOCATION: North Beach, Maryland

Le Chéile (Irish for “Togetherness/Harmony/Unity”) is hull number 30 in the bestselling Selene 53 series. Powered by a single engine Cummins QSL9 with an economical cruising speed of 7 knots which can provide a range of approximately 3,000 miles. For comfort underway she has Naiad hydraulic active fin stabilizers. When docking you have the convenience of electric bow and stern thrusters.

Double walk around side decks with tall bulwarks ensure safe traversing outside and connect the cockpit to the foredeck via the Portuguese bridge. The flybridge aloft is conveniently accessed inside through the pilothouse or outside from the cockpit stairs.

Varnished teak joinery throughout showcase the famous Jet-Tern Marine craftsmanship. ***Le Chéile*** has a versatile layout is the popular a three-stateroom, two head layout. The saloon (with commissary below the aft portion) and galley occupy the entry level and there is a stairwell to starboard to the lower deck and a short set of steps up to the pilothouse. You will appreciate the opening windows in the saloon

Selene 53 Le Chéile

when there is a fresh breeze and air-conditioning on warm or rainy days with the doors and windows closed.

Le Chéile was purchased in 2024 as a family on-the-water travel platform to explore the U. S. eastern seaboard. Anticipating many years of cruising, the owners committed hundreds of thousands of dollars on projects, equipment upgrades and improvements to refresh her features and prepare her for long distance travel.

They did not expect the life change-of-course that is sending them to a new work location across the country. The reality is that they will have to delay participating in the trawler lifestyle for a couple of years. Knowing that all trawlers are anxious when left idle, and much happier when they are on the move, the owners know that the right thing to do is to sell and turn over their well prepared and ready to cruise Selene to new owners who desire to take off for adventures to far flung destinations.

Please contact listing brokers, **Jeff Merrill, CPYB** or **Mark Benno** if you would like to discuss **le Chéile** in more detail and to make an appointment to get aboard and see her for yourself.

Exterior: Boat deck, Flybridge, Foredeck

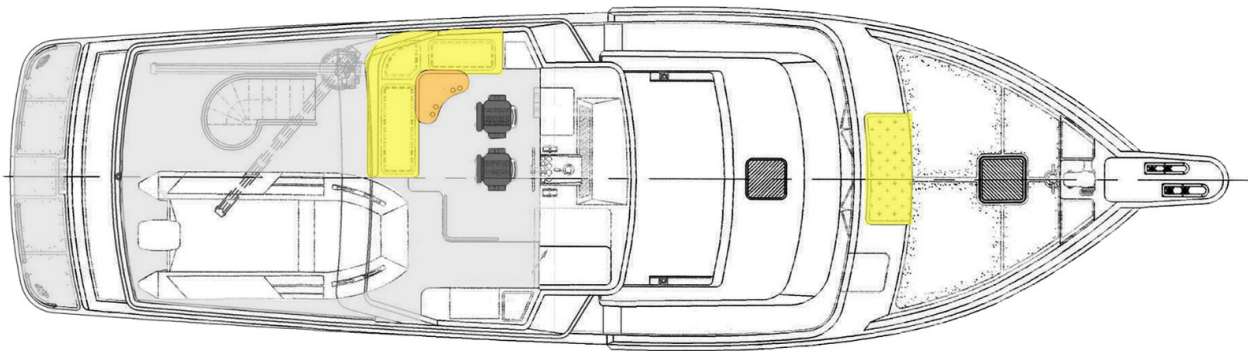

Main deck: Saloon, Galley, Pilothouse

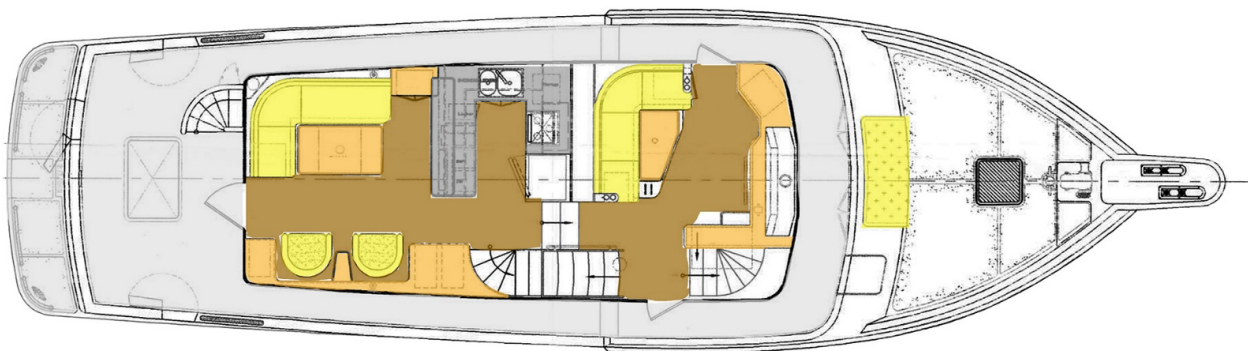

Lower deck: Saloon, Galley, Pilothouse

Selene 53 Le Chéile

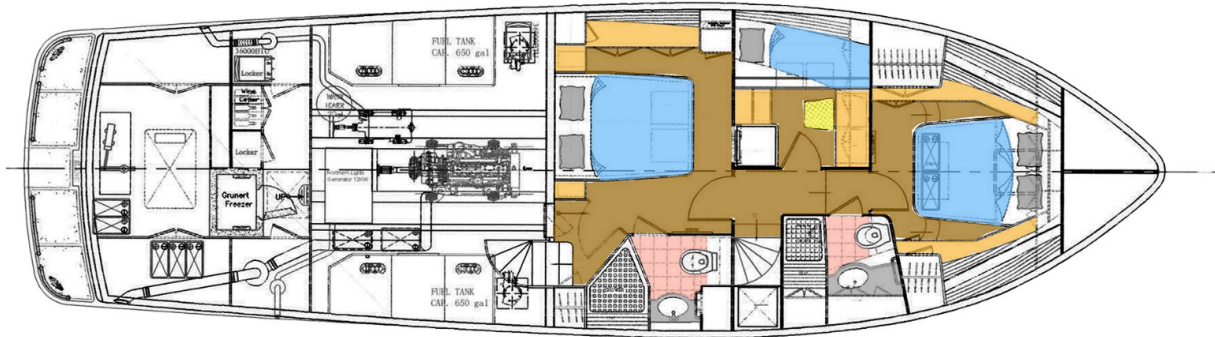

SPECIFICATIONS:	
YACHT NAME:	<i>Le Chéile</i>
BRAND AND MODEL:	Selene 53
TYPE:	Long range, raised pilothouse trawler yacht with flybridge
LOCATION:	North Beach, MD
MODEL YEAR:	2005
HULL NUMBER:	30
HULL COLOR:	White
DECK:	White deck with gray non-skid
REGISTRY:	United States Coast Guard documented
US DUTY PAID:	CBP 7501 Entry Summary
DESIGNER:	Howard Chen
BUILDER:	Jet-Tern Marine Co. - Zhuhai, China
HULL MATERIAL:	Solid fiberglass
DISPLACEMENT:	95,000 LBS. 43,091.28 KG
BALLAST:	6,000 LBS. 2,721.38 KG
SPEED:	Cruise 7.3 knots at ~1,200 RPM. Top 9 knots at WOT
RANGE:	3000 miles at cruise speed - 7.0 knots
LOA:	59'10" 18.24 M
LWL:	50'10" 15.49 M
BEAM:	16'8" 5.12 M
DRAFT:	5'9" 1.75 M when loaded = 6' 1.9 M
AIR DRAFT:	25'7" 7.80 M
D/L RATIO	298
CP - PRISMATIC COEFFICIENT	0.67
ENGINE:	Single Cummins QSL9 404 HP (~670 hours May 2026) Replaced 2022* (see note)

Selene 53 Le Chéile

TRANSMISSION:	Twin Disc MG 5075A Ratio: 2.53 - Original to vessel
PROPELLER / SHAFT:	2.75" Aqua Alloy 22 shaft (replaced in August 2023) PYI PSS self-aligning dripless shaft seal 4 blade 36"x26" Nibral bronze propeller Spurs line cutter
MAIN EXHAUST:	Wet exhaust
GET HOME PROPULSION:	Yanmar wing engine 55 HP model: 4JH4E (~16 hours May 2026) Transmission Kanzaki KM35A2 straight drive ratio: 2.64
THRUSTERS:	Sidepower SP155 TC (24V) (bow and stern) (10" tunnels)
STABILIZATION:	Naiad Model 254 hydraulic active fin stabilizers (9 sq. ft. fins)
ELECTRICAL:	12VDC 24VDC 48VDC 230VAC 115VAC
SHORE POWER:	60 Cycle 50-amp House and air conditioning Fore and Aft connections
GENERATOR:	Northern Lights 12 kW M843NW3 (~7,300 hours April 2026)
INVERTER/CHARGER:	2 x Victron MultiPlus 48/5000 120-70 120V Victron IP43 12VDC 50A 3 Output Charger Victron IP43 24VDC 25A 3 Output Charger 48V-130-amp main engine alternator Auxiliary Alternator Leece-Neville (200 amp) main engine (for 12V bank) 2 x Mastervolt 48/12 50A DC-DC Chargers 2 x Victron Orion 12-12 18A DC-DC Chargers
BATTERIES:	Bow thruster: (2) Lifeline GPL-4DL (April 2021) Stern thruster (2) Lifeline GPL-4DL (April 2021) Main engine: (1) Lifeline GPL-4DL (January 2024) Generator: (1) Exide Group 24 House back-up 12V: (3) Lifeline GPL-8DL (November 2021) House 48V: (4) Victron NG 24V/200Ah (Configured as 400Ah @ 48VDC)
INTERIOR LIGHTING:	Halogen and LED mix
CLIMATE CONTROL:	Cruisair reverse cycle HVAC: 72,000 BTU (2) compressors (5) Air handlers Kabola hydronic heating system (diesel boiler)
MACHINERY EQUIPMENT:	Reverso GP-3023 oil changer for main, gear, and generator Duplex Racor 1000 for main Duplex Racor 500 for generator ESI Total Fuel Management system Single Racor 500 for Yanmar wing engine
WINDLASS:	Maxwell HWC2200 12V electric horizontal windlass (2022 Serviced)
GROUND TACKLE:	Bruce 50 kg /110 lb. 95 lb. Delta plow 400' of 3/8" HT chain for each anchor
CRANE:	Aritex, polished stainless steel, 600 kg (1,320 lb.) hydraulic crane Note: base support redone 2024
TENDER AND OUTBOARD:	Highfield SP360 aluminum hull 11'11" (2025) 40 HP Tohatsu outboard (2025)

Selene 53 Le Chéile

NAV/COM BRANDS:	Ritchie Furuno Raymarine TimeZero Icom ACR emTrak EchoPilot
ENTERTAINMENT:	Fusion - 4 zone (Saloon/Pilothouse, Owner, VIP, Flybridge) 17" flat screen Smart TV (mount can accept larger TV) in saloon Standard Starlink mounted at the top of the mast 5G/Wifi switching with PepLink
STATEROOMS:	Three: Owner Queen midship, VIP Queen forward, Guest Single/Office Additionally, pilothouse watch berth (sleeps 1) and saloon settee slides out (sleeps 2)
BEDDING:	(Owner) midship with custom queen mattress and topper (VIP) custom queen mattress Guest single berth
WATER MAKER:	SeawaterPro 20 GPH Water Maker (2021) WaterDrop filter for galley
HEADS:	Two: Tecma freshwater 12V electric macerating marine heads
HOT WATER:	Torrid MVS20 20-gallon, 120V
SHOWERS:	Three: Stand up in owner head with door Stand up shower in guest head Transom outdoor
LAUNDRY:	Asko washer (2022) Bosch Axxis dryer
GALLEY:	Double stainless-steel sink Force 10 3-burner range LPG GE Profile combination microwave and convection oven NovaKool RFU 9200 dual compressor refrigerator/freezer 12V/110V (2022) Broan 1055 trash compactor Seafrost deep freeze 9.6 cu.ft. in commissary (air cooled 12V 2025) Dometic /Waeco CoolFreeze CF110 on flybridge
INTERIOR WOOD:	Teak and Holly hardwood throughout Carpet runner in saloon
INTERIOR COUNTERS:	Granite counters
INTERIOR UPHOLSTERY:	Sunbrella Ultraleather (2026)
INTERIOR FLOORING:	Teak and Holly
BILGE PUMPS:	Three: Rule 2000 GPH One: Rule 3700 GPH One: Whale Gusher manual pump
TANKAGE: (approx.)	
FUEL:	1,300 gallons 4,921 liters (Two fiberglass primary tanks)
HOLDING BLACK:	100 gallons 379 liters (Two fiberglass tanks)
FRESH WATER:	330 gallons 1250 liters (Two fiberglass tanks)

Selene 53 Le Chéile

SAFETY:	Fireboy MA2-1200-FE241 in engine room (recertified 6/2023) (7) handheld ABC extinguishers throughout (3-10lb, 4-5lbs)(2023) LPG gas detection in galley CO Detection (replaced 2020) Smoke (5) High water alarms EPIRB (battery replaced 2021, but not considered part of the sale) Viking 6-person lift raft (recertified 2021, but not considered part of the sale) Electronic flare SOS C-100B (2021)
PHOTO DATE:	Most photos taken May 2026
Note: All information is believed accurate but should be verified.	

Cockpit, and Swim platform

This arrival location by boat is through the swim platform and on deck by dock along the starboard and port side. The swim platform boarding door opens into the cockpit. The cockpit tops the lazarette machinery space below and is covered by the boat deck above. **Le Chéile** is a “double walk-way” model on deck - you can travel all of the way around from the cockpit up to the Portuguese bridge (and through to the foredeck) on both sides which makes getting about and line handling much simpler. There is a side deck to starboard that connects the cockpit up to the Portuguese bridge and around. A curved stairway is built in for easy access from the cockpit to the boat deck.

- Built-in swim ladder on swim platform
- Four removable staples on swim platform
- Stainless handrail on swim platform
- Semco cap rails
- (3) Teak chairs with teak table on aft deck
- Built in Selene fender clips
- Aft deck freshwater wash down
- Cockpit shower (hot and cold fresh water)
- Stainless-steel fishing rod holders
- Teak ensign staff with U.S. flag
- Aft and outboard storage lockers
- Aft shore power connections (also bow shore power connections)
- Watertight hatch in cockpit to access lazarette
- Zippered enclosure

Lazarette

You can reach this storage chamber through the large hatch in the cockpit. The hatch lid is secure from a slide bolt security bar inside. A stainless ladder with teak treads provides egress. Lazarette equipment includes: the steering system, stern thruster, and electrical systems. The Watermaker is located here and there are louvered door lockers with shelves inside for storing spare parts and other boat gear.

Selene 53 Le Chéile

- SeawaterPro 20 GPH watermaker (2021)
- Water filtration system for watermaker
- Compressor for the Seafrost freezer
- (2) 50-amp shore power cords, (1) 50 amp 2 to 1 splitter
- Multiple storage cabinets

Commissary:

Below the aft end of the saloon is a full beam “chamber” called the commissary. There is a hatch in the saloon floor (by the entry door) with easy steps access. This area separates the engine room from the lazarette and is a storage location and has access outboard on both sides for some featured equipment.

- Seawater Pro 20 GPH water maker (2021)
- Seafrost freezer unit 12V air cooled (replaced original Grunert freezer in 2025)

Portuguese bridge and foredeck:

The bow platform holds two anchors ready for deployment via the horizontal windlass. The foredeck has two hatches for the chain locker, tall rails and a built-in bench seat inset into the Portuguese bridge. There are tall stainless rails along the perimeter of the deck for safety and protection. Outboard on both sides are “docking stations” with essential controls.

- Portuguese bridge seating with Sunbrella cover
- Two dock boxes
- Maxwell HWC 2200 electric windlass with dual 3/8" chain gypsies (includes Sunbrella cover) (serviced 2022)
- Bruce 50 Kg/110 lb. anchor with 400' of 3/8" HT chain
- Delta 95 lb. plow anchor with 400' of 3/8" HT chain
- Bow shore power connections (50-amp for house and 50-amp for air conditioning)

Flybridge

From the stairs in the aft section of the pilothouse, you head up through the see-through sliding hatch. Beneath Bimini arch you have an elevated 360-degree view of the outside decks and your surroundings. When the conditions entice, this is a superb perch to operate *le Chéile* underway and when at rest in the shade of the Bimini canopy (frame and Stamoid, 2026) above. Two helm chairs face forward with the helm in reach and and see/adjust the navigation displays visible and adjustable. The fiberglass arch has a forward Bimini cover above that provides shade and rain protection.

- (2) Todd helm chairs with covers
- Furuno TZT16F
- Furuno FI70
- Cummins electronic engine display
- Ritchie magnetic compass
- Icom M Mic II VHF
- VDO Rudder angle indicator

Selene 53 Le Chéile

- Icom IC-M602 VHF with remote in pilothouse
- Maxwell windlass remote control
- Raymarine auto pilot
- Flybridge settee Sunbrella cushions (2025)
- Stamoid Bimini (2026) with enclosure
- Bimini frame (April 2026)
- Aritex 1200 lb. polished stainless steel crane with remote
- Coyote barbeque grill with two propane tanks
- (3) propane tanks for the galley
- Stainless-steel sink
- Storage cabinet
- Dometic Cool Freeze refrigerator

Boat Deck:

- Highfield Classic 340
- Cover for tender
- Tohatsu 40 HP outboard
- Viking life raft mounted in cradle (Expired certification and not considered part of the sale)
- Lifesling

Saloon:

The aft deck cockpit enters through a Dutch door into the saloon. The entry level area is great for dining and entertaining, underway or at rest. The large windows on both sides give you a great view of your surroundings. The craftsmanship that has made Selene one of the most coveted trawler brands is obvious, and as you look closer you notice details like built-in handrails. There are two Ingrid leather recliners (2020) (and a dividing locker stand) to starboard. To port a built-in settee is ready for dining at the high low, folding leaves table. Forward are glass window cabinets for display.

- Two navy, leather chairs for relaxation
- Long settee to port with storage under
- Settee recovered in March 2026 with Perennials Hi 'N Dry Style 70-228 Alabaster performance vegan leather
- Teak and holly flooring
- Rug runner
- Wood blinds
- Commissary below
- Curved starboard stairwell to owner stateroom engine room landing
- Fusion MS-UD755 Bluetooth stereo system

Selene 53 Le Chéile

- Flat screen television forward by galley
- Mounted reading lamps
- Overhead handrail
- Dutch door (dual panel) with teak veneer

Galley:

The galley has been a source of joy (and great meals) and is set up for food storage and meal preparation with many popular household appliances. The granite counters offer a large amount of surface for meal preparation. The dual basin sink is outboard. There are appropriately sized and numbers of lockers and drawers.

- Granite bar top and counter tops
- Force-10 3-burner gourmet LPG gas range / oven
- Double basin sinks
- Tall, brushed nickel pull-out faucet
- GE microwave with exhaust over range lighting
- (2) Nova Kool stainless-steel refrigerator/freezers
- Broan trash compactor
- Loch Capsule portable dishwasher
- Stained glass fixture over sink
- Waterdrop filter under sink
- Igloo portable ice maker

Pilothouse:

Being a raised pilothouse model, there is a three-step stairway aft from the entry deck. Once in the pilothouse you will appreciate five entries total: two opening side doors outboard, a curved staircase forward to the accommodations, and an interior set of steps aft that connects to the flybridge. There is a folding director chair for piloting. Behind the helm is a comfortable settee with table and a watch berth aft. The pilothouse is arranged for ease of operation and convenience of managing the ships systems.

- Teak steering wheel with 30" diameter
- Naiad stabilizers controls
- Side Power integrated bow and stern thrusters with (4) controls (pilothouse, flybridge and both docking stations on Portuguese bridge) model SP155TC
- Side Power bow and stern thruster remote on lanyard
- Glendinning wired piloting control station that can be moved to port or starboard at the bow or stern
- Furuno TZT12F
- Navigation PC with two monitors and TimeZero

Selene 53 Le Chéile

- (2) Furuno FI70
- Cummins engine view
- Francis halogen search light controller
- ACR spotlight with remote in pilothouse and on the flybridge
- Servo GX for electrical system
- Furuno WX 200 ultrasonic weather station
- Furuno DRS6ANXT/4 digital Doppler radar
- ICOM IC-M802 with SSB
- ICOM IC-M510 marine radio with paired remote
- Raymarine autopilot with remote on lanyard
- VDO rudder angle indicator
- Furuno radar
- Nobeltec radar on the arch (not operational)
- Ritchie Powerdamp magnetic compass
- Maxwell remote windlass control
- Engine room camera (not operational)
- Pre-wired for fiber and Ethernet (POE) to engine room
- Echo Pilot forward looking sounder
- Electric system galvanic isolator
- Selene safety panel with lit up profile reminder
- Courtesy flags
- Double custom teak drink holders
- Multiple built-in hand holds
- Teak and spruce sole
- In the stairway forward from the pilothouse there is an Asko clothes washer and the in hallway, a Bosch Axxis clothes dryer.

Owner Stateroom:

The owner stateroom is aft, underneath the pilothouse near the center of the vessel to make it more comfortable when sleeping underway. There is an ensuite head and you also have easy access to the engine room. This room is clean and well-appointed with multiple lockers and drawers. There are bed stands on both sides of the bed and a glass panel locker to port. In the forward port section of this area is a settee outboard with a side office desk inboard with lockers and drawers. Burl wood counter tops add to the elegance of this majestic space.

- Full beam stateroom with centerline queen berth 63" wide, 76" long with padded headboard
- Two cedar lined hanging lockers, one with glass door

Selene 53 Le Chéile

- Recessed make-up vanity
- Teak and holly flooring
- Wired for wall-mounted TV
- Reading lights
- Furuno display over nightstand for easy monitoring
- Opening port lights outboard

Convenient and private, this head and shower with counter and sink will keep you as fresh as you would expect in any waterfront home.

- Tecma fresh-water electric toilet
- Corian elongated countertop
- Glossy black tile flooring
- Cabinets and drawers
- Exhaust fan
- Shower with bi-fold door and teak grate

VIP Stateroom:

The forward stateroom, also called a VIP, features an island berth that is easy to get in and out of and make. There is storage below (including access to a separate bow thruster chamber). Opening portlights outboard and opening hatches above all provide excellent ventilation. There are numerous drawers and lockers for clothing and accessories. This is a great place to be a guest!

- Centerline queen berth 84" x 59"
- Teak and holly flooring
- (2) large hanging lockers
- (2) drawers and multiple cabinets
- Pre-wired for TV
- Reading lights
- Overhead hatch

Forward head:

The forward head is located for easy crew entry. There is a toilet, shower and sink. Great convenience with good ventilation, easy to use and clean.

- Stall shower with bi-fold door
- Tecma fresh-water electric toilet
- Corian counter tops
- Glossy black tile flooring
- Heated towel rack

Selene 53 Le Chéile

Guest stateroom and office (port):

The third stateroom is a popular layout feature on the Selene 53 model. To make this feel less like a storage room with large shelves, the original owner requested a wide single lower berth with no bunk bed above.

- Built in teak desk, drawers and bookshelves
- Teak and holly flooring
- Single berth
- Wired for wall-mounted TV
- Security safe
- Opening port light outboard

Engine room:

Below the saloon and entered through the owners' stateroom, this is the primary machinery space and the heart of *le Chéile*. There is hatch from the galley for access to drop down if the owner stateroom is occupied. All of the equipment is well laid out for maintenance, making it easier inspect the various systems and equipment.

- Cummins QSL9 404 HP - Typical fuel consumption at 8 knots, 6 gallons per hour
- Note: The engine was replaced due to a Cummins manufacturing defect (2022) (*read explanation included in this document)
- Spurs line cutter for main
- Yanmar 4JH4E wing engine
- PSS dripless shaft seals main and wing (wing – February 2026)
- Dual Racor fuel filters
- Selene fuel board for diesel management
- Northern Lights 12 kW generator with sound shield
- (2) Victron Quattro 48|5000|70 Inverter
- Reverso oil change system for both engines and genset
- (2) Cruisair reverse cycle HVAC, 72,000 BTUs
- Kabola hydronic heating system (diesel boiler)
- Model 254 Naiad active fin stabilizers, 9 sq. ft. fins
- Fireboy fire suppression – certified in May 2023

Fresh Water:

- 330-gallons (total) fresh-water in two fiberglass tanks
- Torrid 20-gallon hot water tank

Selene 53 Le Chéile

Safety:

- Life raft with hydrostatic release
- Life sling
- USCG safety gear
- Global Fix EPIRB in pilot house (expired and not considered part of the sale)

Fire Protection :

- Fireboy auto fire suppression system in engine room
- Kidde hand-held fire extinguishers

The following is a summary of major projects, current service and upgrades by current owners since 2023:

- Davit/Crane overhaul – reinforced crane base at deck, rebuilt rams, cable
- Highfield 360 Sport with Hypalon tubes with Tohatsu MFS40A 40HP
- Major house electrical system upgrade - 20kW LifePO4 Batteries, 10kW 240V split phase inverters, 6kW alternator and smart regulator, CerboGX controlled with display at the helm, DC-DC charging system for house, main engine, wing/gen. Soft start units on both A/C compressors. All Victron equipment. Run air conditioning overnight on the batteries. Run all A/C loads off the inverters. Substantially charge the battery bank while underway. Victron Orion-TR SMART 12 I 12-18), two Quattro 48/5000/70
- Internet / computer system. Internet access from Wi-Fi, Cellular, and/or Starlink. Starlink is permanently installed. Wi-Fi equipment and NavPC at the helm with latest TimeZero.
- House water pump - Headhunter / shower fixtures / exterior sink / exterior fixtures
- Added Seafrst unit in commissary. 12V system air or water cooled (replaced old Grunert freezer)
- Interior cushions in saloon / pilothouse (April 2026)
- Flybridge Stamoid Bimini and frame, (May, 2026)
- Exterior cushions on flybridge / Portuguese bridge
- Air cooled 12V compressor for built in freezer (capable of water cooling)
- Re-bedded / re-caulked all exterior windows (2026)
- Cutlass and engine mounts on Wing (2026)
- Bottom job – refresh paint
- Fresh anodes

*MAIN ENGINE HISTORY:

In May of 2022 the previous owner was cruising in Abaco and the main engine stopped running and wouldn't restart. They fired up the wing and were able to get into port. The boat was towed back to Stuart, Florida at Hinckley Yacht Services who determined the engine suffered a catastrophic failure and needed replacement. The previous owner filed a claim with their insurance provider (Chubb). The old engine was removed and replaced with a brand new QSL9. The insurance company took possession of

Selene 53 Le Chéile

the old engine and did an 'autopsy' to determine the nature of the failure to determine if they were going to pay the claim. The engine 'autopsy' revealed that the cooling channel galleries in the cylinder block of the engine had structural defects when the engine was originally manufactured. The channels that circulate the coolant in the engine block failed, resulting in coolant exfiltrating into the rest of the engine. This was deemed by the insurance company to be a 'factory defect' and NOT 'operator error' and therefore they paid the insurance claim. The damage was isolated to the old engine itself - when the failure occurred the engine 'just stopped and never started again'.

It is also worth noting some of the additional services the previous owner completed prior to our purchase of the boat (not for price/cost but rather 'what is improved'):

May 2022 - Replaced injectors in generator (service due in 2027)

August 2022 - Replaced exhaust elbow / valve adjustments / heat exchanger for gen

October 2022 - Replaced galley fridge/freezer

August 2023 - Replaced main engine cutlass bearings, propeller shaft, PSS shaft seal. Reinforced rudder shoe (as part of rudder / shaft removal). Main propeller removed / balanced / checked.

Other than the transmission (which has been operating without any issue) the main engine and shaft are fresh from 2023 and the entire drive train has been fully serviced.

Selene 53 Le Chéile

Talk Through Tour:



<https://youtu.be/PAsWpMQAZu4>

Selene 53 Le Chéile



EXCLUSIONS:

Potential purchasers should assume that items on the vessel at the time of viewing, but not specifically listed on this sheet, are not included with the sale of the yacht. These specifications are believed to be true and correct but cannot be guaranteed. Items excluded include, but are not limited to, personal items in lockers and drawers. *Owners' personal effects and clothing will be removed prior to closing.

DISCLAIMER:

Specifications and details of this vessel are provided in good faith for informational purposes only. Details regarding the specifications, operating characteristics and condition of the vessel have been obtained from sources believed reliable, but the owner and brokers cannot guarantee or warrant the accuracy of this information or the condition of the vessel. Buyer assumes responsibility to verify all speeds, capacities, consumptions and other measurements contained herein and otherwise provided and agrees to instruct his/her agent or surveyor to confirm such details prior to purchase. Vessel is offered subject to prior sale, price and inventory changes and withdrawal from market without notice.

Brokerage: JMYS is a US based (licensed and bonded yacht brokerage in California, Florida, Virginia and Washington) with an international emphasis specializing in ocean capable trawlers and recreational tugs. Our brokers are experienced boaters; most are trawler owner/operators with thousands of hours and miles at sea. The team at JMYS has extensive trawler and motor yacht product knowledge and our skills are available for coaching after the sale has concluded.

Co-Brokerage: Fellow yacht broker association members: **Le Chéile** is available for Co-Brokerage, please call to discuss special listing arrangements in place. This listing specification has been approved by the sellers for accuracy. The photos, images and descriptive content are copyrighted by JMYS and may not be copied or used without specific written permission.

Selene 53 Le Chéile

Listing broker. Mark Benno is a boat lover who is also the co-captain with his wife of a Nordhavn 55 called, *What's Next*. Their boat name is synonymous with their approach to life, always looking forward and asking, "What's Next?" He loves to be on, in, or near the water, and given a choice of any cruising grounds, would be in the British Virgin Islands.

Please contact listing broker, **Mark Benno** by phone, text or email for additional information or to schedule your personal showing. Mark is available via Mobile + 1 813.765.3754 (Call or Text). You can send a detailed email to: Mark@JMYS.com.



Licensed and Bonded in Florida.

Listing broker. Jeff Merrill, CPYB (Certified Professional Yacht Broker) has extensive product knowledge of the trawler market plus direct experience with the Selene brand and has been involved in several transactions of Selene 53s. Jeff is a familiar face to YouTube viewers and a 25-year featured presenter at Trawlerfest events across the country. He has written dozens of articles about trawlers for *Ocean Navigator* and *PassageMaker* magazines and is one of the online instructors for *Boaters University*.

Please contact listing broker, **Jeff Merrill, CPYB** by phone, text or email for additional information or to schedule your personal showing. Jeff is available via Mobile + 1 949.355.4950 (Call, WhatsApp or Text). You can send a detailed email to: Jeff@JMYS.com.



Licensed and Bonded in California, Florida, Virginia and Washington.

You Tube: Jeff Merrill Yachts | Twitter: @merrillyachts | LinkedIn: jeff.merrill

Facebook: Jeff Merrill Yacht Sales | Instagram: JMYSTrawlers

Chairman, Certification Advisory Council (CAC) for CPYB 2023, 2024 and 2025

Yacht Brokers Association of America | International Yacht Brokers Association (Florida) | Northwest Yacht Brokers Association | California Yacht Brokers Association – President 2015 and 2016

